

30M2 SOCIAL HOUSING

Academic Project 2006

How to coexist just in 30m²? This is a new concept for a country where flats used to be bigger than 70m². 30m² housing is part of a state-subsidized house program. It is thought to be for two or three people for a short period, not more than 5 years. This housing project tries to investigate how to combine design, functionality

and sensations. The main premise was to secure a sensation of wide and multifunctional space. In order to obtain the wanted results, I projected it in different planes in height, where the different activities are developed (feeding, rest, work, personal cleanliness). Using different surfaces, it seems to be more space, light arrive everywhere without walls.

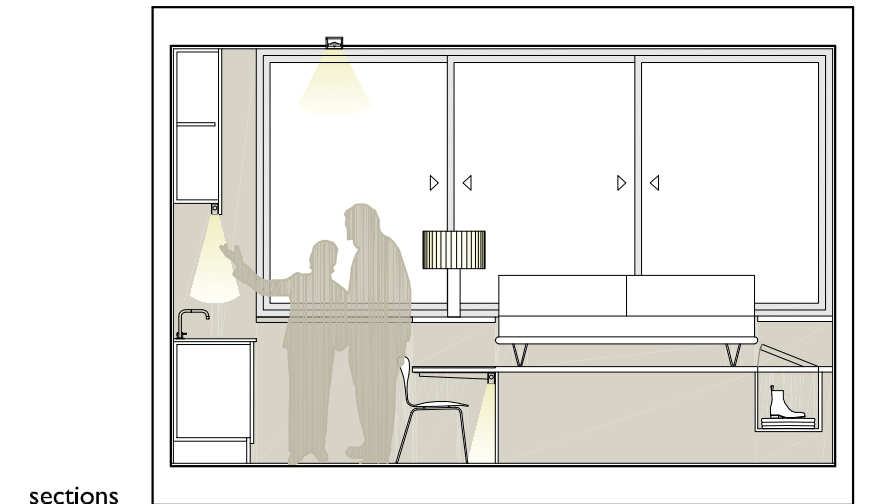
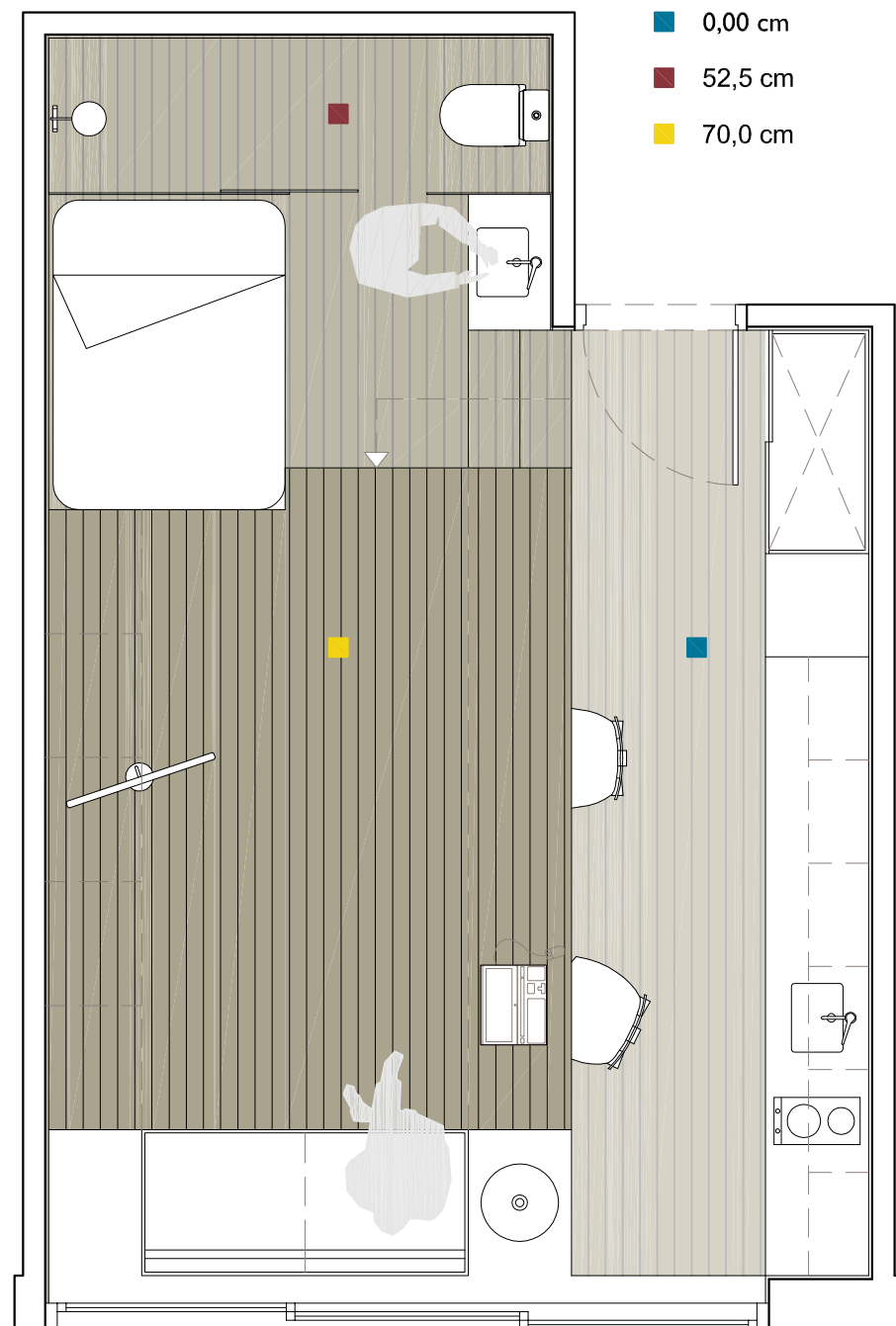

sections

