

NOTES:

UNITS - VENEERED MDF CONSTRUCTION WITH SOLID TIMBER LIPPING ON TOP OF SOFT CLOSE DOORS FOR FINGER PULLS

60MM HIGH BOXED PLINTH WITH ADJUSTABLE PLINTH FEET

WORKTOP - 6MM BLACK BACK PAINTED LOW IRON TOUGHENED GLASS

6MM X 6MM POLISHED NICKEL INLAY - 30MM IN FROM ALL EDGES

BISCUIT JOINTED LEATHER CLAD DOWNTURN ON FRONT OF WORKTOP

1 X Ø125MM HOLE CUTOUT FOR POP UP SOCKETS

BP FITTING

- 1 X POP UP 3 GANG/2 DATA

BRIGHT CHROME

- 1 X POP UP POWER FLUSH FIT

ADAPTOR BRIGHT CHROME

2 X Ø80MM HOLES CUTOUT FOR

CABLE MANAGEMENT

HAFELE 631.50.200

FLOATING SHELVES - 50MM

THICK WITH SOLID LIPPING ON

FRONT AND HOLLOW FOR

DOWNLIGHT CABLES

FIXED TO WALL WITH

CONCEALED SHELF SUPPORTS

ALUMINIUM PROFILE, ANGLED

INSTALLATION STRIP LIGHTS -

HAFELE 833.72.715

6MM ACRYLIC MODESTY

PANELS

SCRIBE TO WALL T

SHIRTING TO RETU

FACE - FIXED TO BA

6MM ACRYLIC MODESTY PANEL

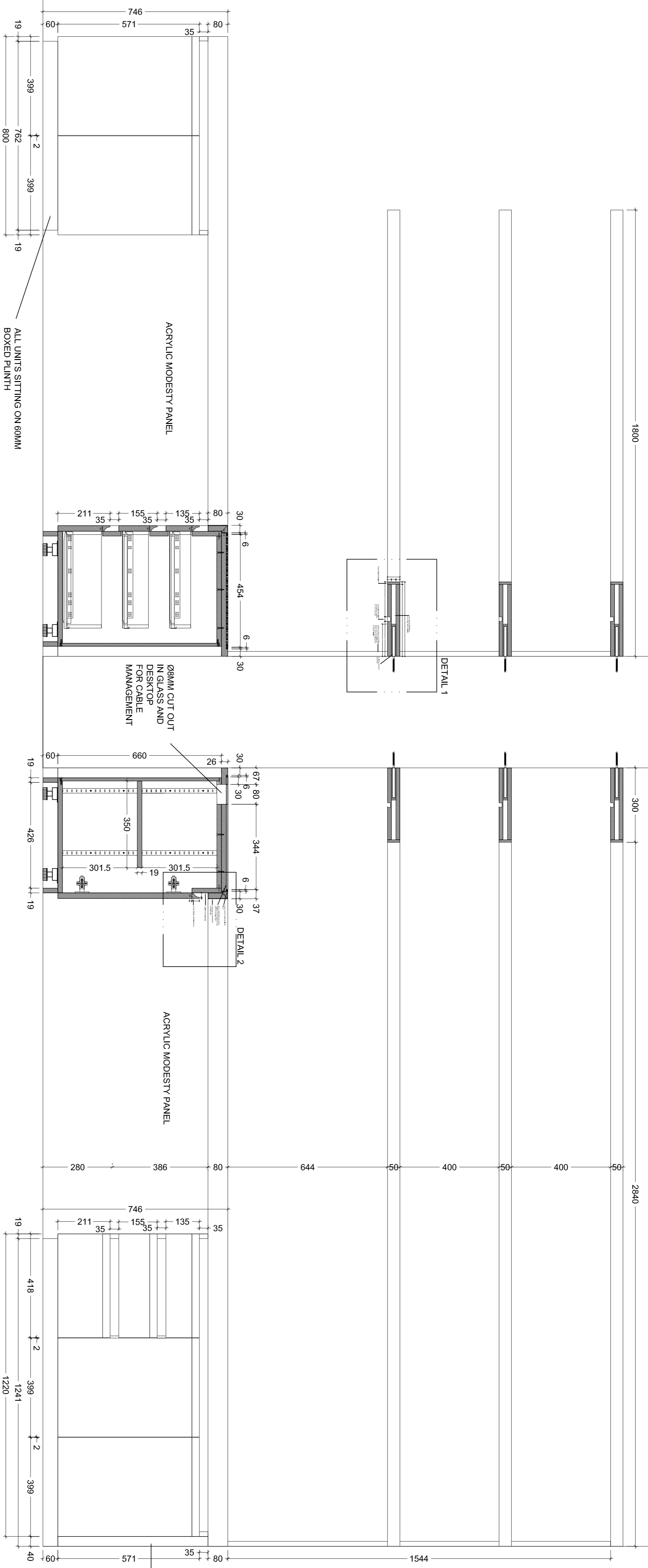

DETAIL 1

DETAIL 2

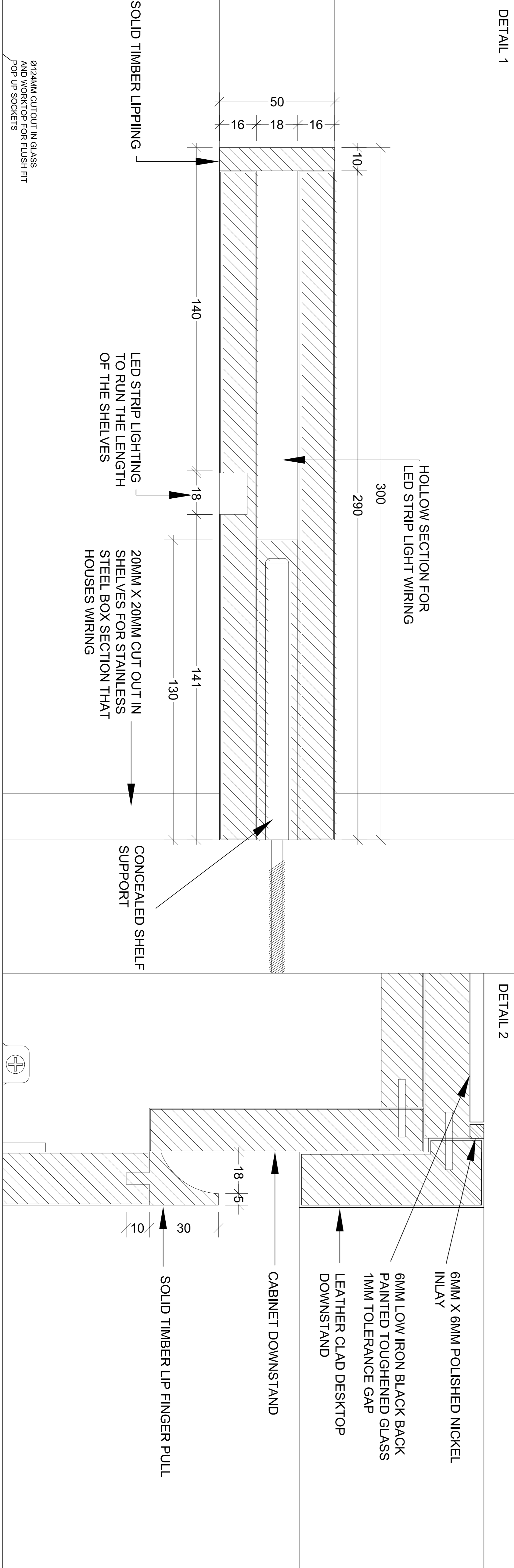

Rev	Changes	Date
01	Ø60MM CABLE MANAGEMENT HOLES	11.12.12



This drawing is the copyright property of Decorus Furniture Ltd. Do not scale. All dimensions to be checked on site.

Client

THE STUDIO

Site Address

4 ROEDEAN CRESCENT

Scale

1:10 / 1:1 AT A1

Date Drawn

04.12.2012

Drawing Status

TO BE APPROVED

Drawing Title

BESPOKE STUDY DESK

Room/ Area Ref

Job No

Drawing Number

Revision

925 BSD-925-01 01

Ø124MM CUTOUT IN GLASS AND WORKTOP FOR FLUSH FIT POP UP SOCKETS

