

PELE FLARE

Exploded View & Use Cycle

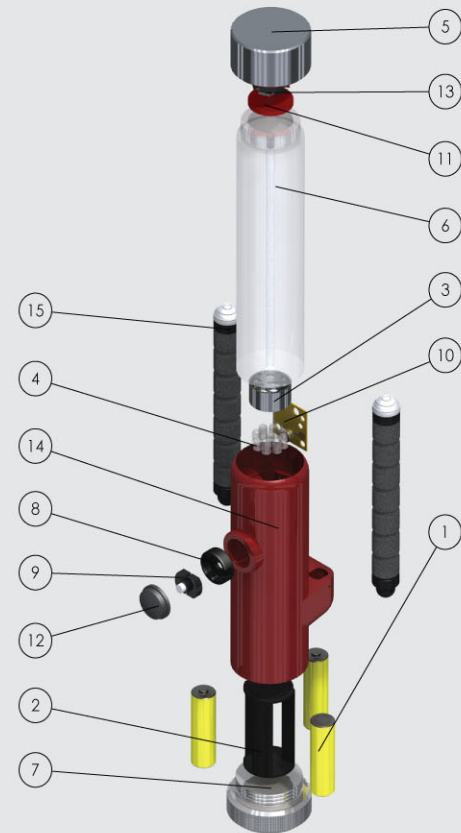

NUMBER	PART NAME	QUANTITY	MATERIAL
1	AA BATTERY	3	OUTSOURCED
2	BATTERY HOLDER	1	ABS
3	BLUE LED HOLDER	1	ABS
4	BLUE LED	9	OUTSOURCED
5	HEAT SYNC CAP	1	ALUMINUM
6	DIFFUSER	1	POLYCARBONATE
7	BASE	1	STAINLESS
8	POWER SWITCH BASE	1	RUBBER
9	POWER SWITCH	1	OUTSOURCED
10	PCB FLASH CIRCUIT	1	PCB
11	RED FILTER	1	ACRYLIC
12	BUTTON	1	RUBBER
13	HIGH POWERED LED	1	PCB
14	BODY	1	ALUMINUM
15	FLEXIBLE ARM	2	OURSOURCED



1. Bend the flares legs to the desired angles.



2. Place the flare on the ground.



3. Push the button on the flare to turn on its lights.



4. Once finished with the flare, pick it up from the ground.



5. Bend the legs back to their folded position.



6. Press the button to turn off the flares lights.



7. To replace the batteries, unscrew the metal base cap.



8. Replace the batteries by inserting 3 AA batteries into the battery holder.



9. Re-insert the battery holder into the base of the flare and screw on the metal base cap.