

01.4 CIRCULAR

EXPLOSION

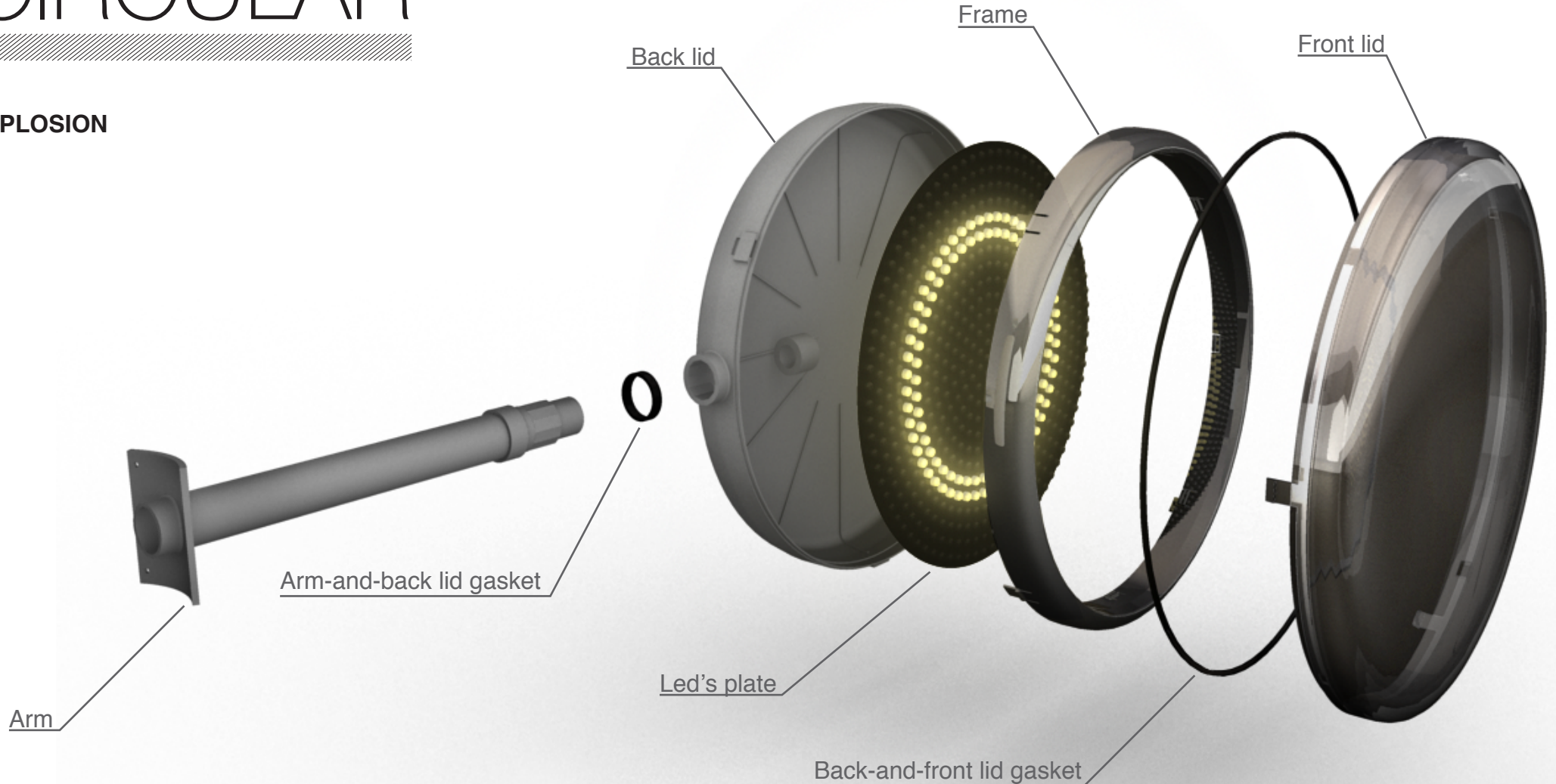

Circular is made of different parts. The **Frame**, which is made of ABS works as a holder of the leds' plate and frames it at once. Both **back and front lid** are made of polycarbonate. There are 2 ways of joining them, by ultrasounds or clipped. This project has been made with the clipped solution. In case of doing the joint between the two lids by ultrasonic welding, the surfaces which are in contact would be just flat. The later seems easier and cheaper but the clipped alternative should be developed at least as an option. Between them there is a **gasket** which avoids the water to get into. Finally the back lid is joint to the main post by an **arm**, between the also a **gasket** tries to keep everything hermetic.