

Vetor Lobo

Work Stations and greenery

São Paulo, 2005
with Fernando Cohen

Observing the client's appreciation for greenery, the design offered plenty of support for plants.



Workgroup cluster view – Large table for 6 people with a garden in the middle



Director's distribution hall – The other double height area between the 9th and 10th floor

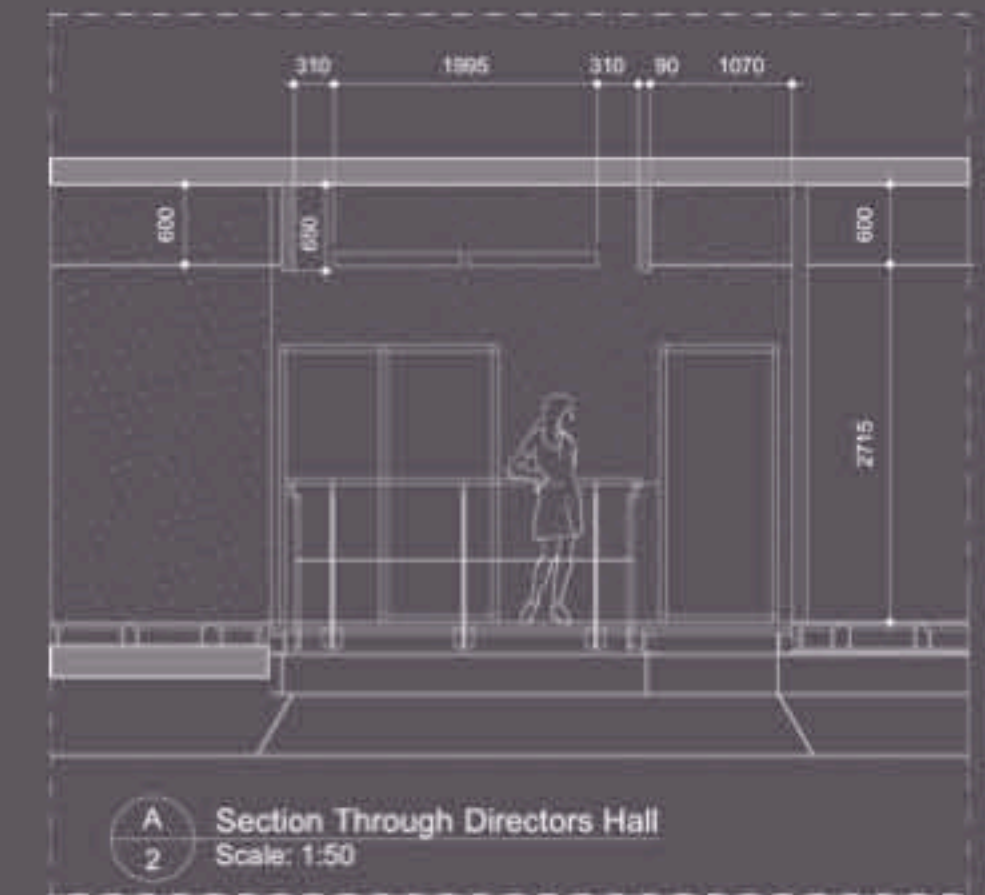
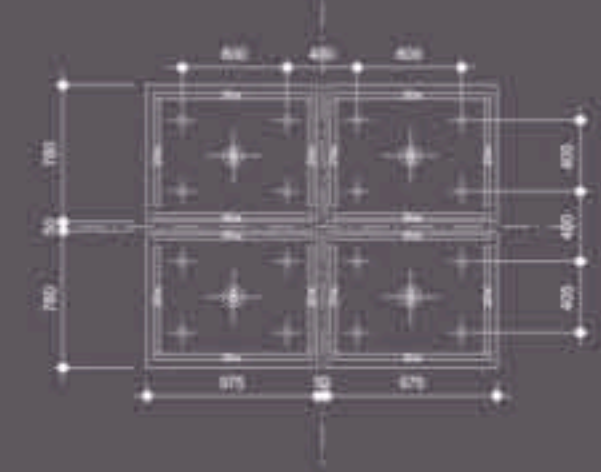

Suspended ceilings - detail and section

The employees are digital designers, heavy computer users with a lot of devices like digital tablets and specialized mice.

They also like to "populate" their workstations with all sorts of working and personal objects

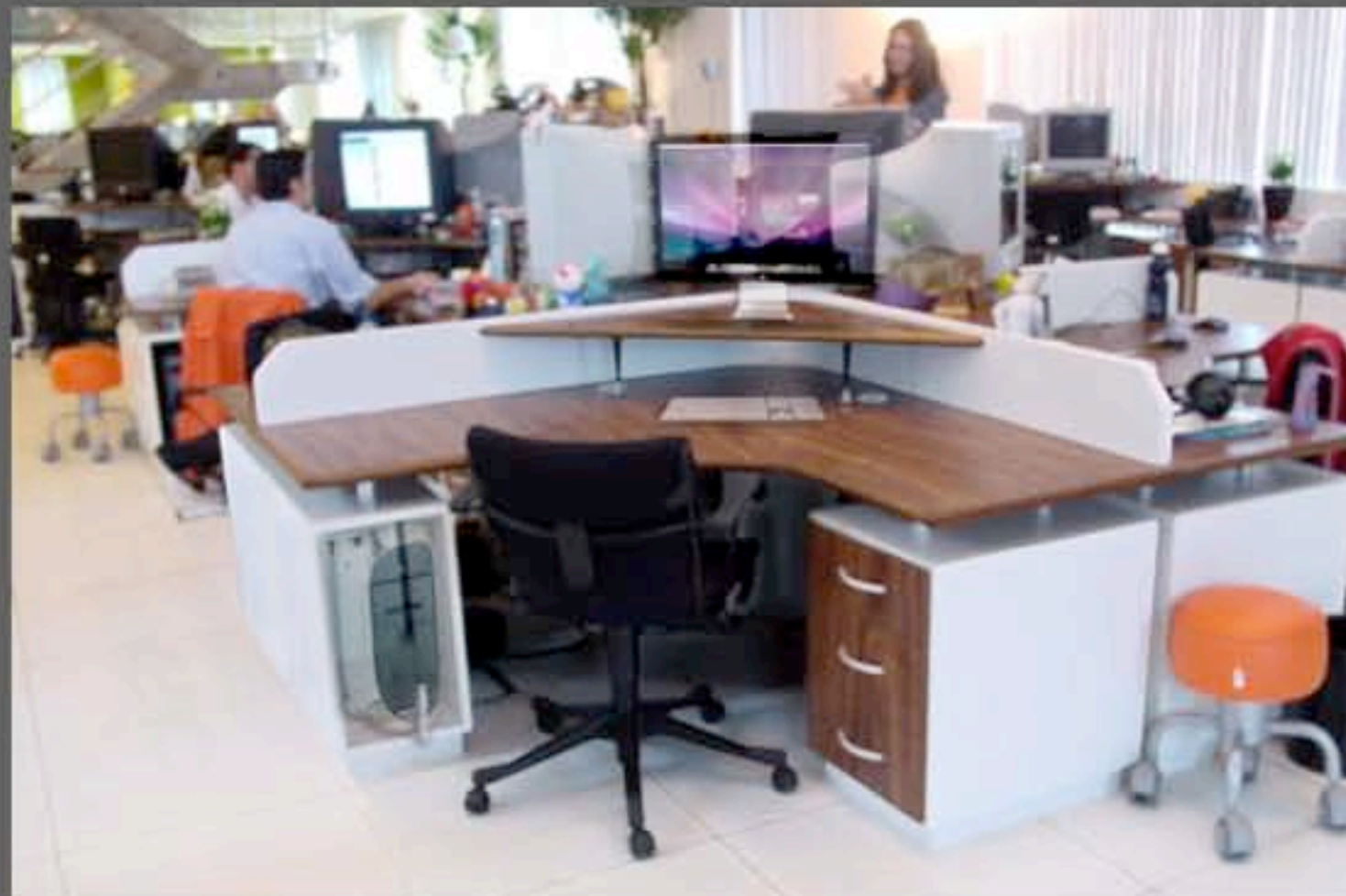

Production staff Workstation – A modular unit made with laminate MDF and low dividers to give privacy for a sitting person.

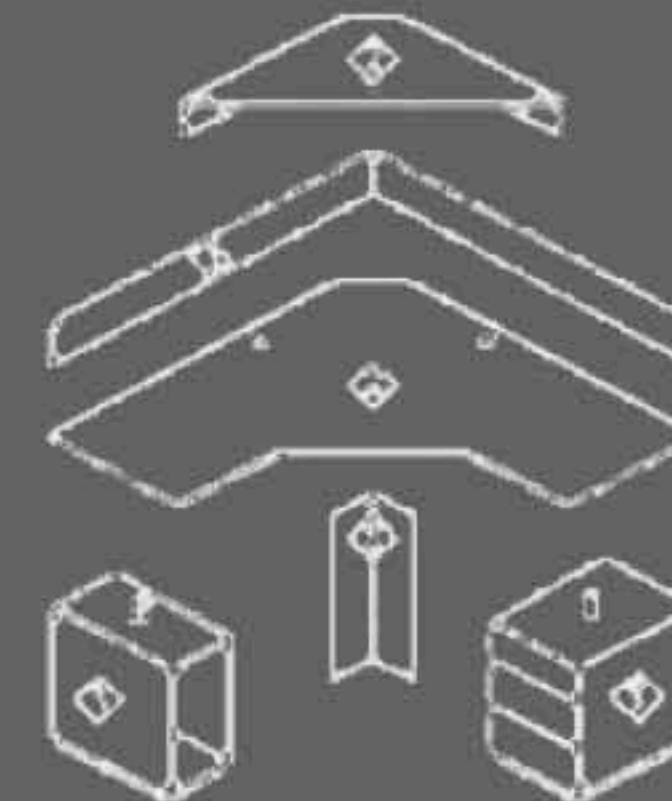

Multiview Sketch – The elevated corner has space for large and/or double monitors. Openings and channels were located for cabling and the CPU housing has large ventilation grills.

