

**LANDSCAPING SECTION**  
1:50 @ A2

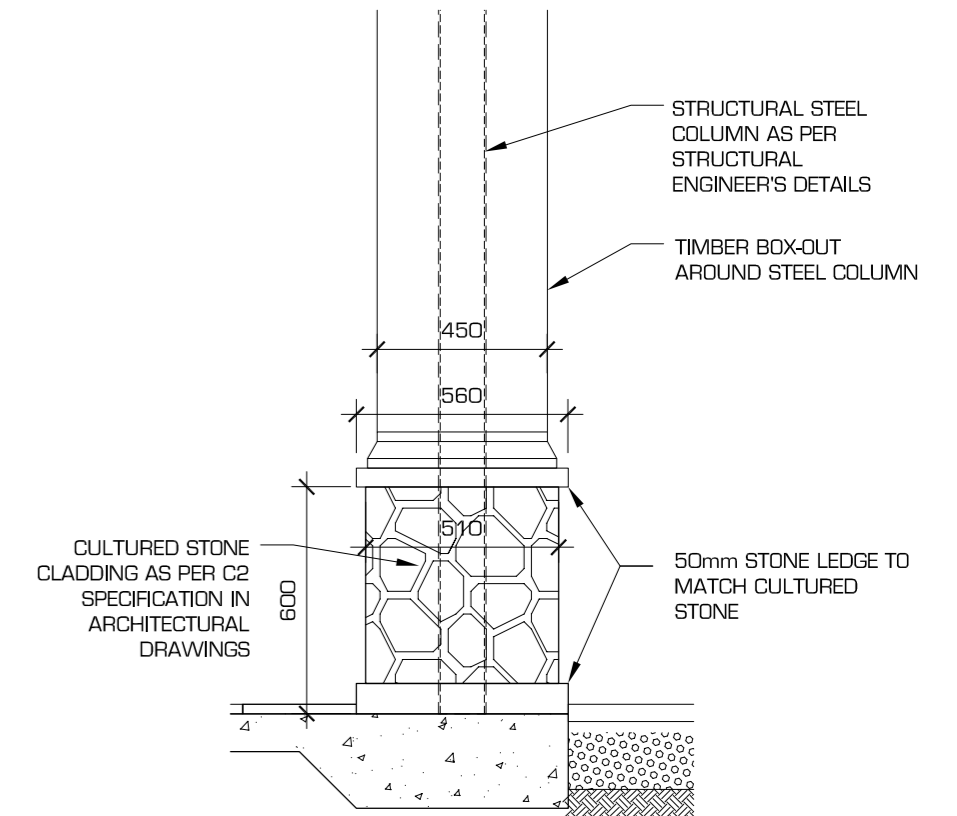

**PERGOLA COLUMN DETAIL**  
1:20 @ A2

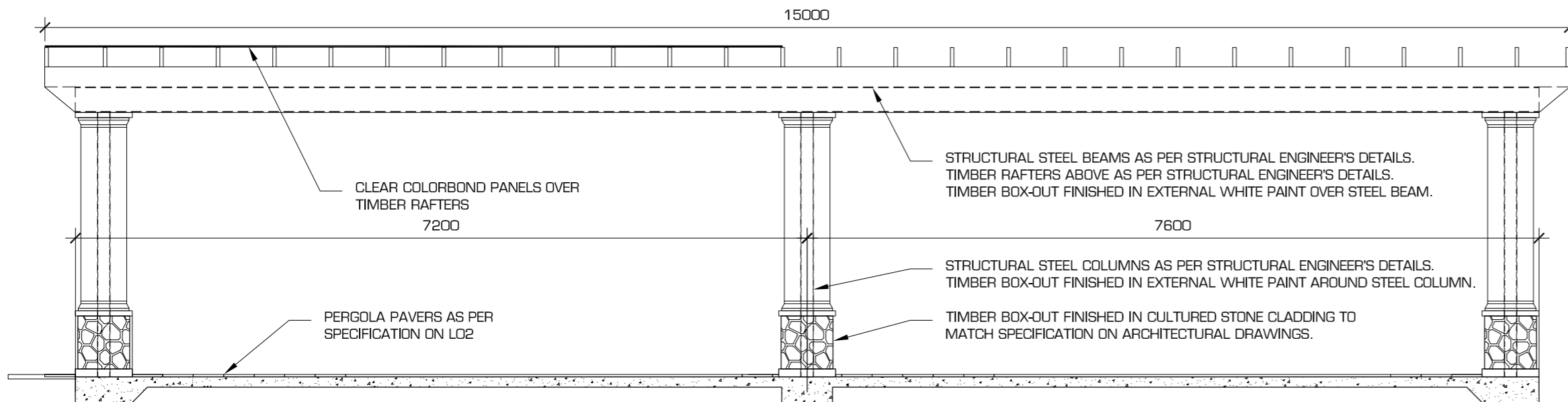

**PERGOLA LONG SECTION**  
1:50 @ A2

Timber edging finished 15mm proud of adjoining turf or pavement finished level. Timber species and treatment as per specifications. Stake as per specifications affixed to timber edging by two galvanised 75mm X 14G Coach screws.

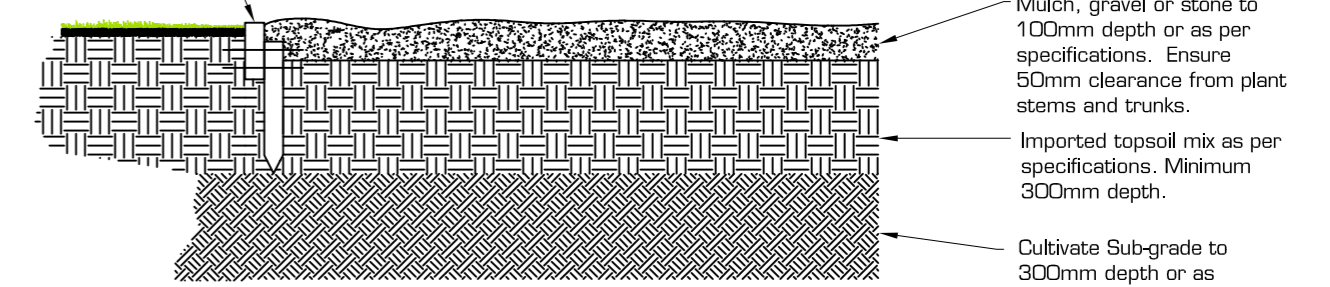

**EDGE AND MULCH DETAIL**  
N.T.S.

Trees shall be staked with two 50mm square hardwood stakes 1600mm length. Embedment depth shall be 450mm minimum. The tree shall be secured between the stakes by a 50mm hessian webbing crossing and including the tree trunk in a figure 8. The webbing shall be secured to the stakes with staples or flat-head nails below the tree foliage to avoid damage to the tree.

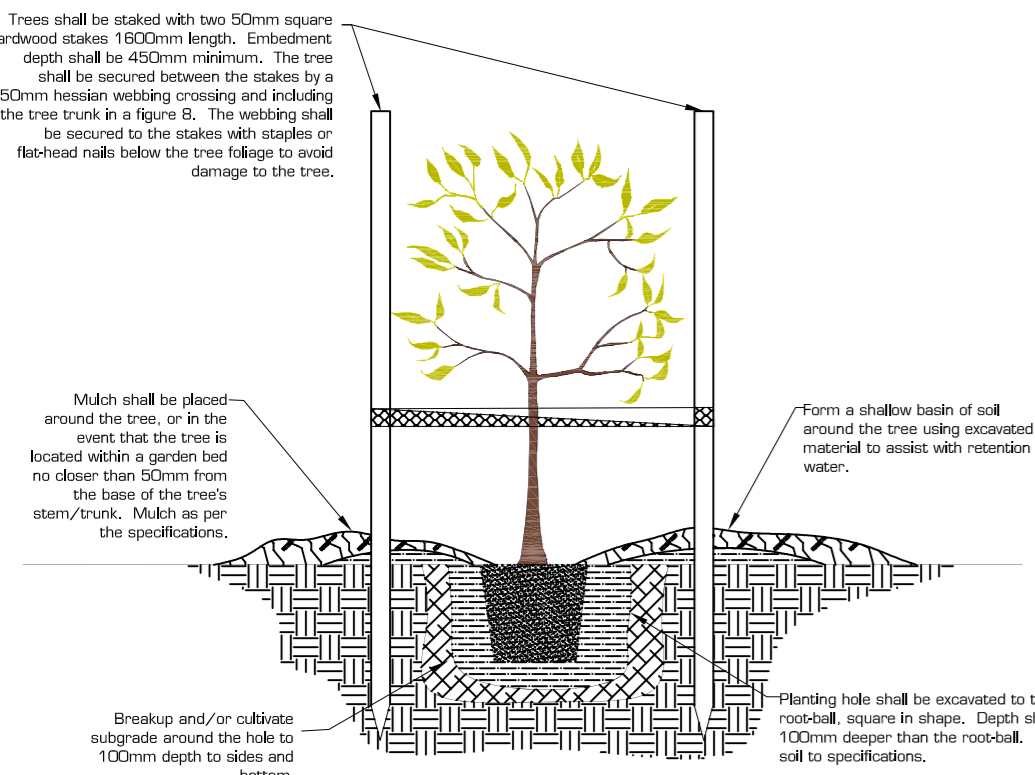

**TREE PLANTING DETAIL**  
N.T.S.

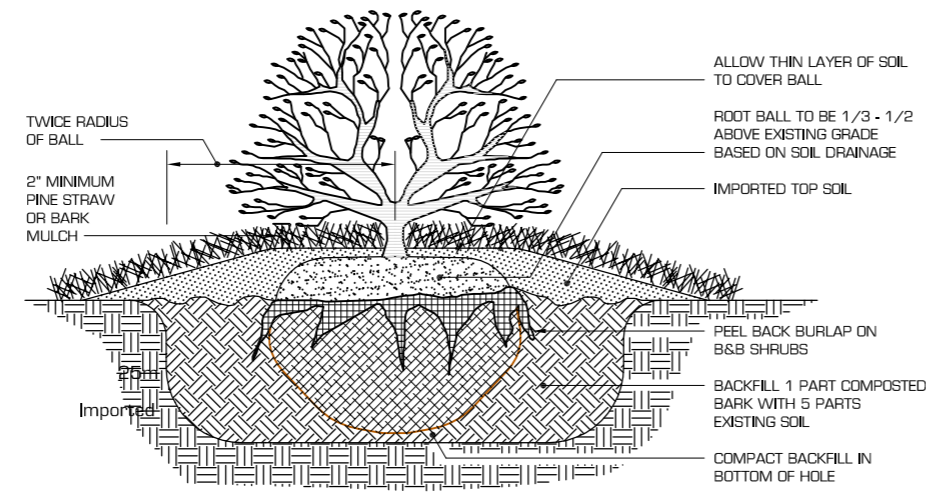

**SHRUB PLANTING DETAIL**  
N.T.S.

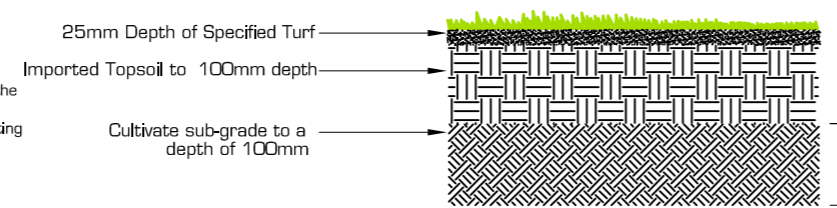

**TURF PLANTING DETAIL**  
N.T.S.

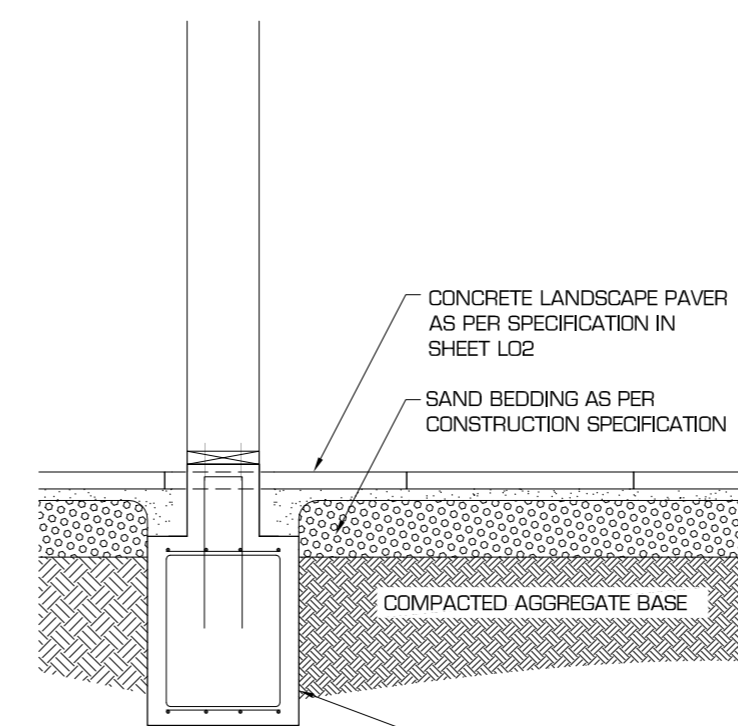

**PAVER LAYING DETAIL**  
1:20 @ A2

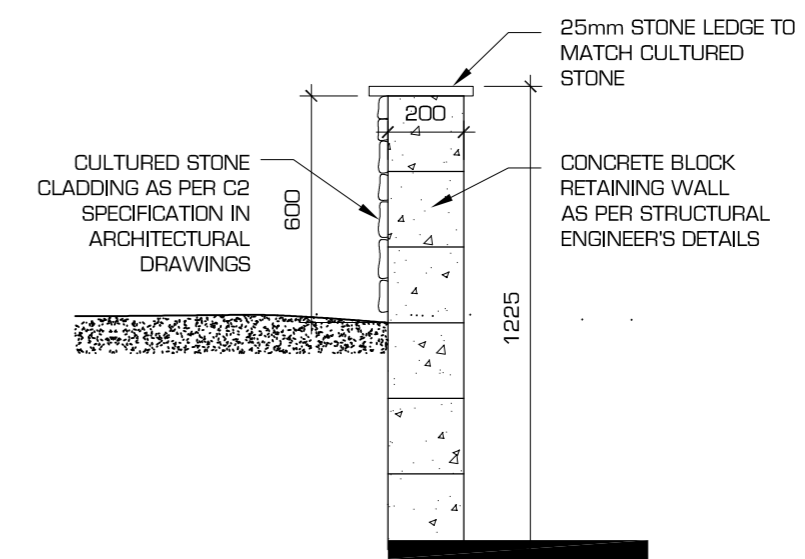

**RETAINING WALL SECTION**  
1:20 @ A2

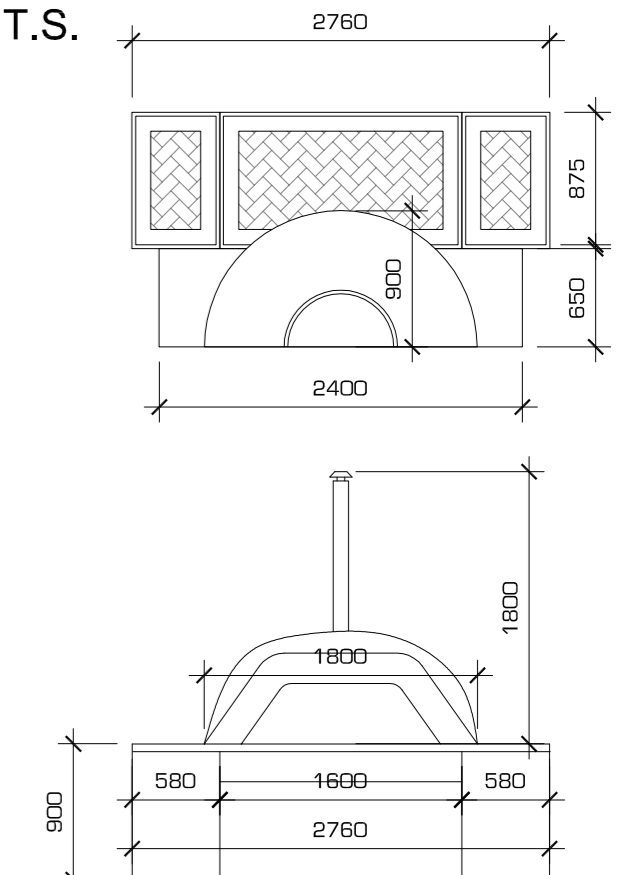

**WOOD-FIRED OVEN DESIGN**  
1:50 @ A2

DRAWINGS TO BE READ IN CONJUNCTION WITH ARCHITECTURAL PLANS, CIVIL ENGINEERING PLANS AND STRUCTURAL ENGINEER'S DETAIL

CLIENT:		BTA HOLDINGS STEVE ALLEN/CRAIG BROWN-THOMAS P.O. BOX 484 RUTHERFORD NSW 2320	
PROJECT:		MOON MOUNTAIN CELLAR DOOR 1733 BROKE ROAD, POKOLBIN LOT 21 DP 543682	
TITLE:		PLANTING AND CONSTRUCTION DETAILS	
SHEET NO:	DATE:	SHEET NO:	DATE:
3 OF 3	13 JUL 2012	3 OF 3	13 JUL 2012
DRAWING NO:	REF:	DRAWING NO:	REF:
LO3	12/036	LO3	12/036
DIR:		G:\Notes\2012\12036 - BTA Holdings - JV - CC for Moon Mountain Cellar Door\Drawings	

**LANDSCAPE**

SCALE:	N.T.S.
DATUM:	AHD
DRAWN:	JV
PROJ. MAN.:	JV
CHECKED:	AS

**HDB**  
TownPlanning & Design  
1st Floor, 44 Church Street, PO Box 40, MAITLAND NSW 2320  
P: (02) 4933 6682 F: (02) 4933 6683  
E: admin@hdb.com.au W: www.hdb.com.au  
ABN 35 078 017 508

© COPYRIGHT 2012 - HUNTER DEVELOPMENT BROKERAGE PTY LTD  
All rights reserved. Hunter Development Brokerage Pty Ltd advises that this document and all information contained therein is protected by copyright under the Australian Copyright Act 1968. Reproduction of this document in part or whole and/or use without the written permission from Hunter Development Brokerage Pty Ltd constitutes a breach of copyright. The document may only be used for the purposes for which it was commissioned and in accordance with the Terms of Engagement for the commission. Any reference to the document must include the document in its entirety and also include reference to Hunter Development Brokerage Pty Ltd.



**B**

REV.	DATE	DESCRIPTION	INITIAL
B	13 JUL 12	CC APPLICATION	JV
A	06 JUL 12	FOR CLIENT APPROVAL	JV

**PLANTING AND CONSTRUCTION DETAILS**