

# packagedesign

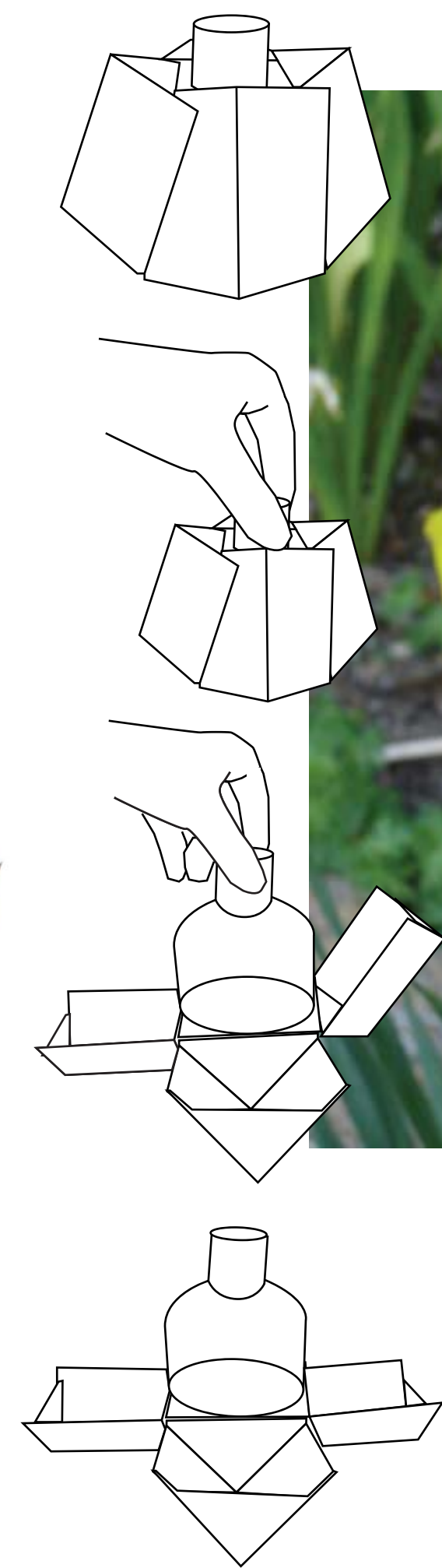

Biomimicry in Package Design  
Senior Year  
Base dimensions: 3.5 x 3.5 x 3 in.  
Chip board and Paper



**Assignment:** Use biomimicry to create a package for any item

**Spirit of the Assignment:** Use one element from the chosen organic object to abstract into the package that is appropriate for the item it protects.

**My Design:** A tulip inspired package for perfume that mimics the way the flower petals open. When the user lifts the package by perfume bottle's cap, the petals open revealing a colorful inside. The petals can then be used as storage for jewelry and other items.

