

PROJECT: **RIVERSIDE HOTEL**
FORT LAUDERDALE

620 East Las Olas Blvd.
 Ft. Lauderdale, FL 33301
 (954) 467-0671
 Fax: (954) 462-2148

INTERIOR DESIGNER:

AN	TO
DESIGNS	

Anthony Cordello
 1 Andrews Avenue
 Ft. Lauderdale, FL 33301
 (954) 220-2201

1001

INTERIOR DESIGNER:

A	N
T	O

DESIGNS

Anthony Cordaio
1 Andrews Avenue
Ft. Lauderdale, FL 33301
(954) 220-2201









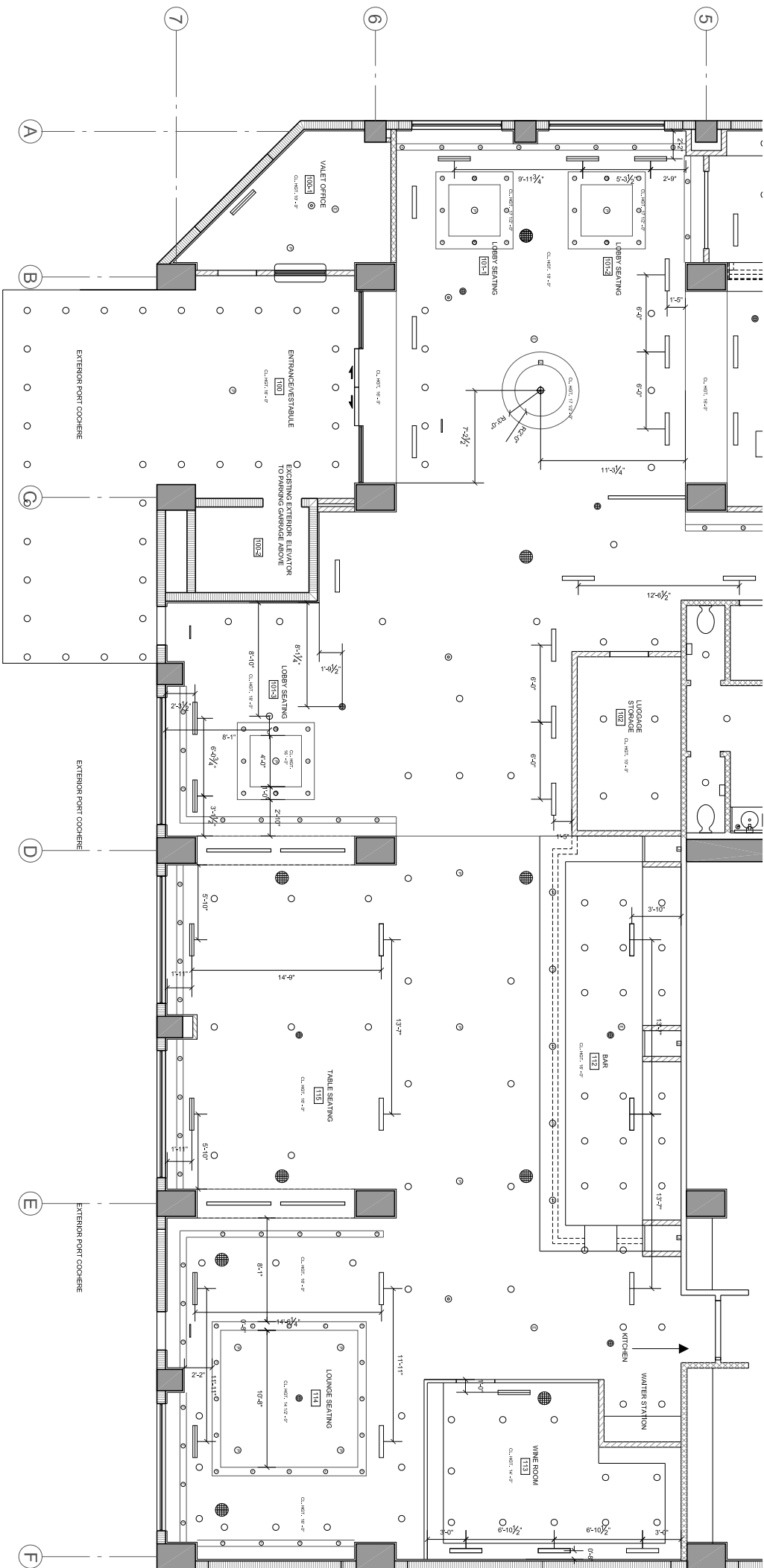

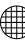
SEAL:

--	--

SHEET NO.:

D1.4B.1



SYMBOL LEGEND			
SYMBOL	DESCRIPTION	SYMBOL	DESCRIPTION
	RECESSED FIXTURE		SPEAKER
	DROP PENDANT/CHANDELIER		
	FLOURESCENT		
	EMERGENCY LIGHT		AIR VENT
	SPRINKLER		
	SECURITY CAMERA		AIR RETURN
	EXIT SIGN		AIR SUPPLY

* SEE DATA BOOK FOR ALL PRODUCT SPECIFICATIONS

- * CEILING ENCLOSED IN 3/4" FIREBLD. TYPE / C. AMERICAN GYPSUM BOARD
- * CEILING FINISH LOBBY: BENJAMIN MOORE
- * CEILING FINISH BAR/LOUNGE: BENJAMIN MOORE
- * 2 x 2 DROP CEILING POLISHED CHROME SUPPORT/ DECORATIVE TILES.
- * ALL COVE CEILINGS IN LOBBY AREAS TO BE COVERED IN WENGÉ VANEER WITH POLISHED CHROME EDGE DETAIL. (BOTH ENTRANCES, CHECK-IN, BOTH SEATING AREAS, 6 IN TOTAL)

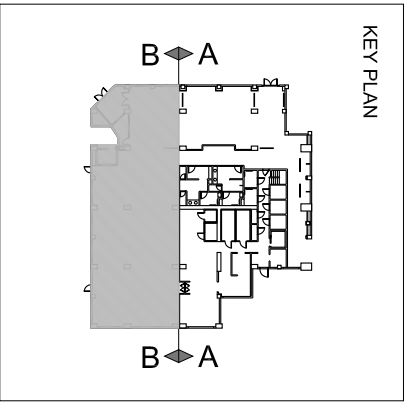

REFLECTED CEILING (B)

SCALE: 1/4" = 1'-0"

