

PAUL DAVIS
 RESTORATION & REMODELING
 2000 SOUTH 4th STREET
 MILWAUKEE, WI 53204
 Phone: 414-383-3131
 Fax: 414-383-3353
 www.pdrestoration.com

GENERAL NOTES FOR SECOND FLOOR

- 2"X12" HEADERS ON ALL EXTERIOR OPENINGS W/ 1/2" OSB BETWEEN
- 2"X10" HEADERS ON ALL INTERIOR OPENINGS W/ 1/2" OSB BETWEEN
- PELLA INSULATED WOOD W/ WHITE ALUMINUM GLAD EXTERIOR WINDOWS
- SCISSOR TRUSSES ENGINEERED BY OTHERS
- TRUSS MANUFACTURER SHALL FIELD VERIFY ALL DIMENSIONS PRIOR TO FABRICATION
- EXISTING PLUMBING LINES TO BE USED IN BATHROOM
- ALL ELECTRICAL TO MEET CODE
- 3/4" T&G OSB SUBFLOOR IN BEDROOM 1 AND OFFICE
- INTERIOR DIMENSIONS FROM FINISHED SURFACE
- CATHEDRAL CEILING THROUGHOUT SECOND FLOOR EXCEPT IN OFFICE
- ALL BREAKS IN TOP PLATE MUST BE CENTERED OVER STUD BELOW, STAGGERED 40" MINIMUM
- PROVIDE TWO JAMB STUDS PLUS ONE STANDARD STUD FOR HEADER SPANS 60" OR LESS
- TWO JAMB STUDS PLUS TWO STUDS FOR SPANS OVER 60"
- PROVIDE 2" NOMINAL WOOD FIRESTOPPING TO CUT OFF ALL CONCEALED DRAFT OPENINGS BETWEEN FLOOR AND AT ATTIC, PER LOCAL CODES.
- ALL STRUCTURAL FRAMING LUMBER FOR JOISTS, RAFTERS, BEAMS, AND HEADERS SHALL BE KILN DRIED AND MAY BE DOUGLASS FIR-LARCH #1/#2, SPRUCE - PINE - FIR #1/#2, HEM-FIR #1/#2, OR SOUTHERN PINE #2 AS FOLLOWS:
- A. DOUGLASS FIR-LARCH
 SINGLE MEMBER USE Fb = 825 PSI, E = 1,600,000 PSI
 REPETITIVE MEMBER USE Fb = 950 PSI, E = 1,600,000 PSI
- B. SPRUCE - PINE - FIR
 SINGLE MEMBER USE Fb = 875 PSI, E = 1,400,000 PSI
 REPETITIVE MEMBER USE Fb = 1005 PSI, E = 1,400,000 PSI
- C. HEM - FIR
 SINGLE MEMBER USE Fb = 1000 PSI, E = 1,600,000 PSI
 REPETITIVE MEMBER USE Fb = 1150 PSI, E = 1,600,000 PSI
- D. SOUTHERN PINE
 SINGLE MEMBER USE Fb = 975 PSI, E = 1,600,000 PSI
 REPETITIVE MEMBER USE Fb = 1120 PSI, E = 1,600,000 PSI

INTERIOR TREATMENTS FOR SECOND FLOOR

- PAINTED WOOD TRIM AND CROWN
- 7" INTERIOR DOORS 6 PANEL PINE
- COMPLETE INTERIOR & EXTERIOR PAINTING AND STAINING
- TILE FLOOR IN BATHROOM
- HARDWOOD FLOORS THROUGHOUT EXCEPT BATHROOM

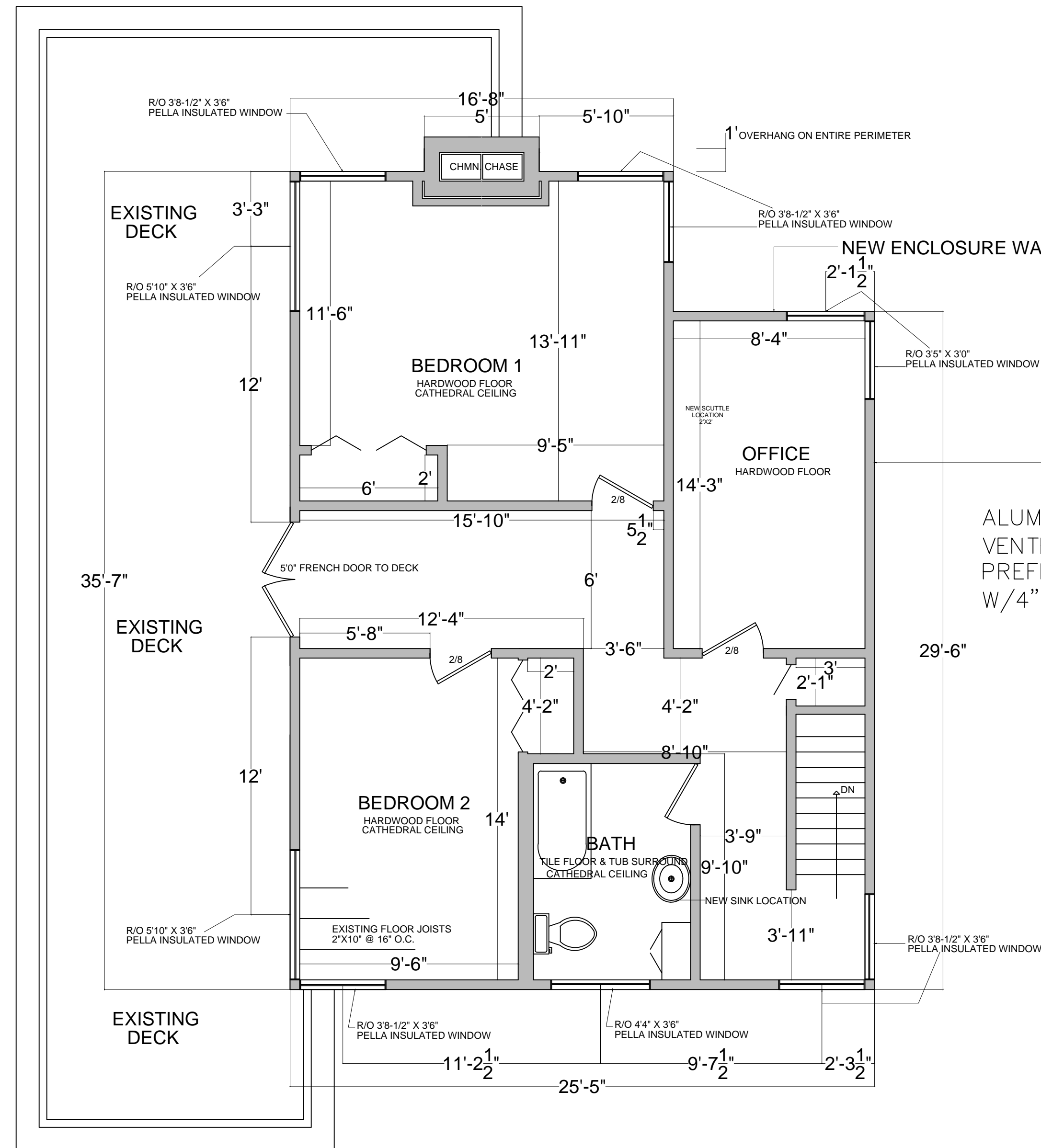

SECOND FLOOR PLAN
 1/4"=1'

DIMENSIONAL ASPHALT SHINGLES ON 15 LB ROOF FELT ON 15/32" OSB W/ H-CLIPS ON ENGINEERED ROOF SCISSOR TRUSS 24"O.C. WITH HURRICANE TIES PER CODE

ALUMINUM WRAPPED SOFFIT & FACIA VENTED 8'0" O.C. 2"x6" SUB FASCIA PREFINISHED ALUM. GUTTERS W/4" DOWNSPOUTS

CEMENTBOARD SIDING W/ BUILDING WRAP ON 1"FOAM ON 2x4 STUD WALLS 16"O.C. R-13 BATT INSULATION W/ POLY VAPOR BARRIER W/ 1/2" DRYWALL

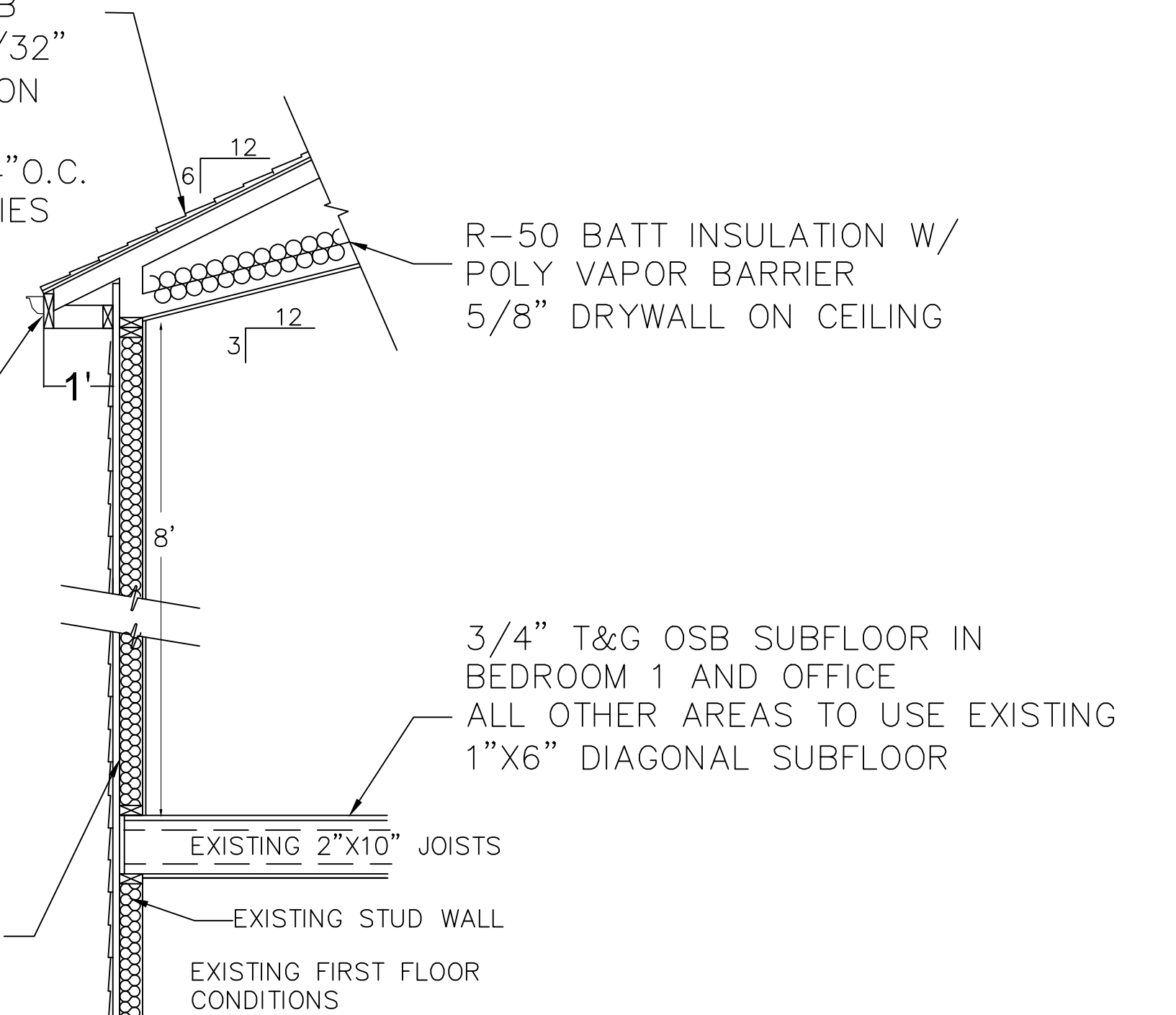

TYP. WALL SECTION

1/2"=1'

1414 E DEAN RD FOX POINT, WI	PROJECT MCGINTY
	1/4"=1'
SECOND FLOOR WITH REFLECTED ROOF LINES	DATE 1/7/10
WALL SECTION	A4