

## senior capstone:

# HUB-BUB gallery and performance hall

The building is a retrofitted textile machinery building built in the 1920's. The concept for the design is inspired by Robert Rauschenburg's idea to: *“work in the gap between art and life.”*

As a forum for progressive art, music, performance, and ideas, the space pushes the idea of what art is and what it can be. Relative to the Assemblage and Pop Art movement of the late 1950's and 1960's and Andy Warhol's famed "factory," this progressive platform should view art in different planes and redefine traditional ideas of how art is created, presented, and embraced.

## FIRST FLOOR PLAN...

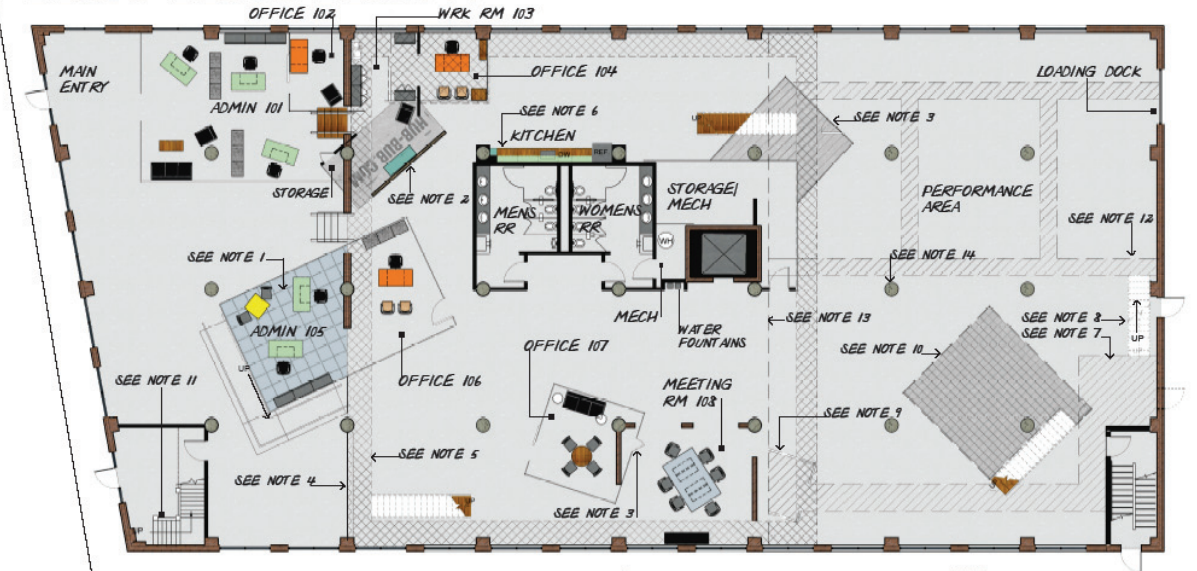

### DESIGN NOTES:

1. RAISED ACCESS FLOORING WITH 2'X2' PLEXIGLASS TILES (2'4" ELEVATION)
2. FLOOR TO CEILING WALL MADE FROM SALVAGED WOODEN PALLETS (SEE VIEW 2)
3. GLASS ACCESS DOOR
4. 2'4" FLOOR HEIGHT INCREASE
5. EXPANDED STEEL CATWALK 8'8" AFF (CABLE-SUSPENDED FROM EXPOSED CONCRETE CHILLING)
6. MDF CABEWK WITH SALVAGED LOCKER DOORS AND SEALED SALVAGED WOOD COUNTERTOP
7. A.I.R. PRIVATE EXPANDED STEEL CATWALK 17'2" AFF
8. GATED STAIRS FOR RIG CATWALK ACCESS (EMPLOYEES ONLY)
9. CHAIN LINK FENCING SURROUNDING A.I.R. SECONDARY ENTRANCE (17'2" AFF TO CEILING)
10. EXPANDED STEEL PERFORMANCE PLATFORM 8'8" AFF (SUPPORTED BY SALVAGED STRUCTURAL BEAMS)
11. STAIRWELL TO THE MEZZANINE AND SECOND FLOOR (A.I.R. MAIN ENTRY)
12. EXPANDED STEEL-RIG CATWALK (USED FOR INSTALLATIONS, LIGHTING, AND PERFORMANCES)
13. CHANGE IN CEILING HEIGHT: 16'8" EXPOSED CONCRETE CEILINGS TO THE LEFT OF DASHED LINE, 31'5-1/4"
14. COLUMNS IN THE PERFORMANCE AREA (31'5-1/4" CEILINGS) RESTRUCTURED TO SUPPORT LOAD UPON STRUCTURAL ENGINEER'S APPROVAL