

WALL LEGEND		SEE STRUCTURAL SHEET NO. 4 FOR FURTHER INFORMATION
	INTERIOR WALLS: 5/8\" GYP. BD. AT EACH SIDE OF 2x4 WOOD STUDS AT 16\" O. C.	UL300 1 hr. FIRE-RATED WALL: (1) LAYER OF 5/8\" TYPE 'X' FIRE-RATED GYP. BD. AT EACH SIDE OF 2x4 WOOD STUDS AT 16\" O. C. EXTENDED TO THE UNDERSIDE OF WOOD ROOF / FLOOR TRUSSES.
	EXTERIOR WALLS: 5/8\" GYP. BOARD ON 2x6 WOOD STUDS AT 16\" O. C. ON 1/2\" EXT. GRADE PLTWOOD WITH VAPOR BARRIER AND VENEER 5/8\" TYP. SEE ELEVATION FOR MORE INFO.	INTERIOR WALLS: 5/8\" GYP. BD. AT EACH SIDE OF 2x4 WOOD STUDS AT 16\" O. C.
	EXISTING WALLS: EXISTING WALL CONSTRUCTION TO REMAIN. SISTER NEW 2x4 WOOD STUDS AT 16\" O. C. TO EXISTING STUDS. REMOVE ANY ELECTRICAL WIRING OR OTHER CONSTRUCTION MATERIALS AS REQUIRED. NEW 5/8\" GYP. BOARD - INTERIOR	EXTERIOR WALLS: 5/8\" GYP. BOARD ON 2x4 WOOD STUDS AT 16\" O. C. ON 1/2\" EXT. GRADE PLTWOOD WITH VAPOR BARRIER AND VENEER SYSTEM. SEE ELEVATION FOR MORE INFO.
	EXISTING WALLS: EXISTING WALL CONSTRUCTION TO REMAIN. SISTER NEW 2x4 WOOD STUDS AT 16\" O. C. TO EXISTING STUDS. REMOVE ANY ELECTRICAL WIRING OR OTHER CONSTRUCTION MATERIALS AS REQUIRED. NEW 5/8\" GYP. BOARD - INTERIOR	EXISTING WALLS: EXISTING WALL CONSTRUCTION TO REMAIN. SISTER NEW 2x4 WOOD STUDS AT 16\" O. C. TO EXISTING STUDS. REMOVE ANY ELECTRICAL WIRING OR OTHER CONSTRUCTION MATERIALS AS REQUIRED. NEW 5/8\" GYP. BOARD - INTERIOR

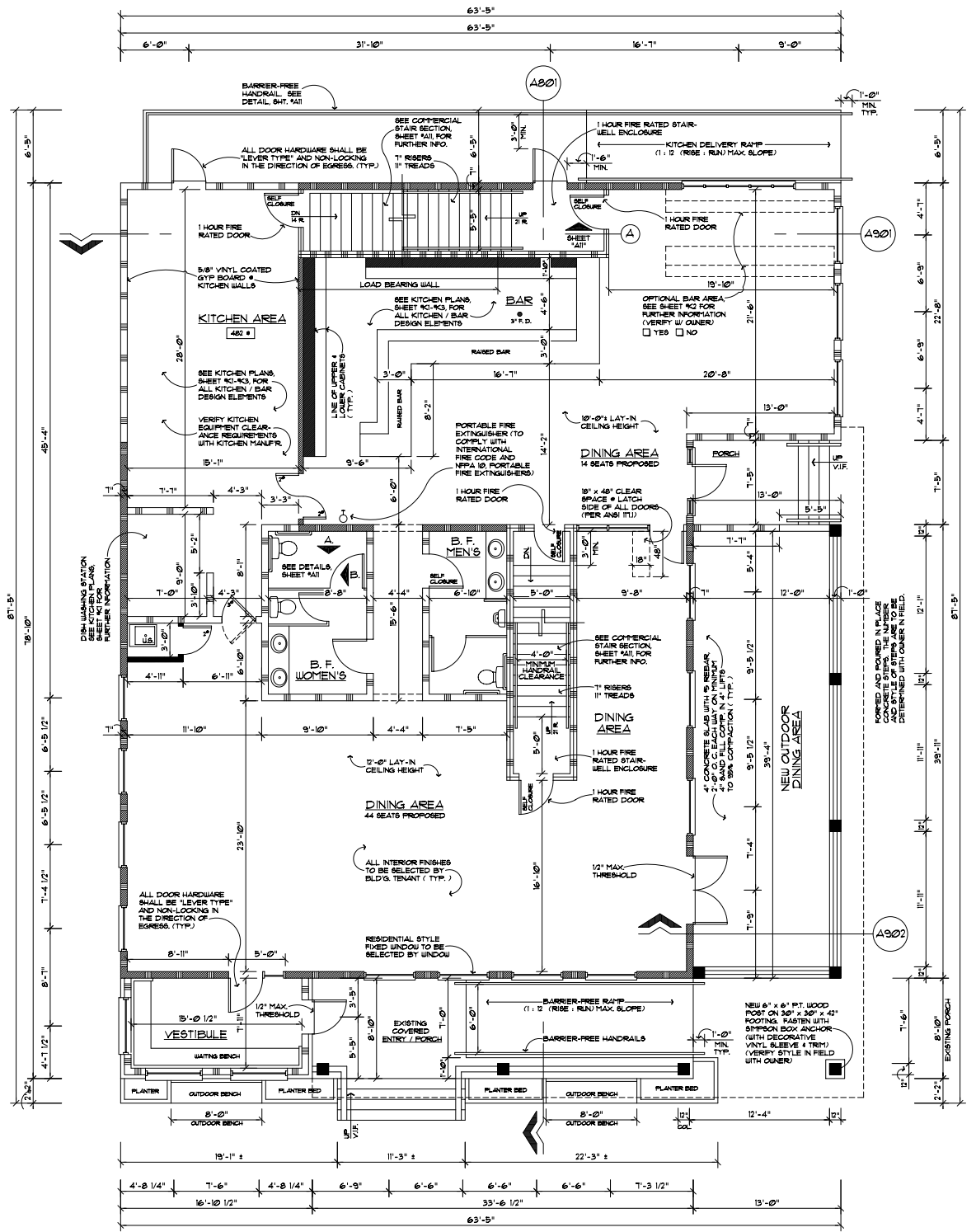

DESCRIPTIONAL / DIMENSIONAL FIRST FLOOR PLAN
SCALE: 3/16" = 1'-0"

FIRST FLOOR SQUARE FOOTAGE =	3,973 #
SECOND FLOOR SQUARE FOOTAGE =	1,846 #
TOTAL SQUARE FOOTAGE =	5,819 #

COMMERCIAL