

5) Fold up Topper piece as shown by bending the straight side flaps in toward the center. Bend the side flaps (F & G) in towards the center and rotate the top flaps down to lock together.

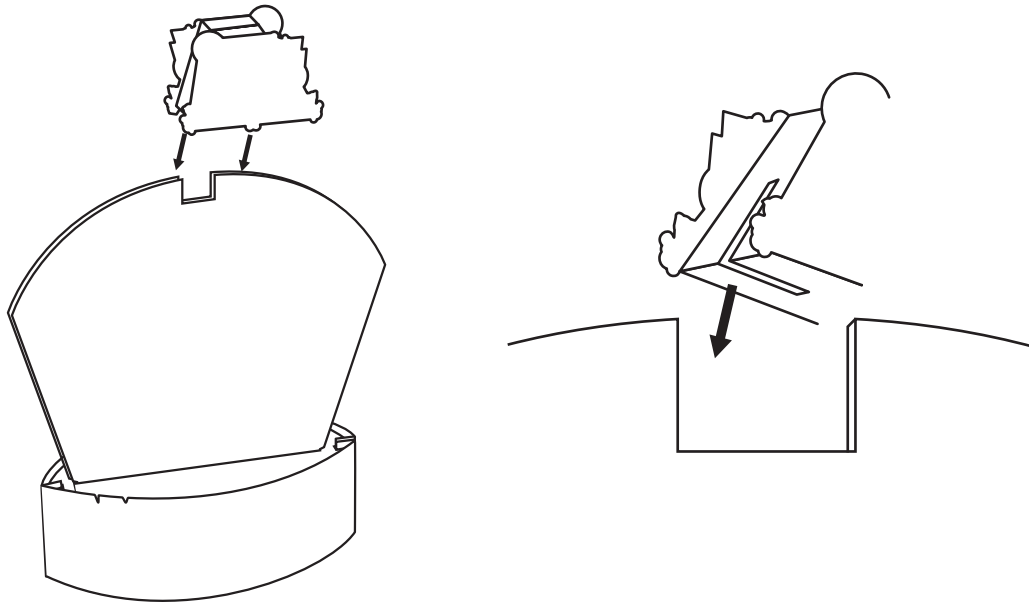

6) Attach Topper piece as shown by sliding the slots in the bottom over the edges of the cut-out on the top of the Main Panel Assembly.

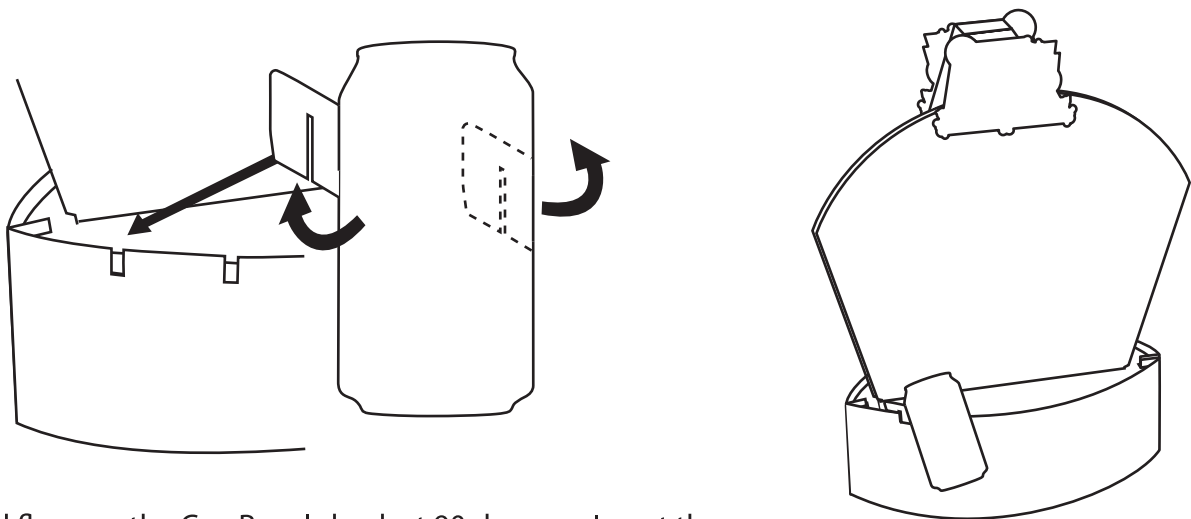

7) Bend flaps on the Can Panels back at 90 degrees. Insert the slots on the flaps into the slots on the Base Wrap. Repeat for second side of display.

**Complete Display**