

# 7 Re-Design

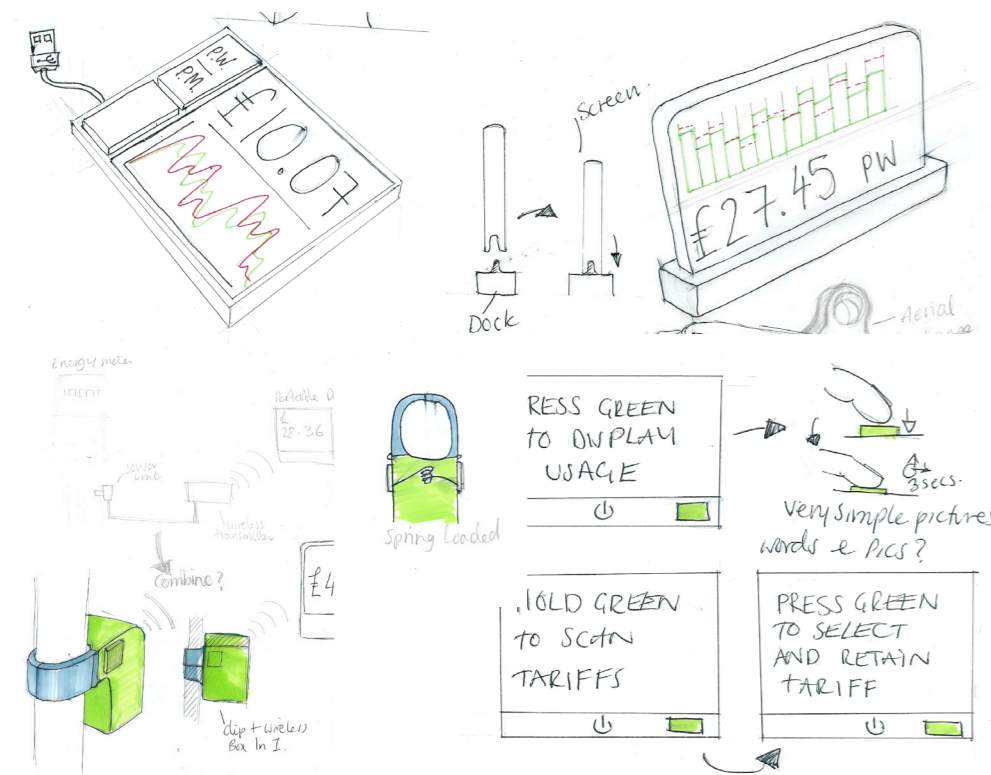

Initial sketches showing various ways to retain simplicity, reduce the components and maintain portability of the product. Appendix E

## Combining the clip and transmitter Issues 1&3



By combining the parts shown, we can simplify the user process of installing the clip.

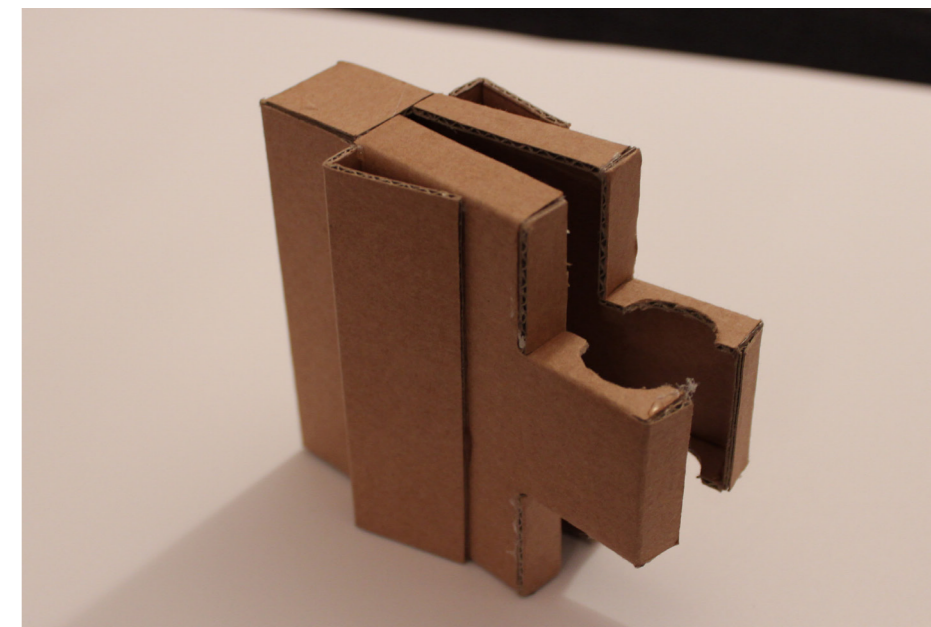
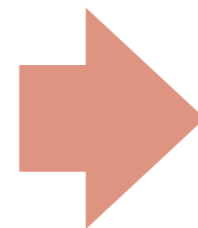

This revised design has levers to aid control, a thin clip for increased safety and combines all the components shown on the left for a simpler installation

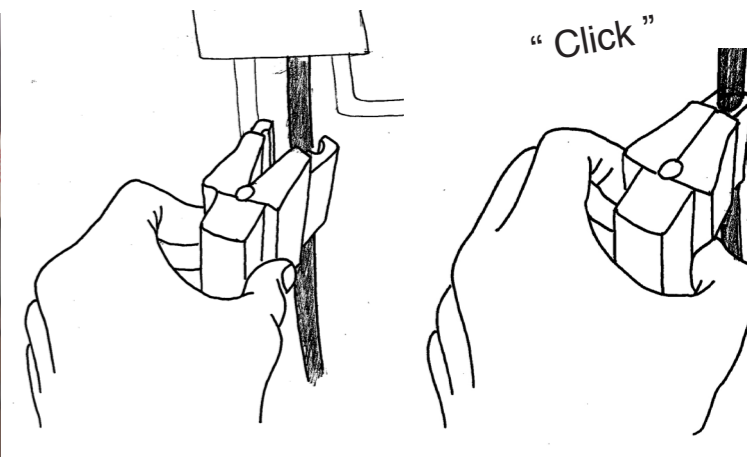

One of the main issues with the existing system was the **fear of live electric wires** experienced by some users. In an attempt to reduce this fear, the product was designed to have a **thin profile** allowing it to **fit between cables** in the cupboard. The user can then come at the cable **from the front** every time, keeping hands away from behind the cables.

Through various iterations and testing with original users [6] of the product, the design has changed dramatically. The addition of **levers to aids control of the open/close** mechanism which is **spring loaded** like a hair clasp to have a pincer like operation. The clip is designed to make a clicking sound and light up green as the circuit is complete, to notify the user they have successfully closed around the wire and are ready for operation.

Full design process in Appendix D