

# Instructions

5

Before you begin...

Please have:

A recent energy bill

6

Attach the electricity sensor clip to the live electrical main

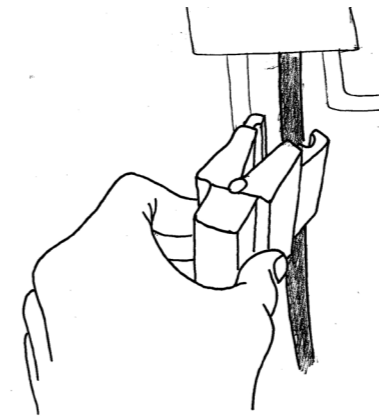

Press sides to open and clip around cable.  
Live usually identified by brown or red label.

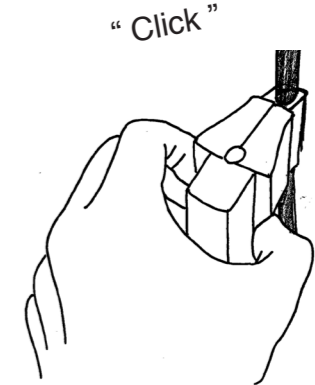

Clip will click when closed around cable.  
Light on clip will only light green when clip is enclosed around live cable

7

Put the batteries in the device and switch on

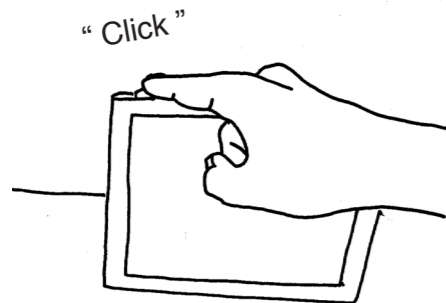

Press the on/off switch on the top off the device to turn it on.  
Button will click to let you know it's on

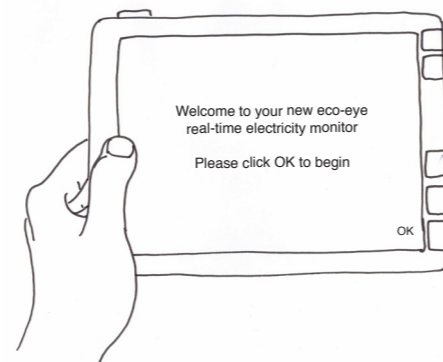

You are presented with a welcome page  
Press OK to confirm you are ready to set up

8

Now, read your personal energy tariff from your bill

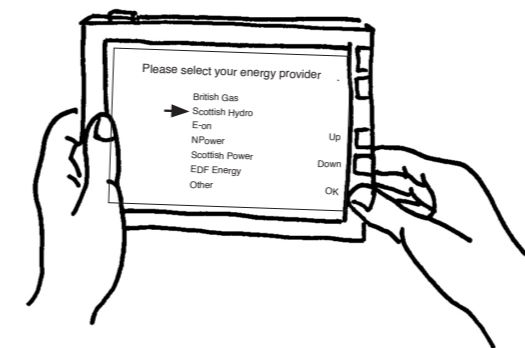

Use buttons on the right to select your energy provider and follow on screen instructions.  
Top 6 are listed, if you're provider is not listed, your device will approximate your tariff discount

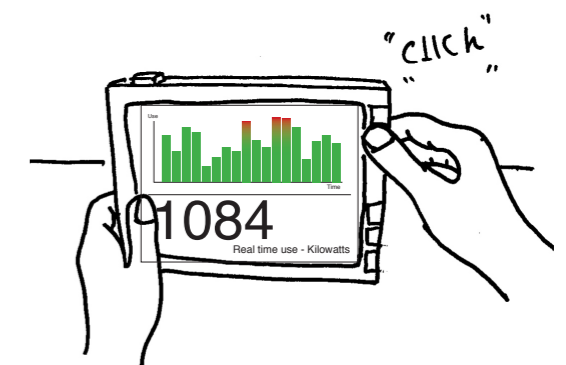

Please input necessary data before using the buttons down the side to select which display suits you best.  
This can be changed at any time using these buttons.