

# Swing Check Valves

Available with 3 field adjustable closure options.

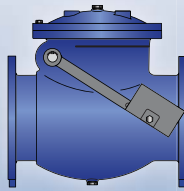

Lever & Weight

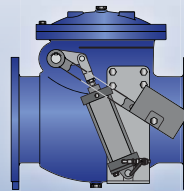

Air Cushion

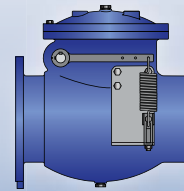

Lever & Spring

- Available in sizes 2" - 48"
- Energy Efficient 100% Flow Area
- Fusion Bonded Epoxy Standard
- Ductile Iron Construction for 250 PSI service
- Full Domed Access Cover with Vent Port



**VALMATIC**<sup>®</sup>

905 Riverside Dr., Elmhurst, IL 60126 • 630-941-7600 • [www.valmatic.com](http://www.valmatic.com)