

Scale: 1/4"=1'

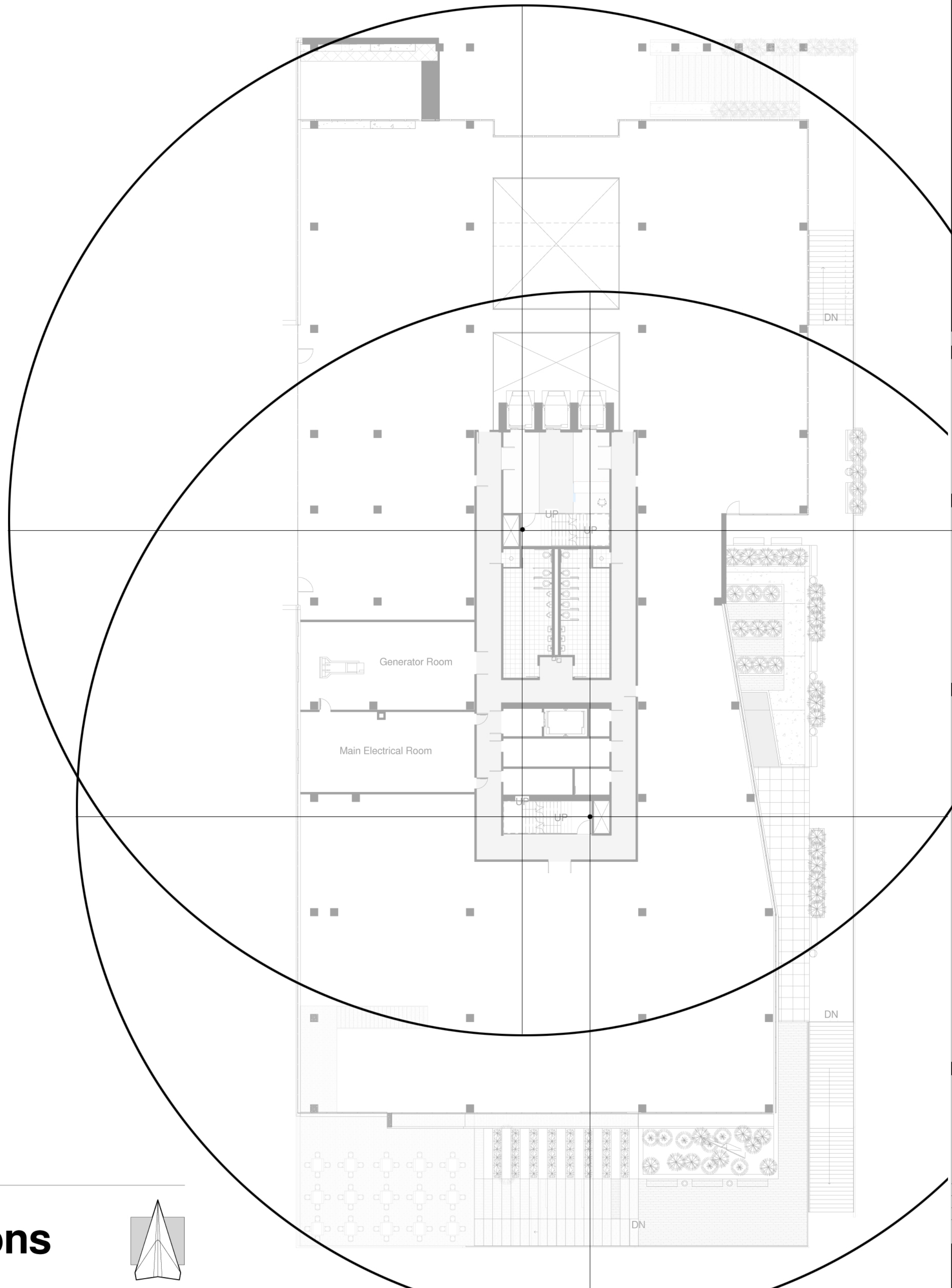

Stair Plan

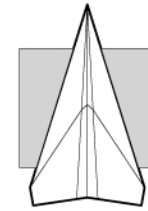

Scale: 1/20"=1'

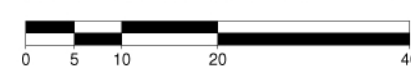

Standpipe Locations

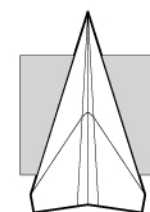

CLARKESPOSITO
ARCHITECTURE

Consultants

- Structural Engineer
Hollee Becker
- Mechanical Engineer
Matthew Setzekorn
- Electrical Engineer
Jim Stadelman
- Aeronautic Specialist
David Aston

Contract Information

Forest City
Washington
1615 L Street NW,
Suite 400
Washington, DC
20036

Phone: 202-406-6600
www.dcwashington.com

Kent State University
College of
Architecture &
Environmental Design

Client



Key Plan

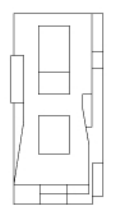

Date: 4/11/2011
Drwn by: Travis Clarke
Chkd by: Harker
Sheet Title:
Standpipe Locations