

Security

The elevator lobby doors require tenant keycards to access office space. A security desk is located at every prime tenant floor. Upon arrival, a guest checks in with the security desk. The officer then calls an escort for that guest. Before the escort can walk the guest to the appointed area, all computer monitors must be turned off or away from the guest to ensure complete security.

Elevator Lobby

Prime and spec tenants share the same elevator lobby. Each elevator has access to every floor. To allow tenants to more quickly access their desired levels, the floor and elevators are divided into three strips. Two strips give priority to prime tenant floors. These two strips are color coded for Boeing personnel. The middle strip gives priority to spec tenant floors. This strip is color coded for Expedia personnel.

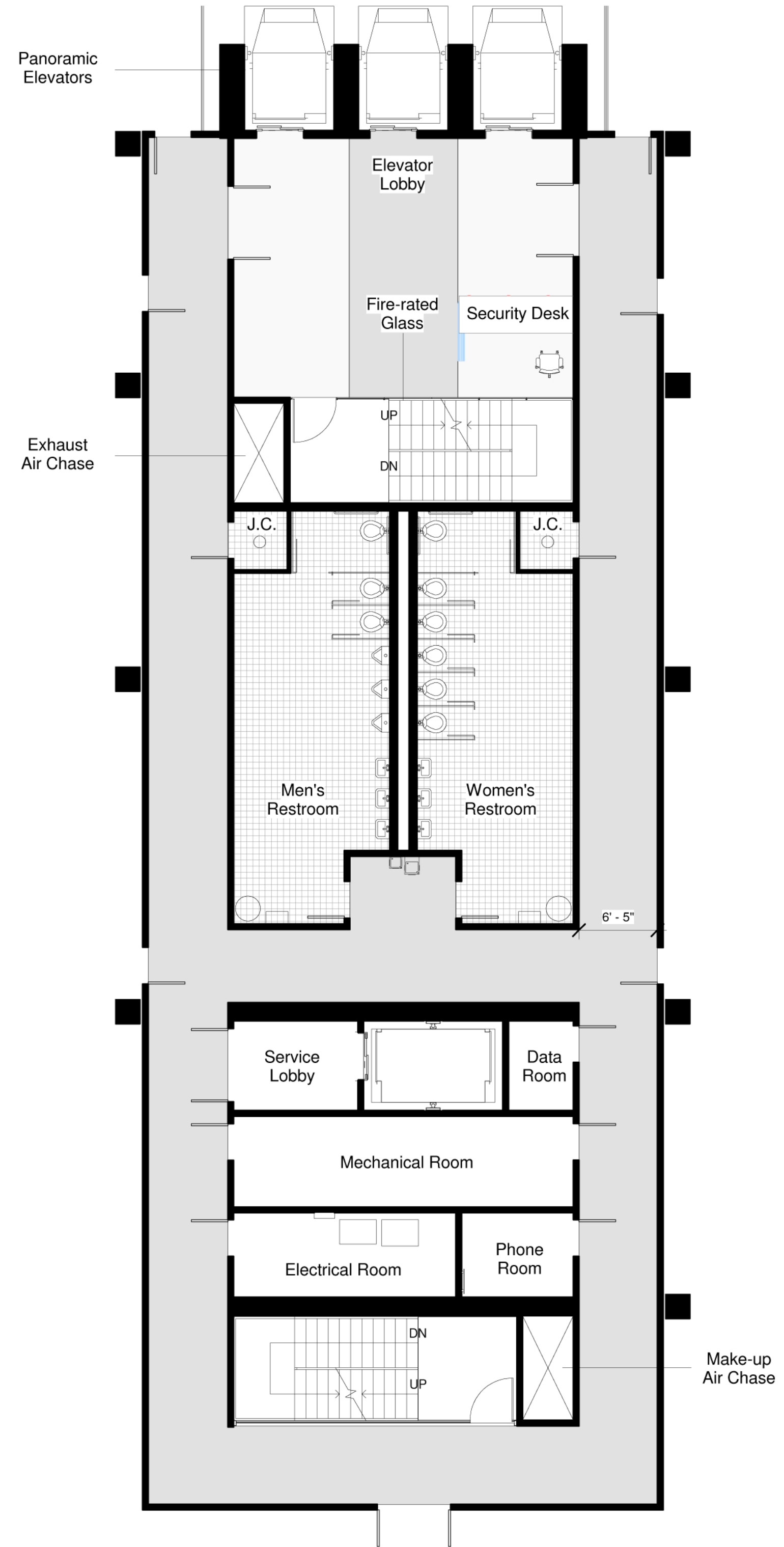

CLARKESPOSITO
ARCHITECTURE

Consultants

Structural Engineer
Hollie Becker
Mechanical Engineer
Matthew Setzekorn
Electrical Engineer
Jim Stadelman
Aeronautic Specialist
David Aston

Contract Information

Forest City
Washington
1615 L Street NW,
Suite 400
Washington, DC
20036

Phone: 202-406-6600
www.dcwashington.com

Kent State University
College of
Architecture &
Environmental Design

Client



Key Plan

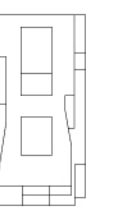

Date: 3/6/2011
Drwn by: Travis Clarke
Chkd by: Harker
Sheet Title:
Core Plan

A-401

Scale: 1/8"=1'
0 1 2 4 8 16

Enlarged Core Plan

