

CORAL REK

A place of nurture and growth

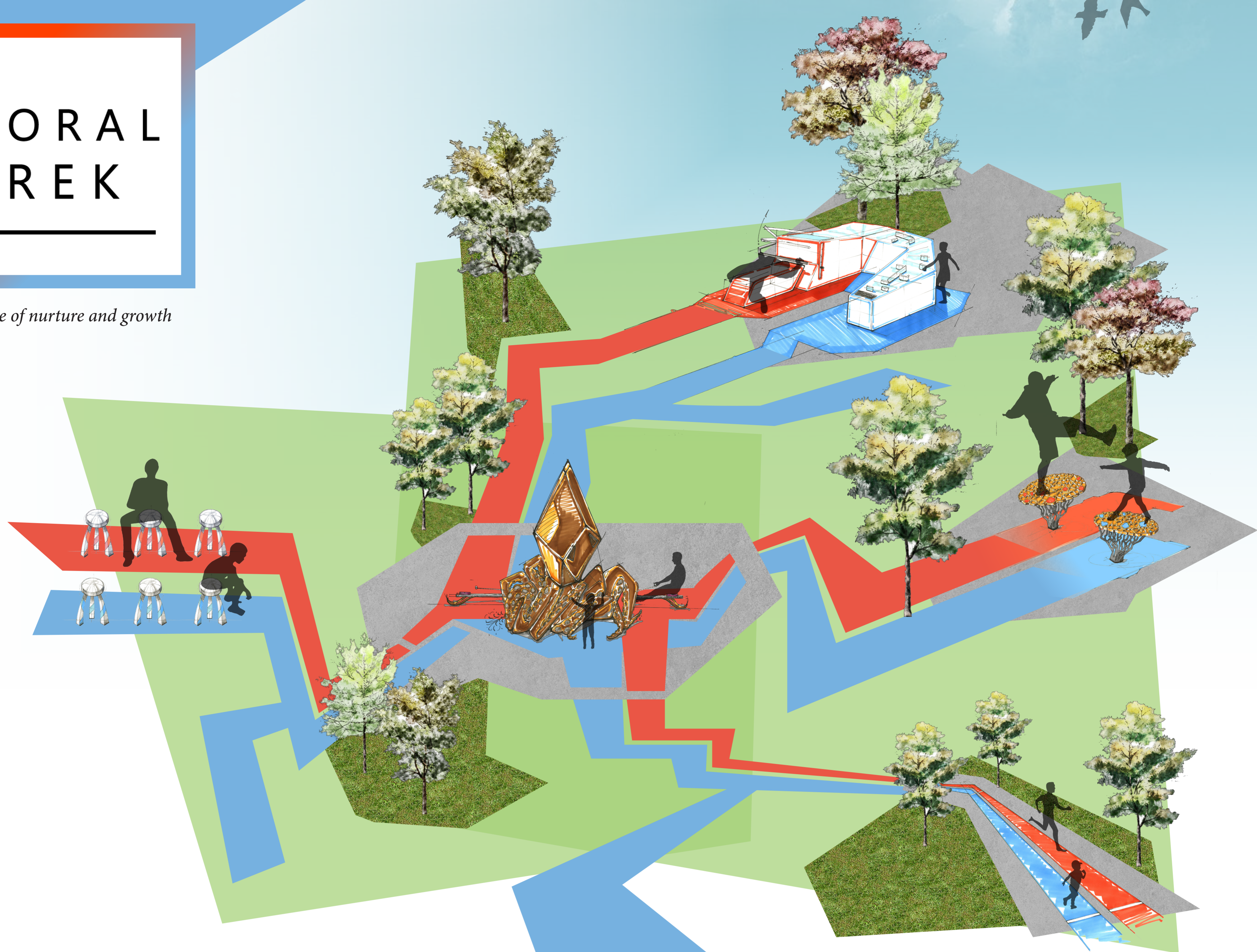

THE COLOUR SCHEME

Coral Rek's colour scheme is specially designed. Blue and orange patterns on the floor spread out in an angled and abstract form, based on natural coral. These are suggested paths for users to stand on. The baby blue is colourful and playful, and is designed especially for children, it symbolises the wide oceans in coral reef, with the child representing a juvenile fish exploring and growing in its surroundings. The dark orange is allocated for adults and is used especially as warning colour, expressing the fact it is for adult use only, stopping the children from getting in the way of adults exercising. However, the paths also allow children to explore using their imagination to make possible games and rules of their own, such as the orange is lava!

From the centre the paths split into four main channels and divide into two colours, this represents the eight limbs of the central octopus sculpture.

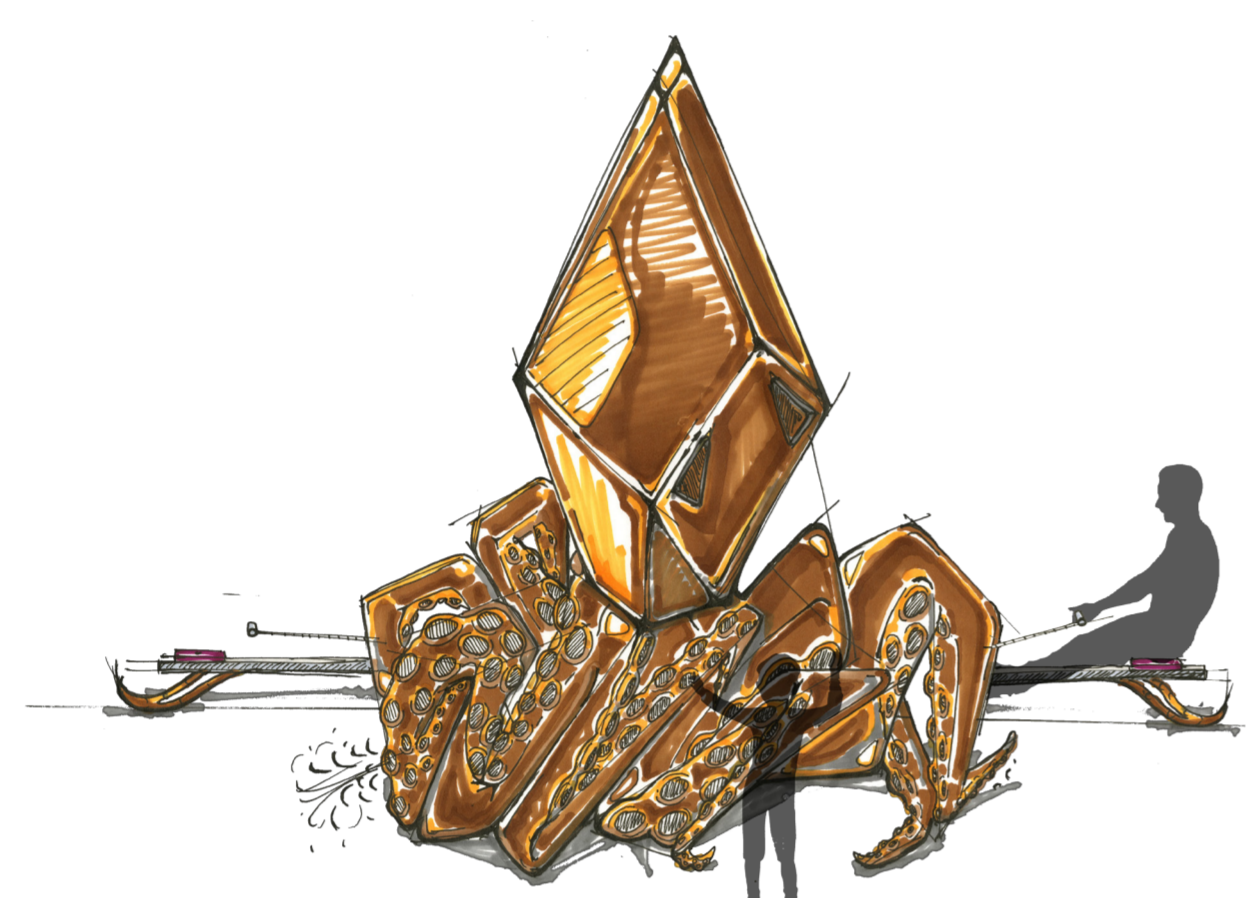

BRONZE OCTOPUS ROWING SCULPTURE

The centre piece of Coral Rek features a bronze octopus, as he is considered the king of the reef. This abstracted design sculpture has a dual purpose. Two rowing rails, like you would expect to find in a gym, are built into either side. These are for the adult to use and therefore is positioned in the orange floored zone. Within eyesight the child plays in the floor area that is blue. When the adult rows, it spins a large fan inside the sculpture that creates a vacuum effect, this vacuum is channelled into the tentacles. When a child covers their hand over the holes, they experience a brief feeling of suction before it changes direction in the valve, resulting in a new position on the suction tentacles. Hopefully the child will find a playful element while seeking the hole that is creating the suction. This will encourage the adult to work harder to sustain play for their child without realisation.

The sculpture is made from bronze, chosen for its luxurious appeal. It displaces a yellow-brown colour similar to rust found on a ship wreck. Bronze is also antimicrobial, reducing germs of the surface from users.



ACTIVITY
Adult: Legs, Arms, Core and Back
Child: Motor skills, Reaction, Brain

Coral Rek is a recreational activity space designed for adults and children to interact together. Coral Rek allows adults to exercise as if they were at the gym without having to leave their children at home.

The proposed place for the construction of Coral Rek is sub urban public and green spaces. This will encourage users to visit Coral Rek as a part of their commute routine, such as pickup from school, and also someone who travels to Coral Rek in order to maintain a fitness routine while involving their children.

Coral Rek is intended to be used after school hours, helping both parent and child to keep active daily lifestyle both physically and mentally. The design is built around the model of a coral reef, due to its bright colours, interesting patterns, and its role in protecting, teaching and growing strength of juveniles.

WEIGHT LIFT WATER WORKS

Weight Lift Water Works is an excellent way to build upper body strength similar to a bench press found at a gym while involving your child. The form of the apparatus is designed to blend in using extruded patterns found on the floor. The adult lays on their back and pushes a bar, which connects to a tank of water behind them. By lifting the bar, it causes water in the tank to lift and overflow. The overflow spills down an angled slope next to the adult where the child is able to manipulate the flowing water and channel the water using creative decisions. The child is driving the adult to subconsciously work harder to improve their enjoyment. The user can select the weight of water they are lifting, however to help with demanding children, the output of water will remain the same.

The fluid dynamics of the play activity and the surge of water produced by the adult represent the changing currents in natural coral reefs.

ACTIVITY
Adult: Arms, Back, Shoulders
Child: Brain, Motor skills

GENERATION JELLYFISH STOOLS

These stool are not just for sitting on. When parent and child sit opposite each other, twisting and spinning their body moves a motor which generates electricity. The challenge is now for both parent and child to charge their jellyfish stool the fastest. The charge level is indicated via LED strips wrapped around the legs of the stool. When the charge reaches the top, the LED's provide a strobe effect on the losing stool. They then receive the energy built from the winning stool sent to the motor, causing the losers stool to spin!

The semantics of the stool are abstracted from a jellyfish. The soft slippery seat is based on a jellyfish head and the sting is similar to the white LED's used to gesture electrical shocks. Shiny stainless steel visual appeal and has a high resistance to corrosion for outdoor use.

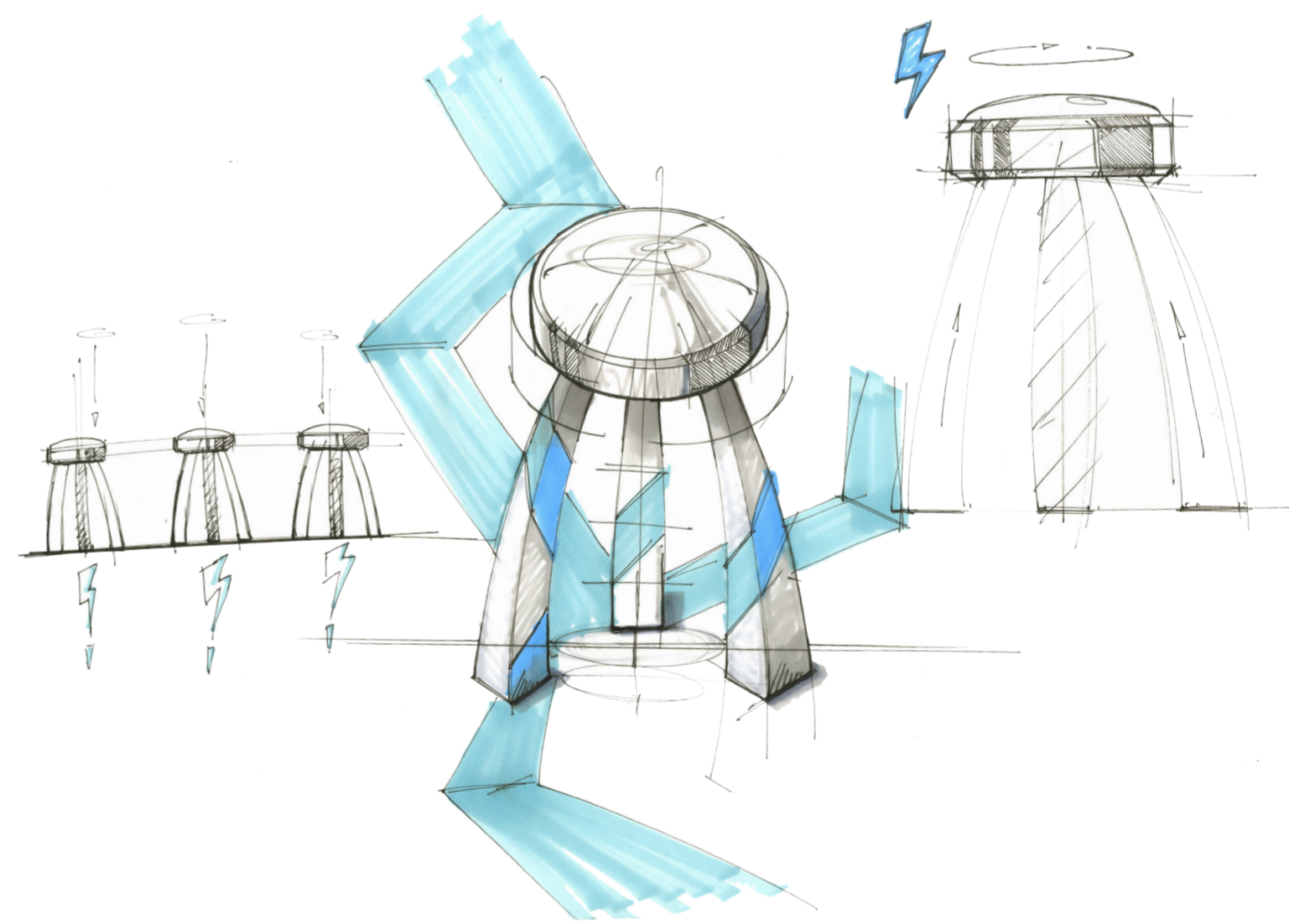

ACTIVITY
Adult: Stretching, Back, Balance
Child: Stretching, Back, Balance

BRAIN CORAL BALANCE

Brain Coral Balance is sculptural art and interactive activity. The shape of a natural brain coral has been abstracted into the form of large bronze discs, the pattern used creates a potted surface for grip. The discs are supported by rubber legs that are abstracted from dead sea-fan coral, which are both naturally black. Both adult and child stand on their own unstable disk and attempt to balance. The element of fun in the activity is challenging the opponent to copy or sustain an amount of time stood on the disk.

In addition to physically working the core muscles, the activity challenges and heavily stimulates the brain. This is connected to the type of coral the disk is inspired from being a 'brain coral'.

ACTIVITY
Adult: Balance, Core, Legs, Brain
Child: Balance, Core, Legs, Brain



RACING LANES

Racing lanes, the element of fun in this activity is challenging the other user to race or perform exercise over the length of the track. Studies show that obvious lanes with start and finish lines trigger inner feeling of challenge. An interesting experiment I performed was drawing a simple start and finish line in chalk on a pavement, then observing the amount of groups who without prior consultation instantly started to race!



ACTIVITY
Adult: Reaction, Running
Child: Reaction, Running

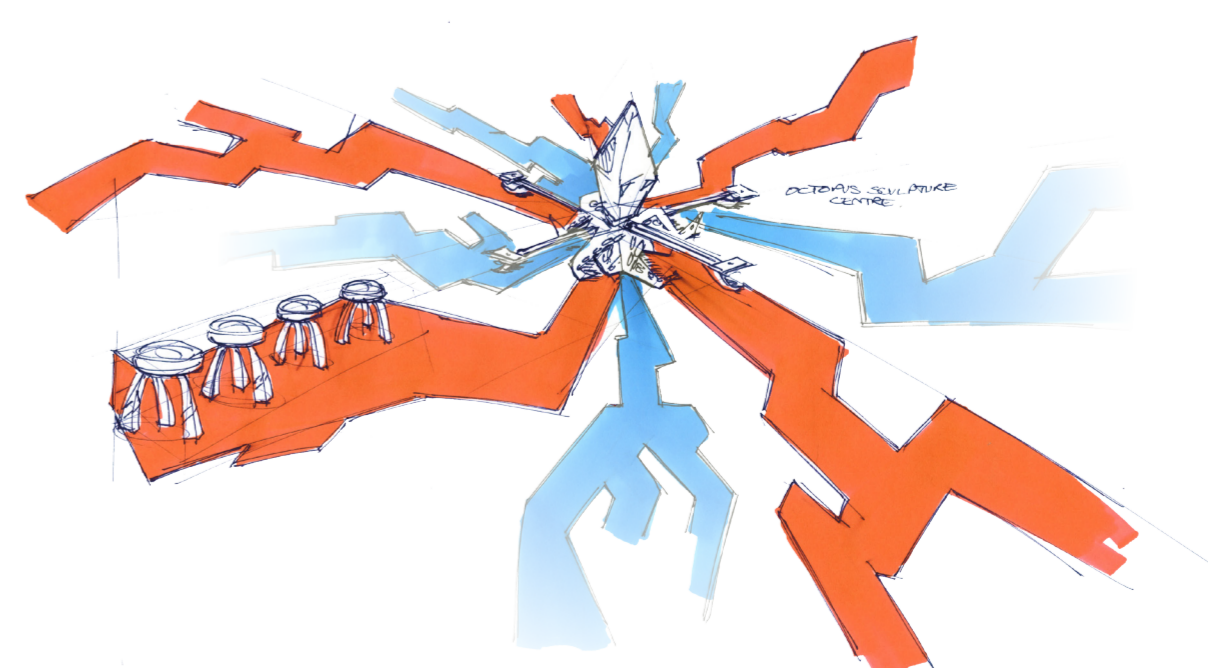

TEACHING & UX DESIGN

In addition to an active experience, Coral Rek will teach younger children skills such as sports, competition, sharing, obedience and discipline while having fun. Coral Rek's UX design allows a better experience for all. Compared to a conventional park where parents stand waiting around until their hyperactive child is tired. The exhibitions displayed at Coral Rek will feature plaques with clear information on use and the coral reef inspiration behind them, through design they will be intuitive and native. Essentially, Coral Rek is embodying the eco system of a reef, using a community.

CORAL REK

The logo itself uses the combination of orange and blue, which then faded creates the exact colour of 'natural coral', additionally the font text spacing is clearly spread expressing the growth and spread of the paths.
Mark Stone - 11014914 - skandi4designs@gmail.com
Original images and Sketches (Excluding trees, slow/fast lane, silhouette images)