



HABITAT FOR LIFE OBERLIN, OHIO

EACH DISTRICT IS DEVELOPED TO PROVIDE FOR A SPECIFIC SPECIES.

Each species requires different types of vegetation and landscape development.

As an effect of this, the habitants of each district would be able to realize and compare the change of views and species movement throughout the year.

MASTER PLAN



Attracts and provides for **Butterflies**

DOGWOOD

PAW PAW

SMOOTH SUMAC

Attracts and provides for **Hummingbirds**

BLACK CHERRY

ASTER FLOWERS

REDBUD

WHITE PINE

Attracts and provides for **Ducks**

DEEP POND

MARSH GRASS

General

MAIN BIKE TRAILS

OBSERVATION POINTS

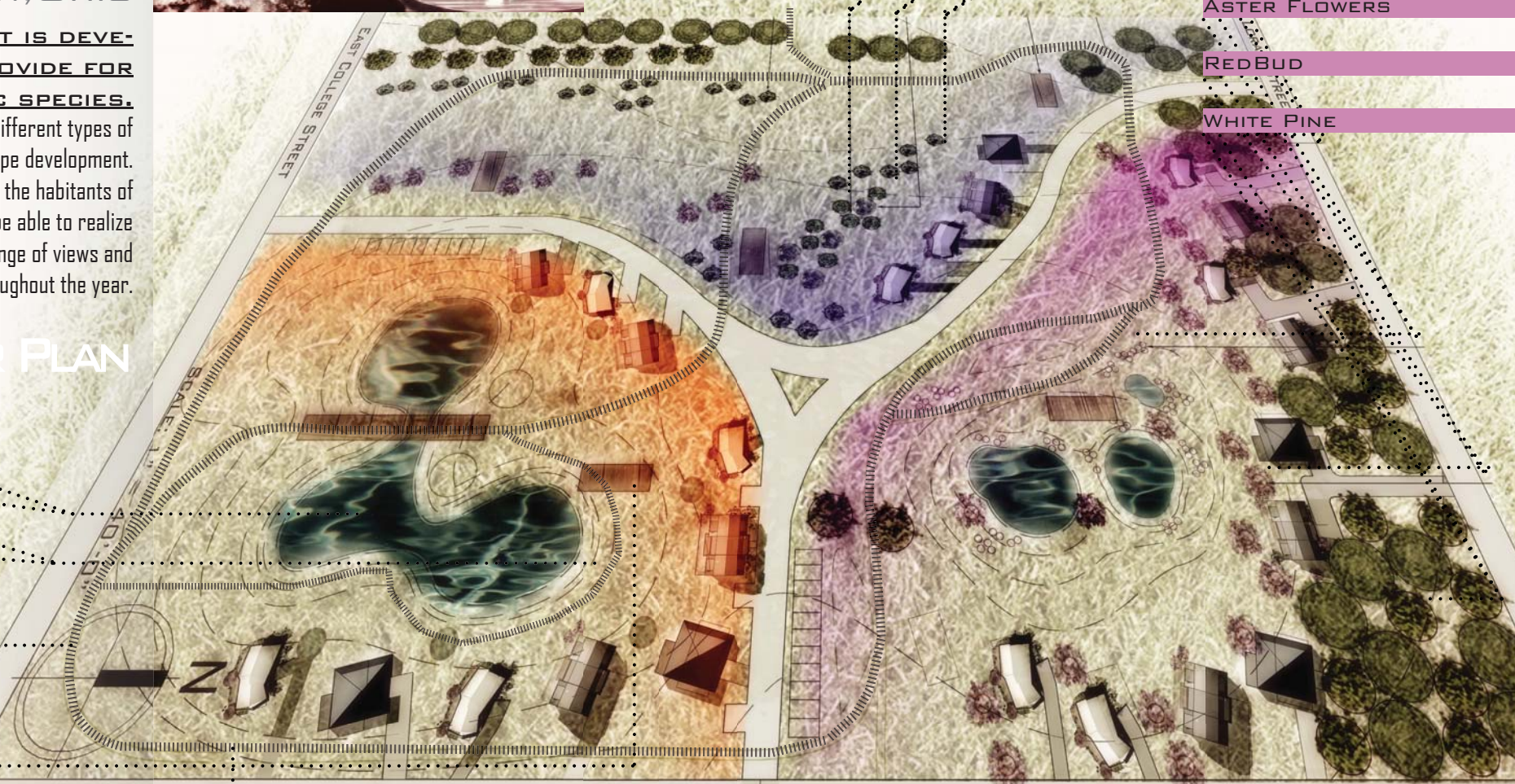

OBERLIN ROAD

The design development of the master plan and the house are conceptually connected. The mission statement is:

TO CREATE AN INTERACTIVE HABITAT BETWEEN PEOPLE AND NATIVE WILDLIFE SPECIES

456'-6"

474'-0"