

Richard Pilbeam

Industrial & Graphic Designer

Portfolio & Curriculum Vitae

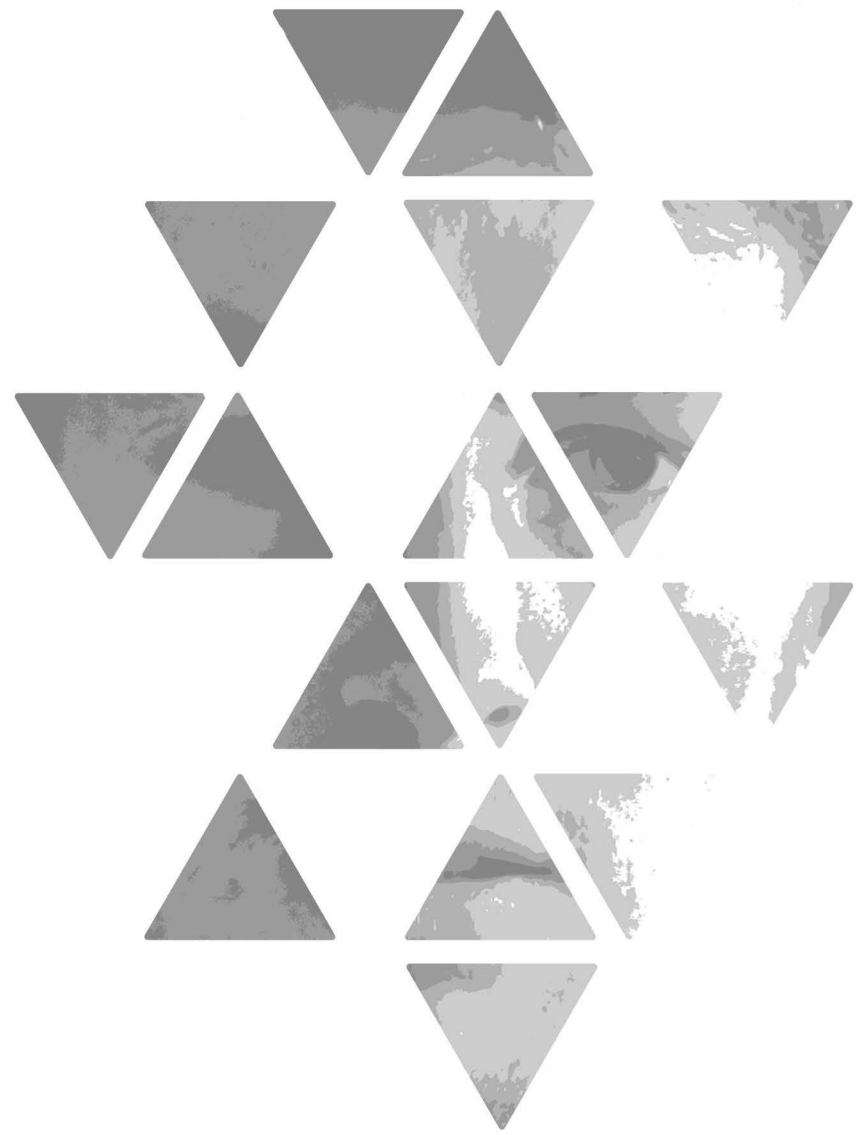



release[®] DESIGN



graphic & product Design. developing
simple and elegant products worldwide

release[®] CLOTHING



offering high quality, affordable
clothing, from t-shirts-to-tantalising
luxury wear

releas e[®] DESIGN



Industrial
Design

Website,
Graphic,
Promotional &
Logo
-Design



Graphic Design

Industrial Design



Industrial Design



Industrial Design



Graphic/Logo Design



Industrial Design



Graphic/Web & Clothing Design

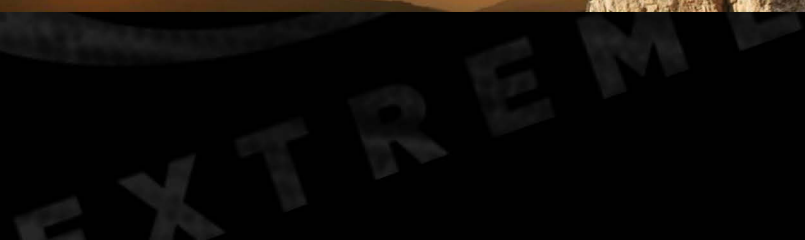



EXTREME

'Fresh Peaks' is an up and coming urban brand designed for students, by students. here are a few promotional images and logo designs i have done for them...

FP





FRESH

PEAKS

fresh.peaks.clothing@facebook.com
[@freshpeaksuk](https://www.facebook.com/freshpeaksuk)



FRESH

PEAKS

fresh.peaks.clothing@facebook.com
[@freshpeaksuk](https://www.facebook.com/freshpeaksuk)

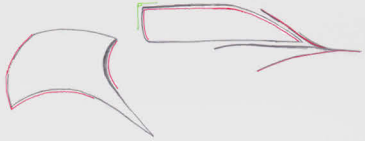
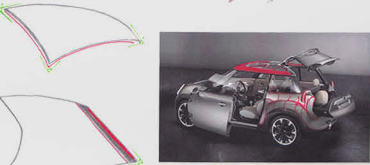
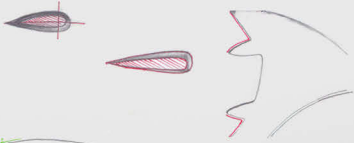

...understanding the brand, what makes Mini, Mini and what helps people recognize a Mini as a Mini...

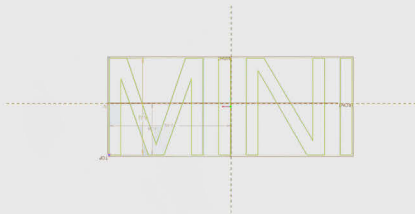
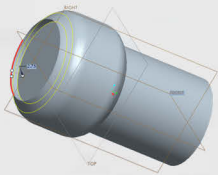
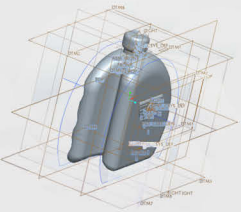
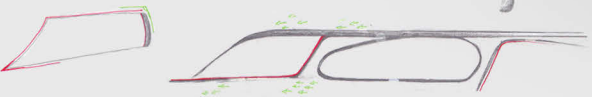

Mini Oil Bottle

the brief was to design an oil bottle for Mini, taking into account the characteristics of the brand.

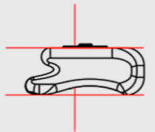
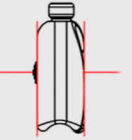
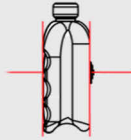
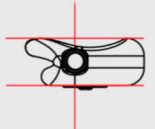

...design ideas...

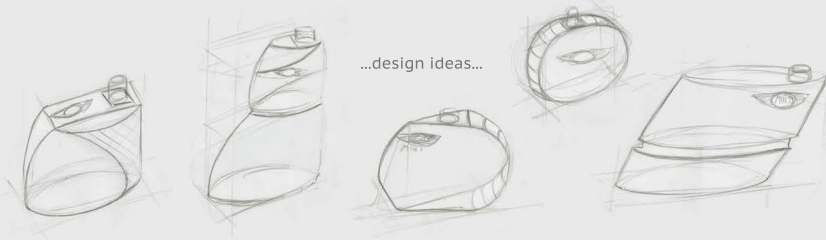

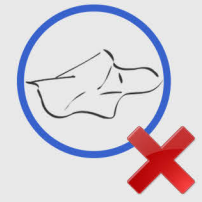

THE DETTOL 'SURFACE-SWIPE' ALLOWS THE USER TO CLEAN LARGE OPEN AREAS WITHOUT HAVING TO USE MORE THAN ONE ITEM. DURING CLEANING THE USER SIMPLY PRESSES A BUTTON AND IMMEDIATELY CLEANING DETERGENT IS RELEASED THROUGH THE CLOTH, SITUATED AT THE BOTTOM OF THE PRODUCT. THE 'SURFACE-SWIPE' ALSO MINIMISES STORAGE, AS THERE IS NO LONGER ANY NEED FOR SPRAY'S AND SEPERATE CLOTHS, THE 'SURFACE-SWIPE' ACTUALLY SAVES YOU SPACE!

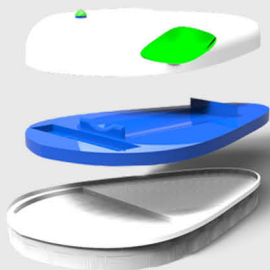
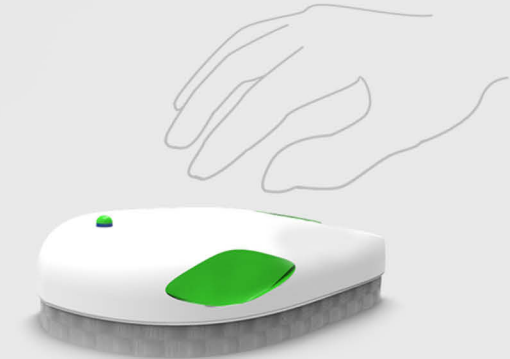

THE OUTER CASING OFFERS THE USER A VERY COMFORTABLE AND PRACTICAL HOLDING POSITION. THIS IS ACHIEVED BY THE THUMB GROOVES ON THE SIDES AND THE GENTLE TWO WAY CURVES THROUGHOUT THE PRODUCT.

THE MIDDLE SECTION HOLDS THE CLEANING FLUID. THIS IS WHERE THE LIQUID IS RELEASED BY THE USER AND DEPOSITED THROUGH TO THE CLOTH - AND SUBSEQUENTLY ONTO THE CLEANING SURFACE.

THE BOTTOM IS FINISHED WITH A CLOTH , WHICH CAN EASILY BE DETACHED FROM THE MAIN BODY TO BE EITHER CLEANED OR REPLACED.

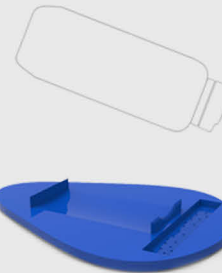

THE USER MUST USE A STANDARD 250ML DETTOL BOTTLE IN ORDER TO FIT INTO THE PRODUCT. THIS AIDS SPACE SAVING AND ALSO MATERIAL WASTEAGE. THIS MAKES THE PRODUCT LIGHTER AND EASIER TO USE.

WHEN THE USER PRESSES THE BUTTON ON TOP, THE CLEANING FLUID IS DISTRIBUTED INTO THE TROUGH, WHICH THEN FILLTERTHROUGH THE CLOTH AND ONTO THE CLEANING SURFACE. SIMPLE AND VERY EFFECTIVE

Promotional Widget

the below shows a promotional widget designed for PG tips. i am currently in the process of discussing the production of this product with several companies.

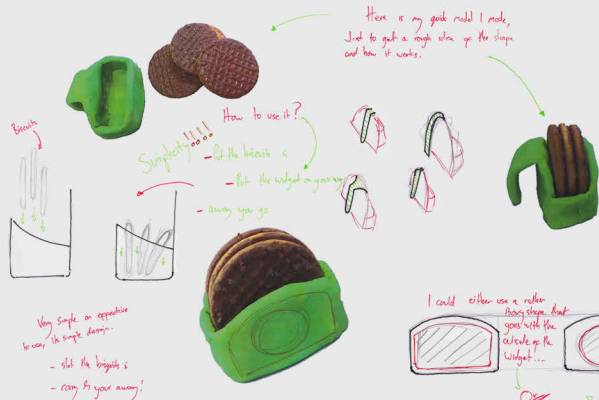

Here is my quick model I made, just to get a rough idea of the shape and how it works.

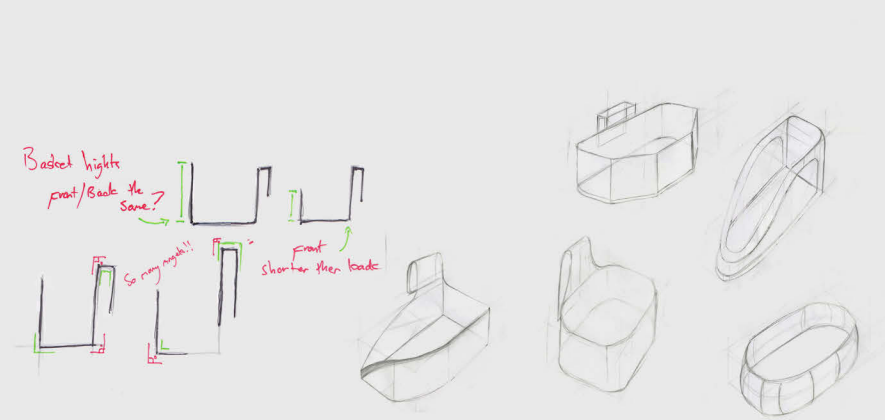
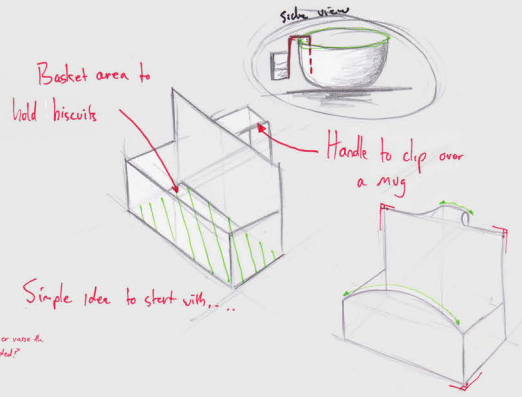

Widget Mould Block & Engineering Drawings

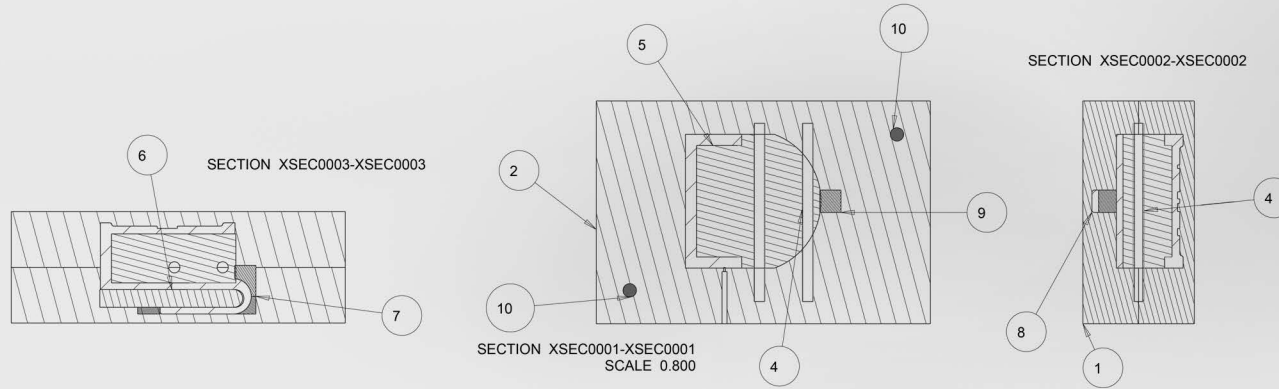

...engineering drawing's of my mould blocks and inserts...

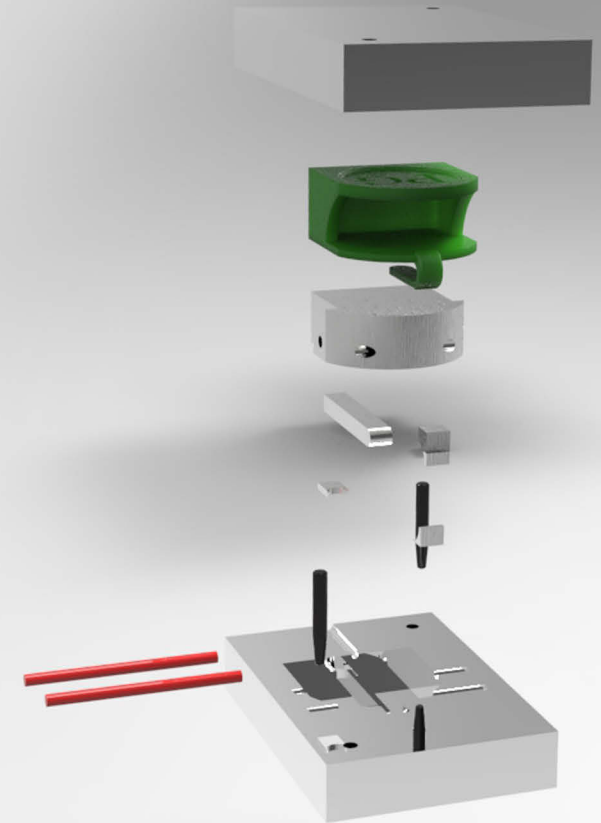
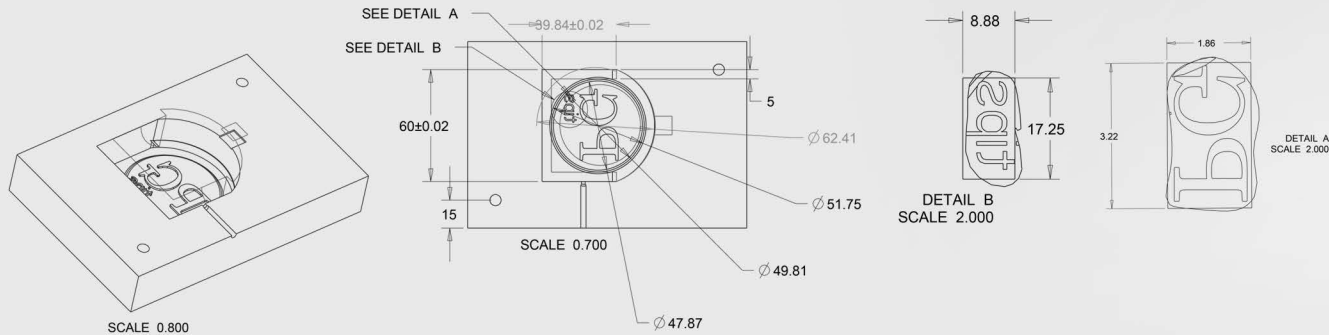

...here is an exploded view of all the inserts, mould block's and finished product...

designed for free-runners;
allowing them to download, track and record their
routes through and above the city landscape

FREE+track

...design ideas...

...design development...

MICRO USB PORT

BELT FASTENS THROUGH HERE

NAVIGATION BUTTONS



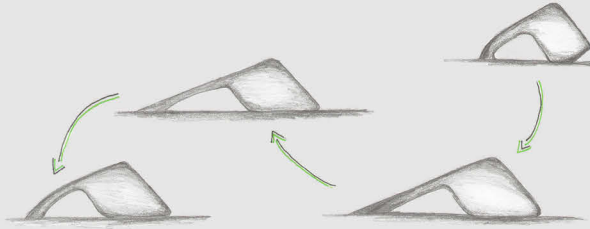

...elevations of the final design...

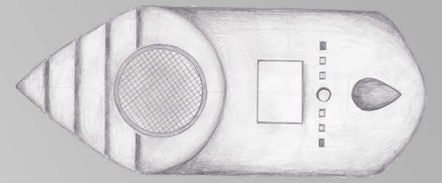
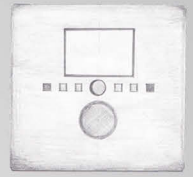
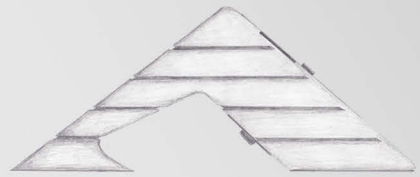

Retro Streamline Radio

the brief was 'design a compact, retro streamlined radio' ...

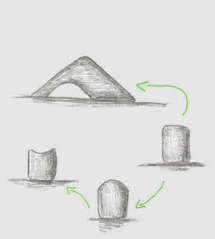

...designs and development...

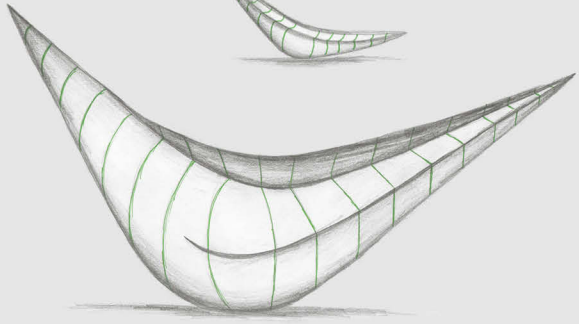
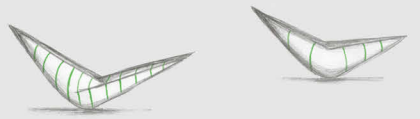

A dramatic scene of a volcanic eruption. A bright, glowing lava flow is visible in the upper center, with a large, rounded lava rock in the foreground. The word "Release" is overlaid in a stylized, glowing font. The background is dark, emphasizing the intense light of the lava.

Release



release

CLOTHING

 release.clothing@facebook.com

 [@releaseclothing](https://twitter.com/releaseclothing)

urban outfitters - coming soon

releas e[®]

CLOTHING

Idea to bring
the brand in to
the clothing
sector

Simple,
effective &
efficient
Designs

T-shirts
& Jumpers



small



small



medium

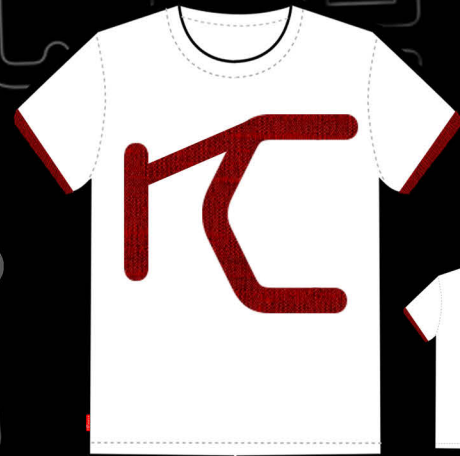
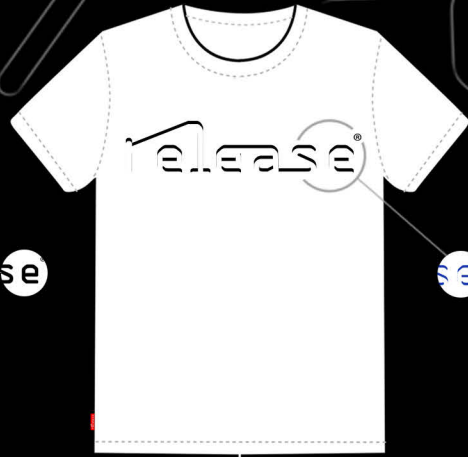

CLOTHING



release

R.R.P £20.00

Richard Pilbeam

Curriculum Vitae

CURRENT DEGREE STUDIES...

Industrial Design Studies

2nd Year at Loughborough University

Brief: Design an outdoor eating device that delights the target user and provides a hugely desirable and appropriate hot eating experience on location

CAD—Creo Pro Engineer

Brief: Your assignment is to design and create a Creo assembly model of a USB stick, which must be to scale and can fit the necessary components

Interaction Design

Brief: Design a bolt on function for the “O2 Wallet” App. An Adobe Flash simulation will be required at the end of your submission, along with wire frame maps of how your App will work as well as all your user research

Manufacturing Techniques

Brief: Design a promotional widget for PG Tips. After designing your widget, you will then make an Injection mould and produce your widget. A Creo model along with Engineering Drawings will be required

Industrial design Studies

1st Year at Loughborough University

Brief: Design a DAB radio that provides a more interesting and original aesthetic design than current DAB offerings. The image portrayed by the product should be congruent with the higher end of the home audio market, however you need to break new ground and create something innovative. Then complete a scaled blue foam model of your final design

Brief: Design an oil can for Mini. Your final design must take in the characteristics of what makes Mini, Mini. A CAD Model must be completed of your final design, along with two presentation boards showing your development and research

Ergonomics

Brief: As a group you have been commissioned by a facilities management company to design a ticket machine for a pay and display car park. A full-scale model must be produced as well as research pages.

CAD—Creo Pro Engineer

Brief: Your assignment is to create a Creo model of a molded plastic bottle

Brief: Your task is to design and create a Creo assembly of a child’s scooter.

Electronics and Mechanics

Brief: Program and create a circuit board with three LED’s, which light up when an input is inserted, such as heat, touch or light.

Programme of study: We were taught about mechanics and did a presentation at the end of term about levers as well as making crane prototypes to understand how gears worked.

EDUCATION...

Loughborough University – Reading Industrial Design & Technology (B.A.)

September 2011-2014

Eastbourne College – A Levels: Design & Technology (Grade A) Art (Grade A) Drama (Grade B) September 2009- July 2011

St. Bedes School – GCSE’S: 8 at Grades A-C (Including Maths and English)

September 2006- July 2009

Software Experience...

All Microsoft Office Programmes
Creo Pro engineer
Adobe Photoshop
Adobe Flash

Contact...

Email r.pilbeam-11@student.lboro.ac.uk

Mobile 07884433069

Address Pashley farm,

Ninfield Road.

Bexhill-on-sea

TN39 5JS

Work Experience...

Richard Rogers - May 2010

(www.rsh-p.com)

After my G.C.S.E.'s I gained work experience at Richard Rogers in London. As one of the largest Architectural companies in the world, it was a great privilege and unique experience.

SBG - June 2011

(www.stainlessglassandbrass.co.uk)

SBG Architectural Metalworkers, offer a bespoke high quality architectural metalwork service for the whole of the UK. I learnt how to work with metal, utilising its quality and trying to find ways of making spaces more efficient, in the manufacture of staircases.

Posturite - June 2012

(www.posturite.co.uk)

Posturite is the UK market leader in the design, manufacture and distribution of posture-improving products for the workplace. I studied their product range, offering a fresh set of ideas and opinions.

Sampsons - July 2012

(www.sampsonsouvenirs.com)

Sampsons Ltd is a leading supplier of UK souvenirs and Gifts for Tourist and visitor attractions, developing bespoke design merchandise. I looked into expanding their product range, performing some product and user research for their London branch. After completing my research, I started to design and develop some product ideas for them.

Surface Solutions – 2010 to 2012

(surface-solution@btinternet.com)

Surface Solutions is a company that polishes and prepares any metal surface to an extremely high quality, from door knobs to the engine manifolds for the cars featured in the Fast and Furious films. I used all the latest metal polishing equipment, from power tools to fixed grinders and polishing wheels, as well as sand/walnut blaster and spray painting.

Employment...

FGS Group - Summer, Christmas & Easter 2011 and 2012

(www.fgsgroup.co.uk)

FGS are fencing and landscaping contractors who work across the south east of England. This was tough manual work and in many projects, very rewarding, as we were able to completely redesign large areas of barren landscape, for some of the largest new build companies in the country.

This taught me commitment, dedication and the need to be responsible for ones actions. It has also enhanced the development of my life skills.

Personal Skills and Hobbies...

I am a keen hockey player and have represented the South of England. I currently coach one of Loughborough University Women's Hockey Club teams, this has taught me patience, tolerance, leadership, how to motivate and encourage people to work well as a team.

Since a few years ago, I was a member of UK National Theatre School. I travelled to London on a weekly basis, to develop my drama and acting skills. This gave me confidence and also enhanced my presentation and communication skills.

I want to make a difference, and see my products being used. I enjoy the process of seeing an idea become reality. I am an extremely hard worker and will always following something through to the end. I want to be the one holding that finished product and knowing that it was I that designed it....

About Richard Pilbeam...

Being born and bred on a farm, I have always been regarded as a practical person being around machinery and getting my hands dirty from an early age.

'Knuckle down and get on with it' – has been a family motto. I am always the one who will take on any challenge, nothing to big or small, and guarantee to give my all in everything I do.

As a family we have travelled worldwide on safaris and camping expeditions, including The Sahara, Namibia and South Africa. From this I have experienced many different cultures seen some amazing sights and gained some unforgettable memories!

It is all these valuable life skills that make me who I am – up for a challenge, and prepared to give anything a go!

Contact...

Email r.pilbeam-11@student.lboro.ac.uk

Mobile 07884433069

Address Pashley farm,

Ninfield Road,

Bexhill-on-sea

TN39 5JS



release[®]
DESIGN



Richard Pilbeam

r.pilbeam-11@student.lboro.ac.uk

07884433069

Pashley Farm,
Ninfield Road,
Bexhill-on-sea,
TN39 5JS