

# FOOTLOOSE

Canterbury - Spring 2013

DIRECTOR: Tara Quellhorst

SCENIC DESIGNER: Richard Miller

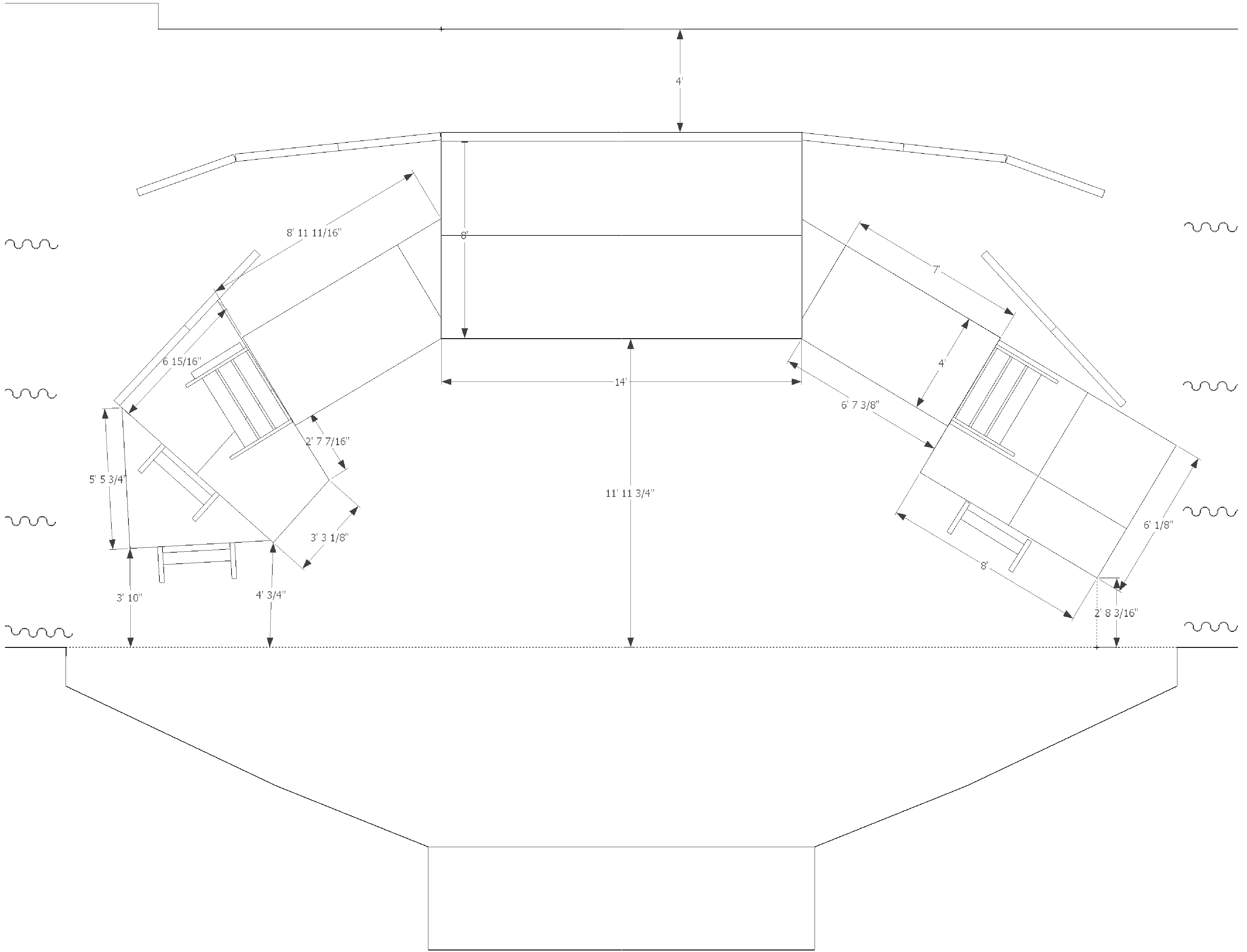

**FOOTLOOSE**  
 Canterbury - Spring 2013  
 DIRECTOR: Tara Quellhorst  
 SCENIC DESIGNER: Richard Miller

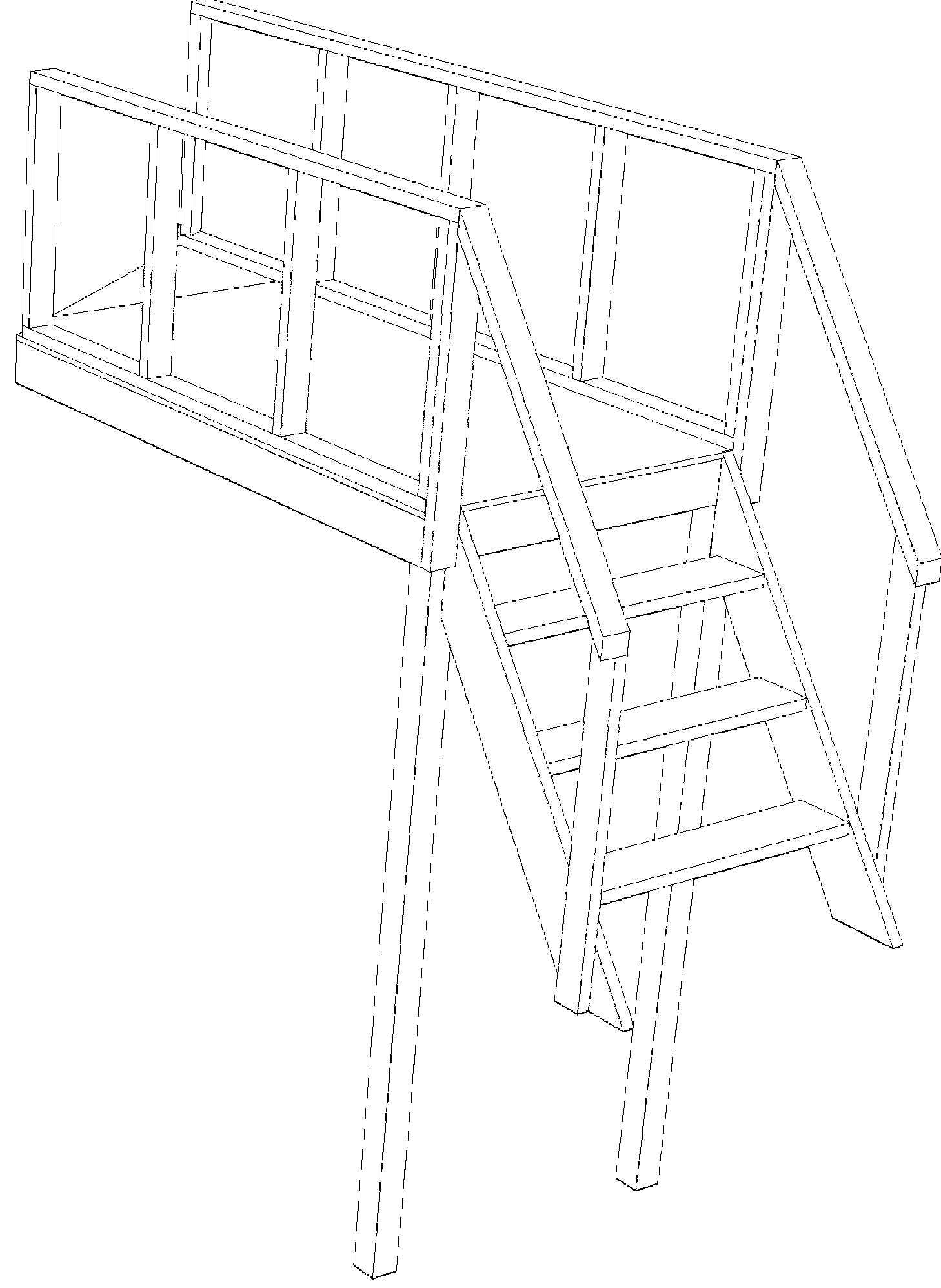
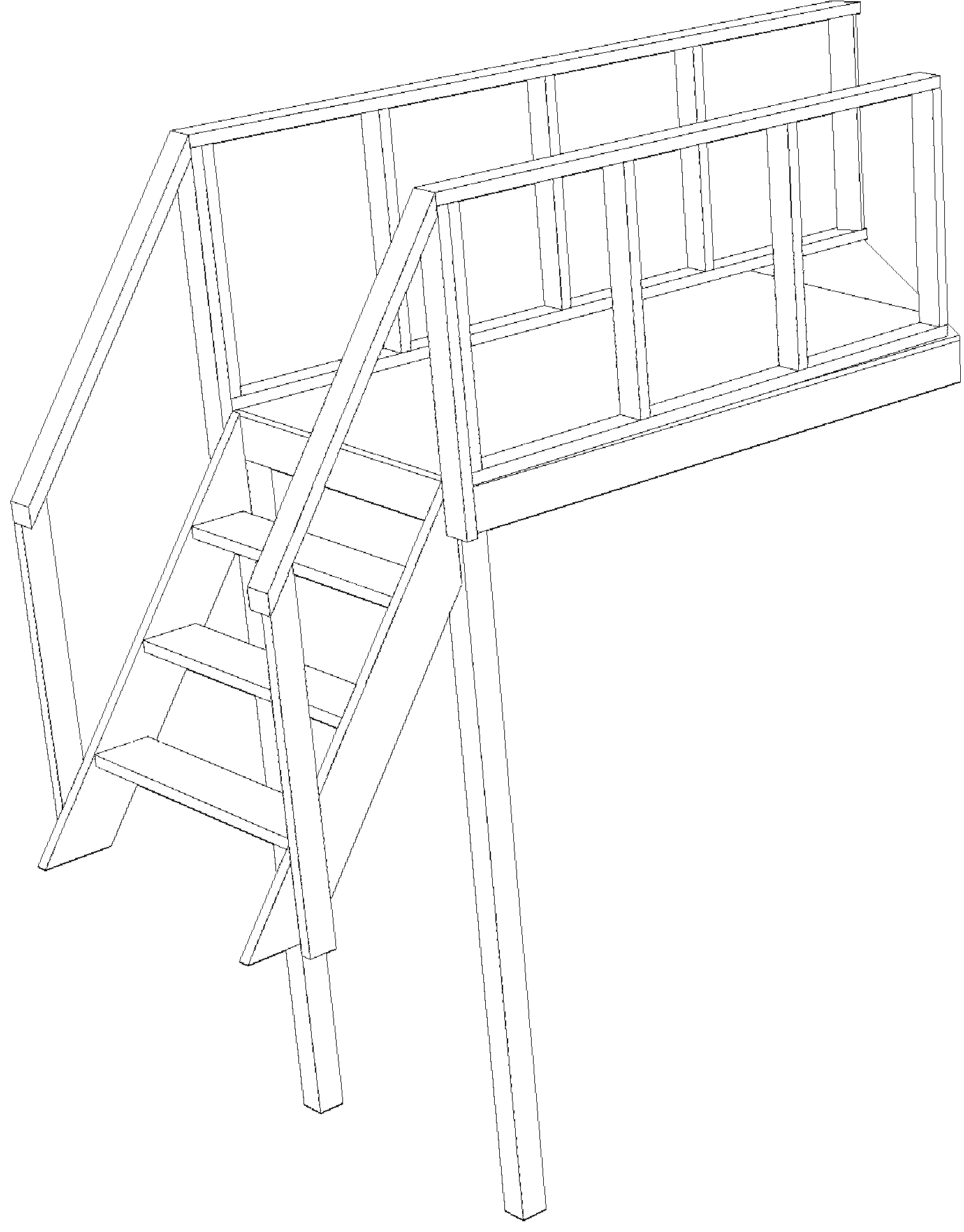

# FOOTLOOSE

Canterbury - Spring 2013

DIRECTOR: Tara Quellhorst

SCENIC DESIGNER: Richard Miller

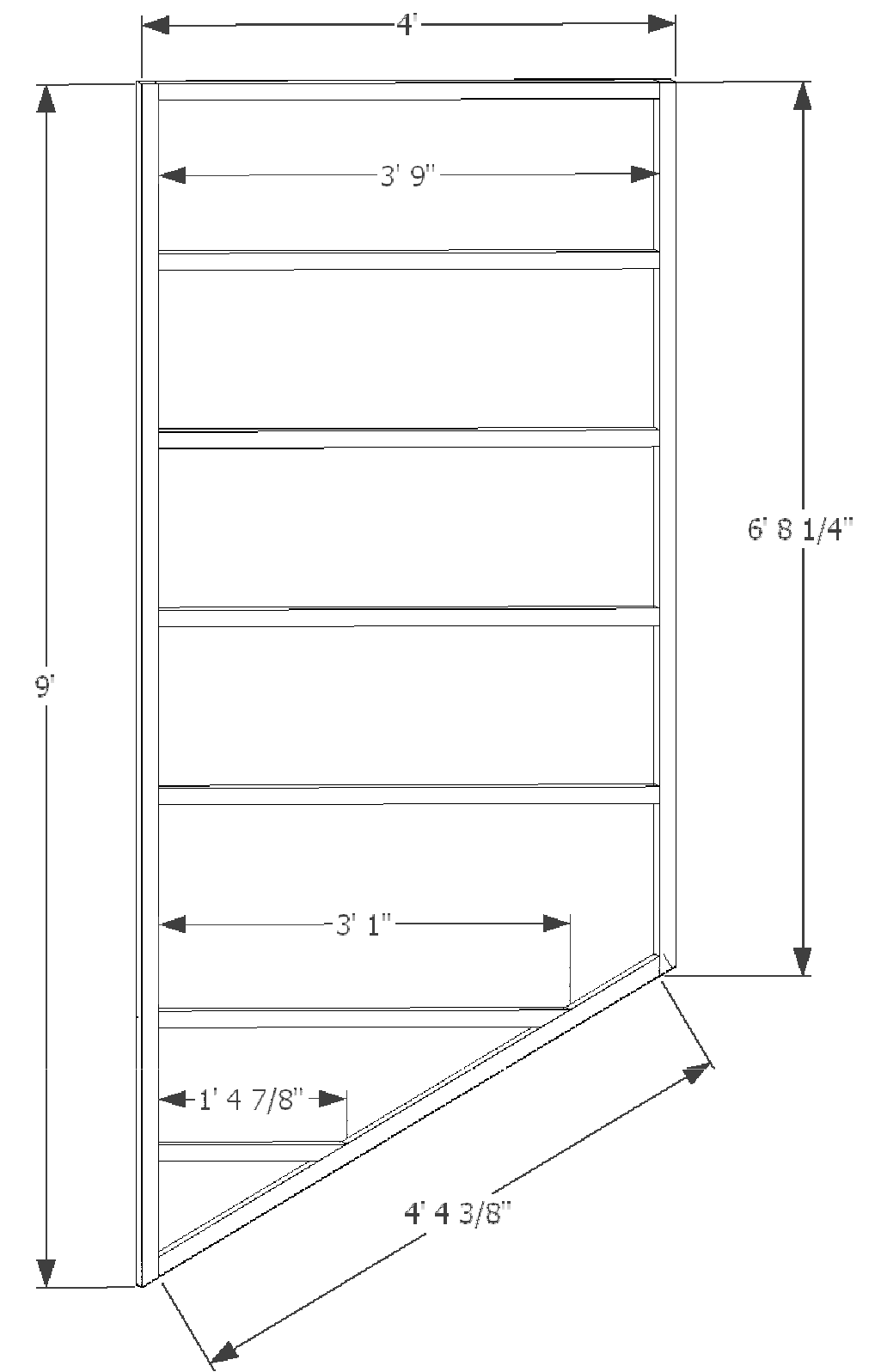
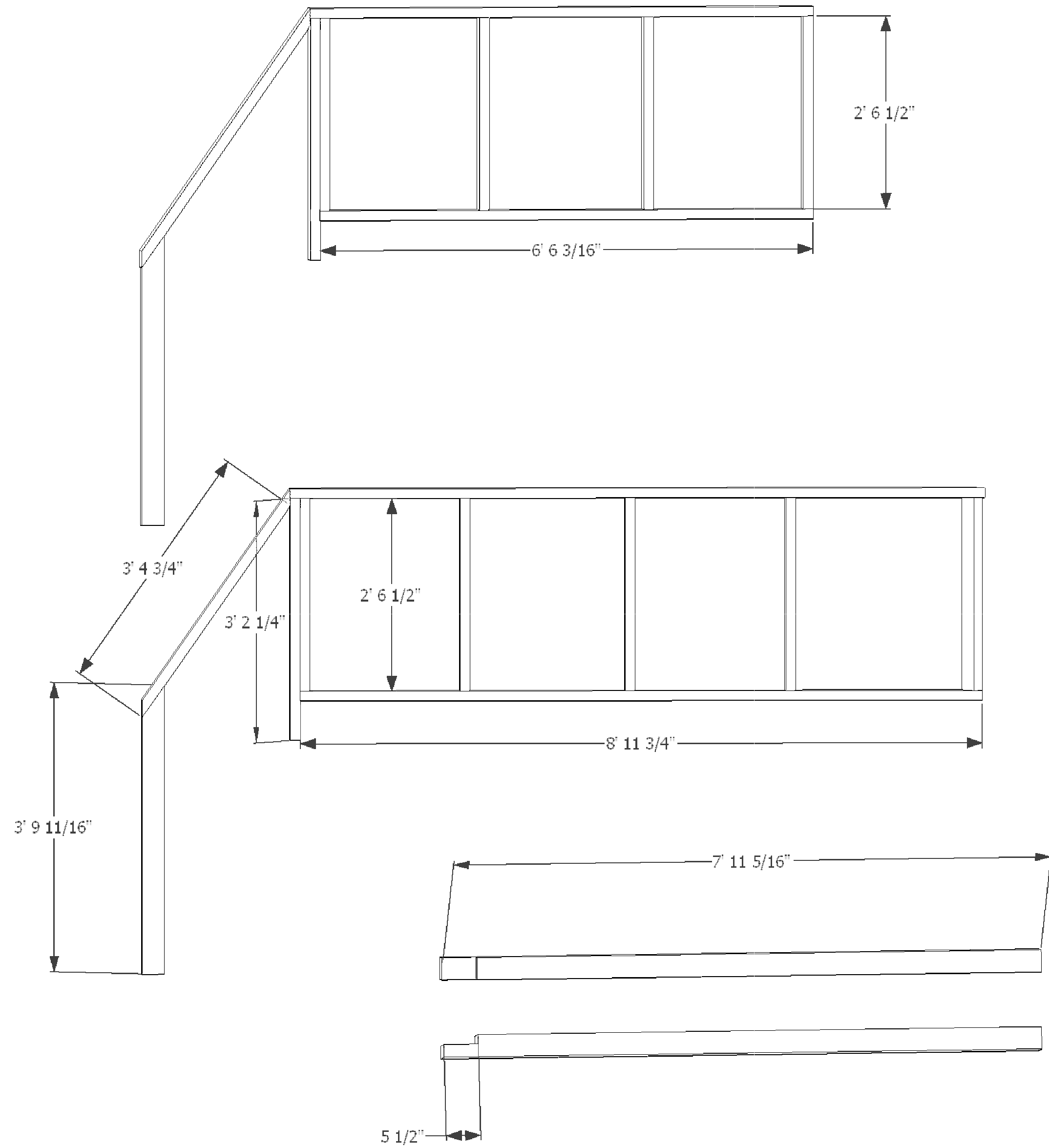

Note: These drawings are for the stage right bridge. Position of rails and construction of platform are to be reversed for stage left.

Legs are 4x4 with a  $5 \frac{1}{2}" \times 1 \frac{1}{2}"$  notch at the top to accept the platform's fram.

Handrails framed entirely from 2x4.

# FOOTLOOSE

Canterbury - Spring 2013

DIRECTOR: Tara Quellhorst

SCENIC DESIGNER: Richard Miller

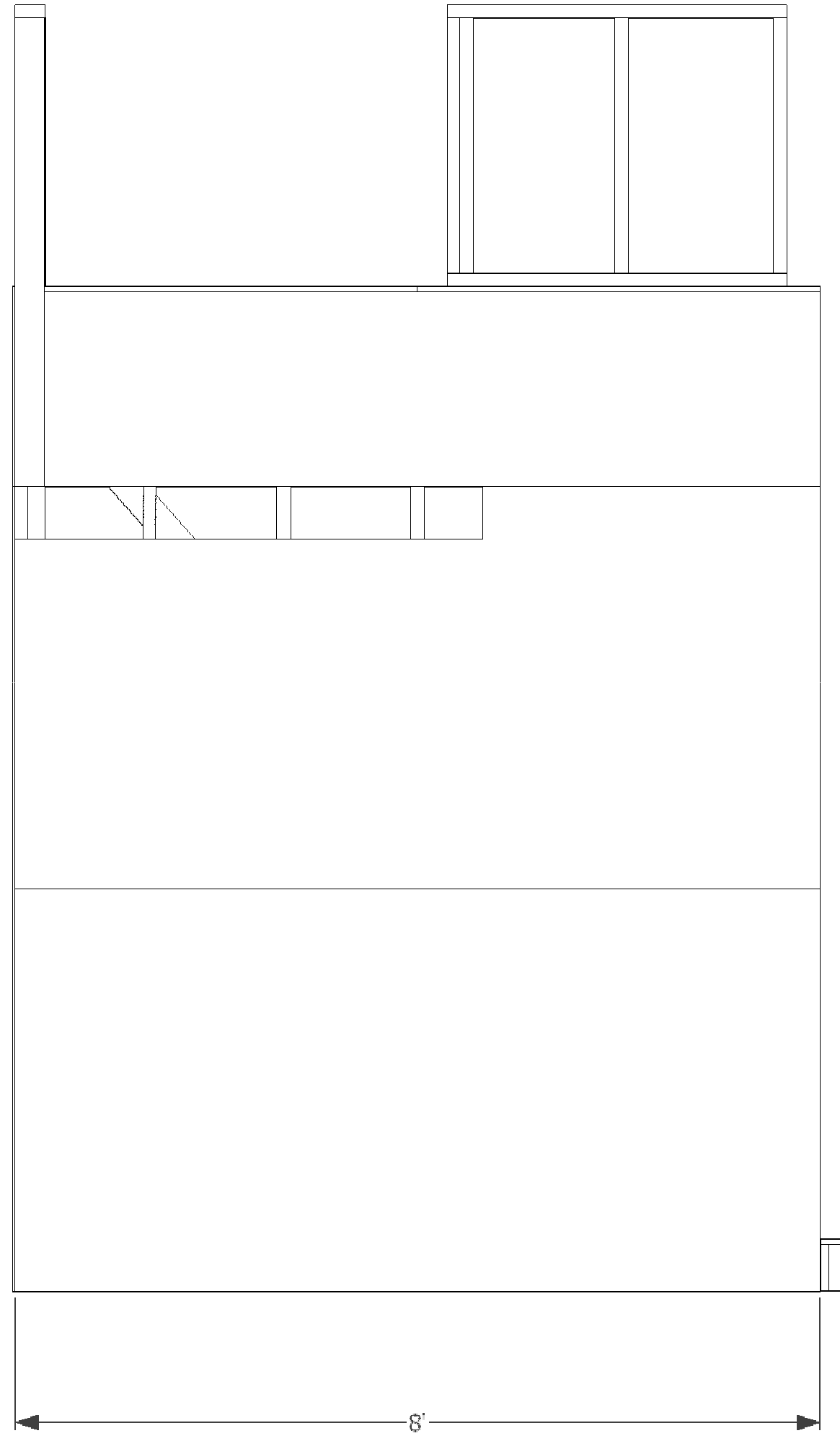
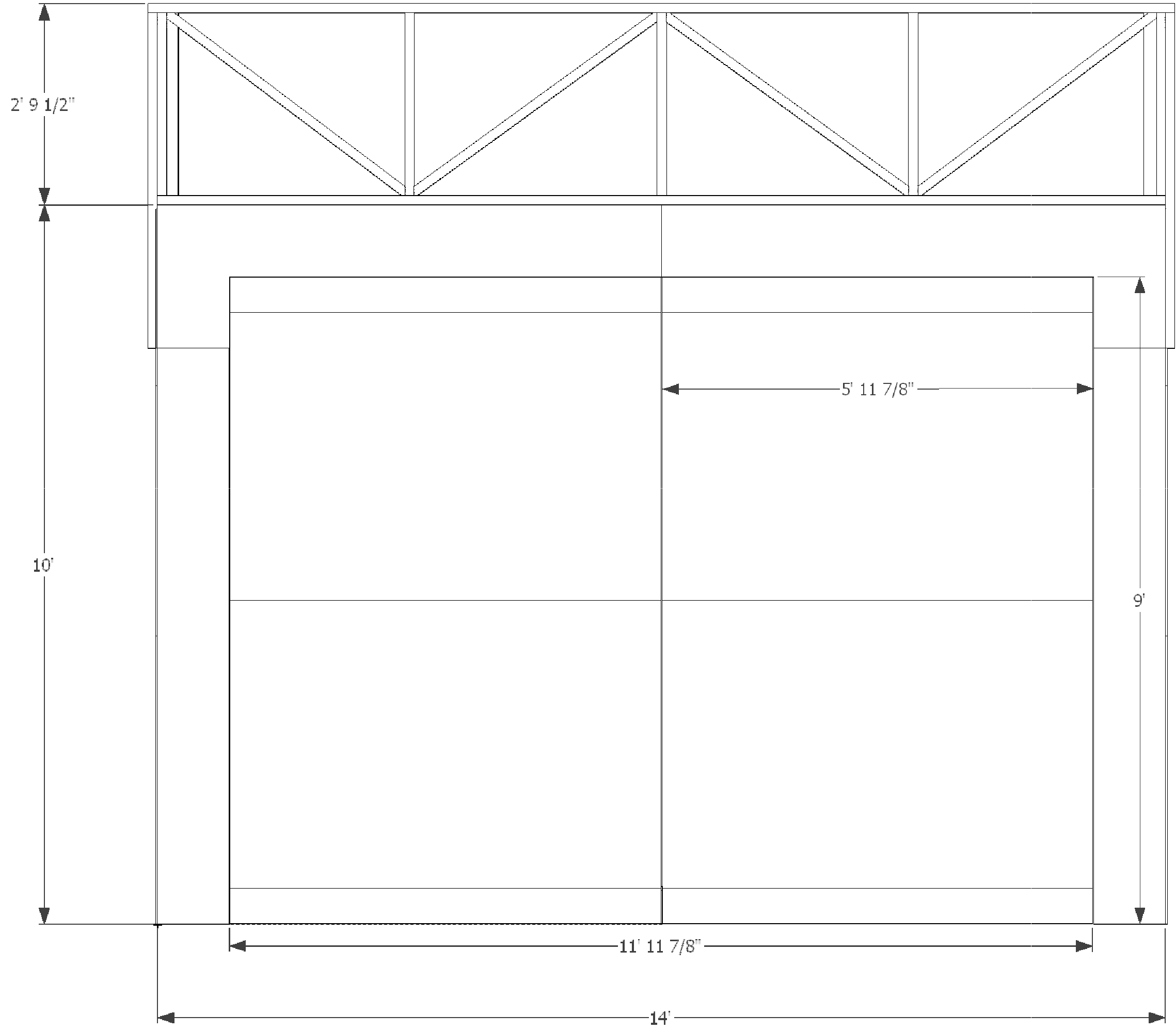

# FOOTLOOSE

Canterbury - Spring 2013

DIRECTOR: Tara Quellhorst

SCENIC DESIGNER: Richard Miller

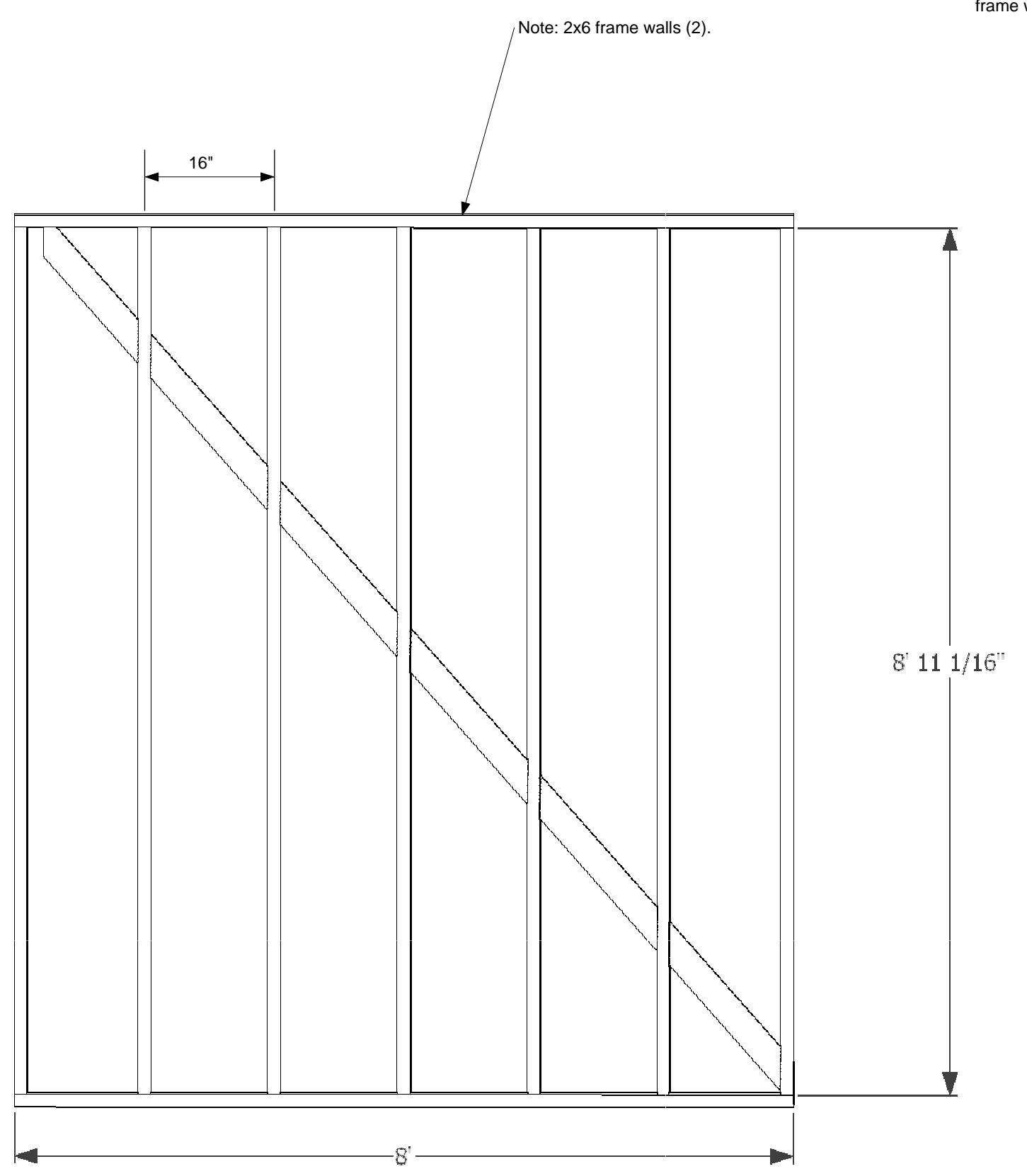
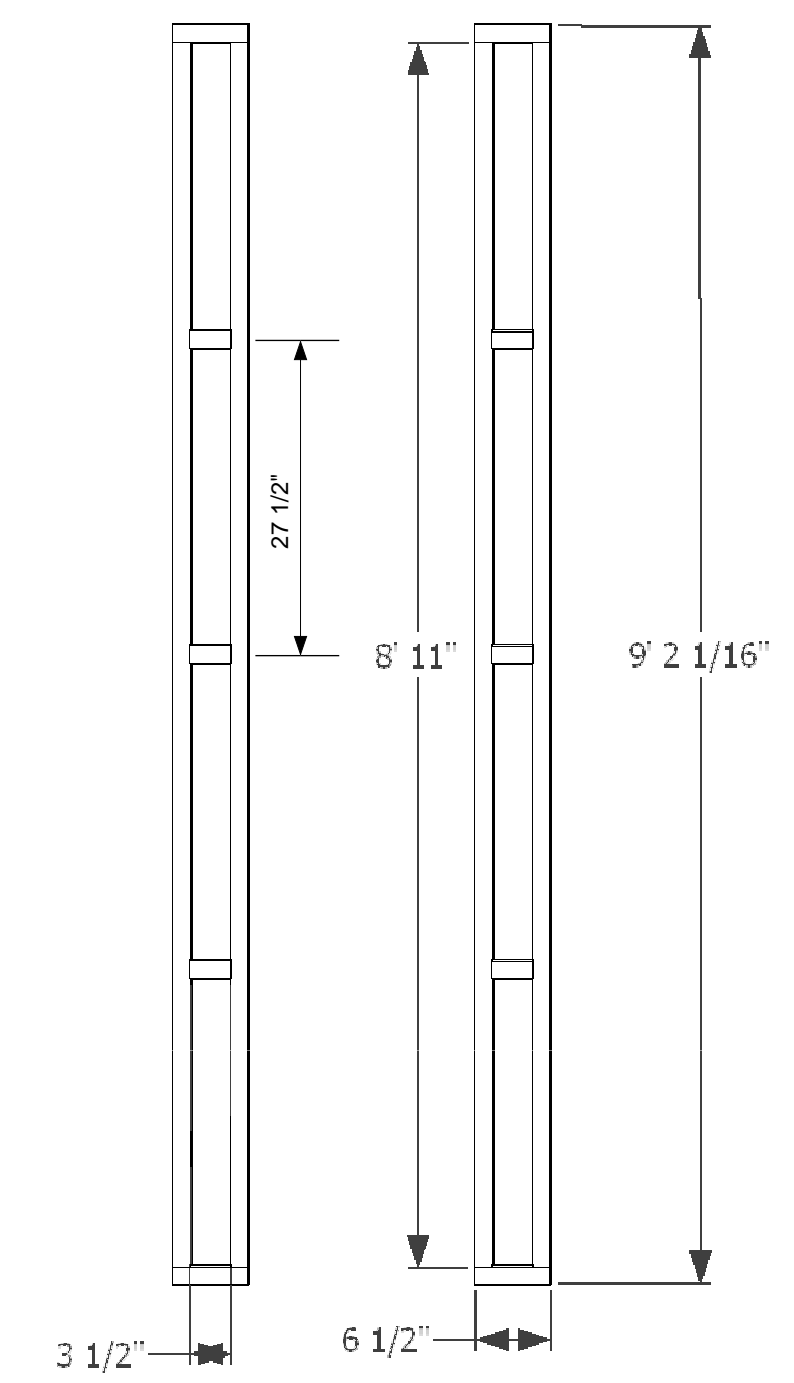

Note: 2x10 joists to be framed in place after frame walls are erected.

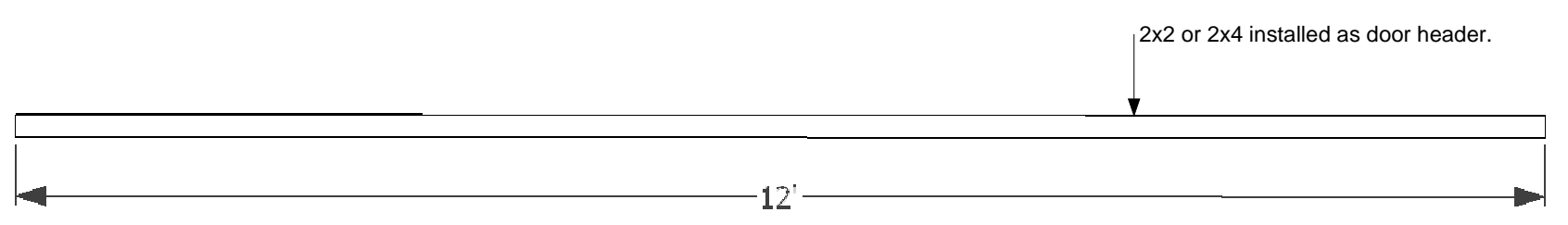
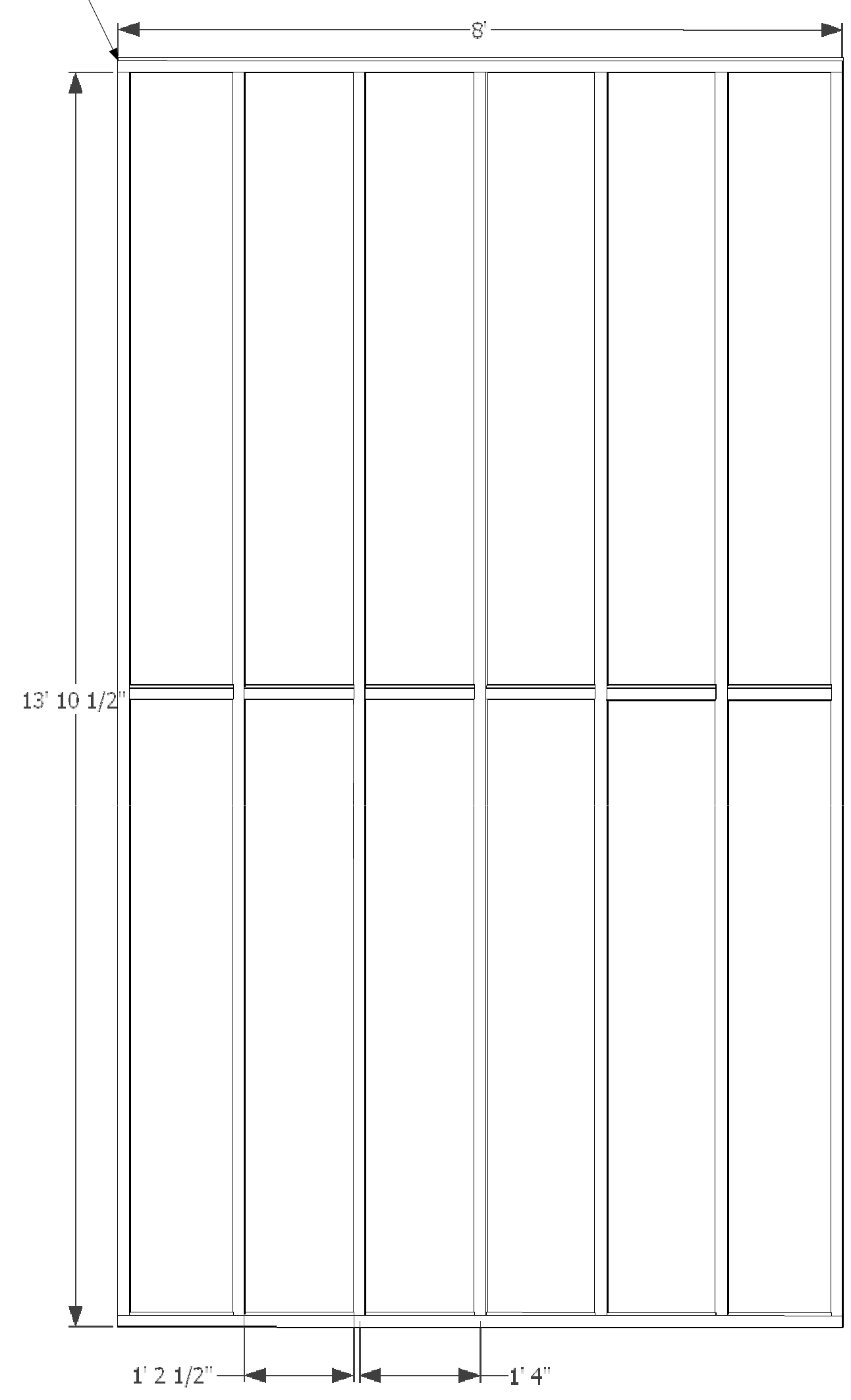

**FOOTLOOSE**  
 Canterbury - Spring 2013  
 DIRECTOR: Tara Quellhorst  
 SCENIC DESIGNER: Richard Miller

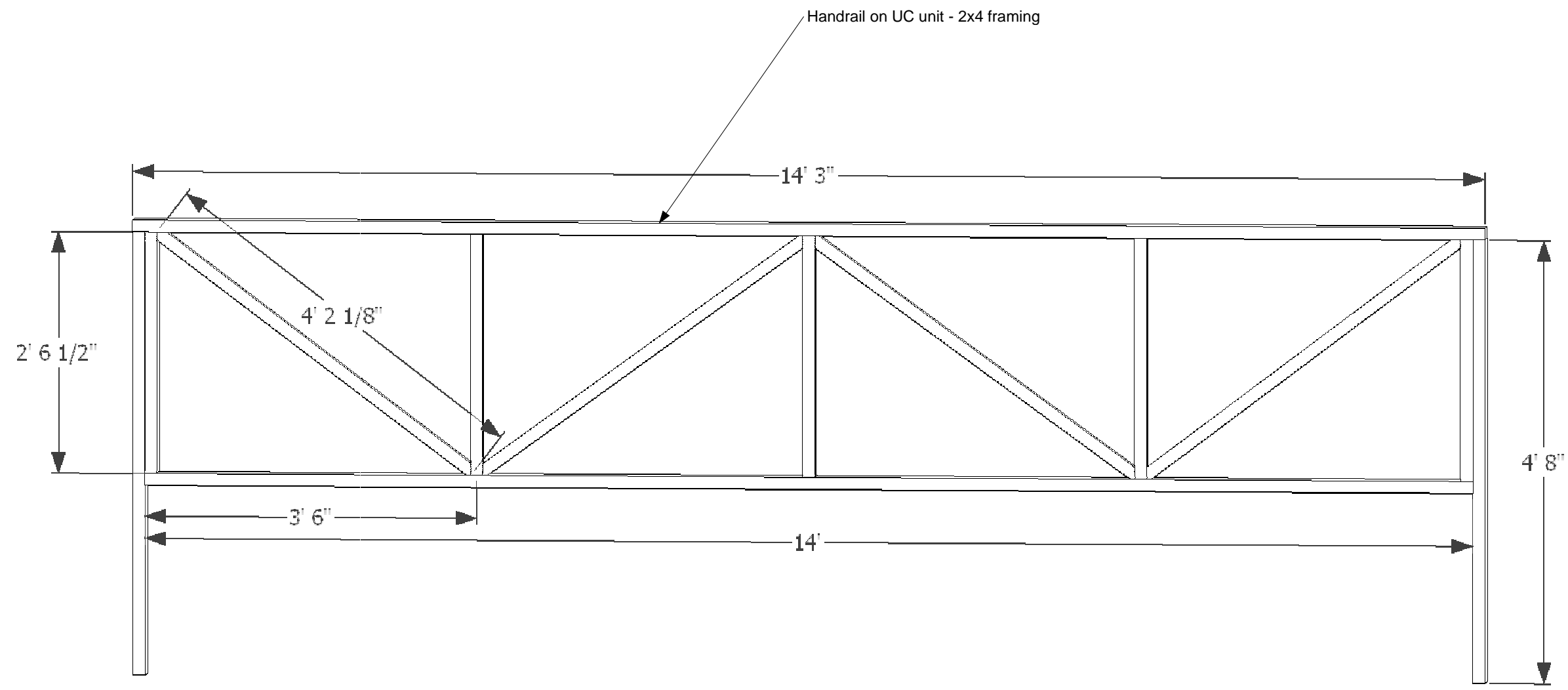
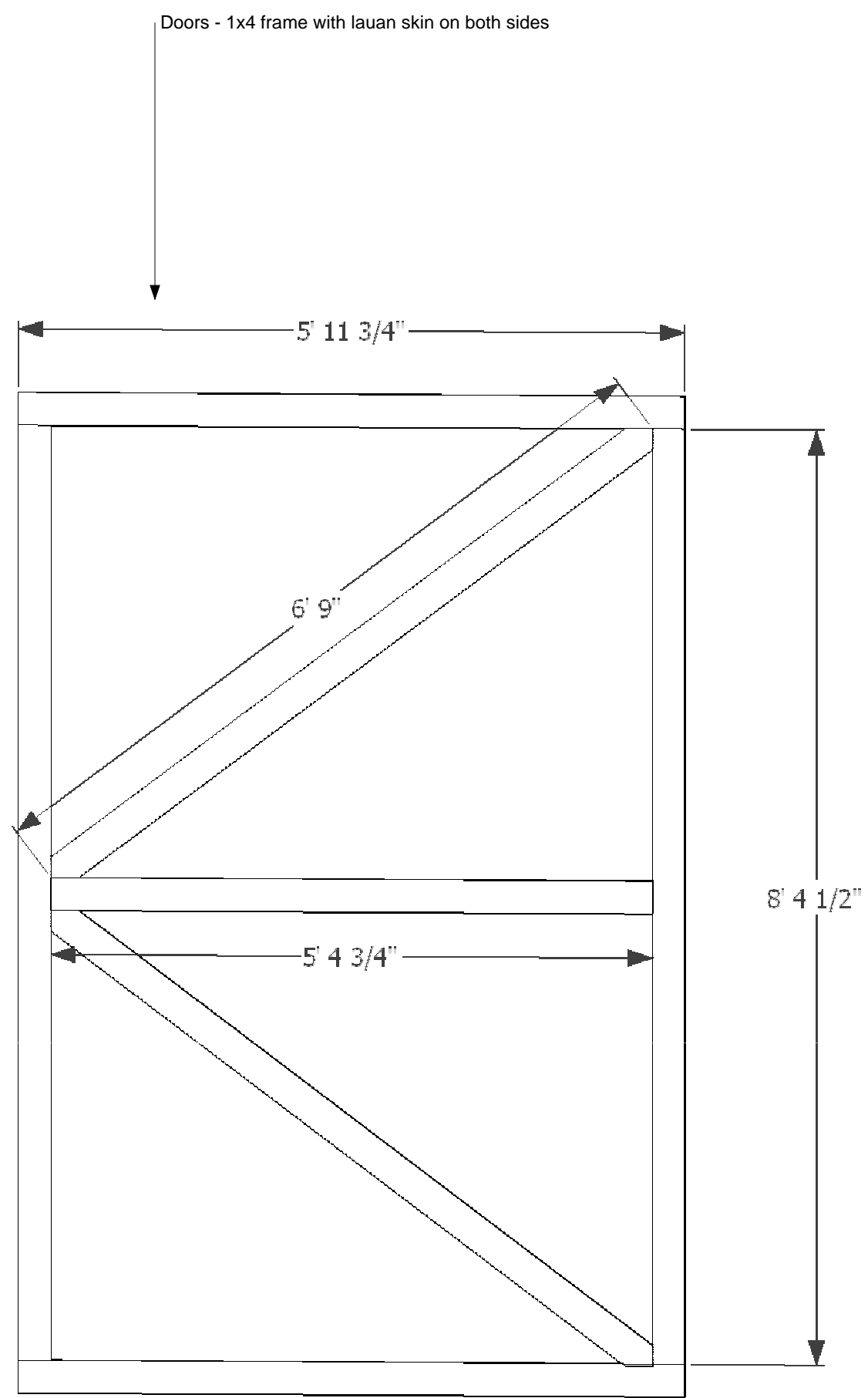

UC wagon - 2x4 framing with 5/8" plywood decking

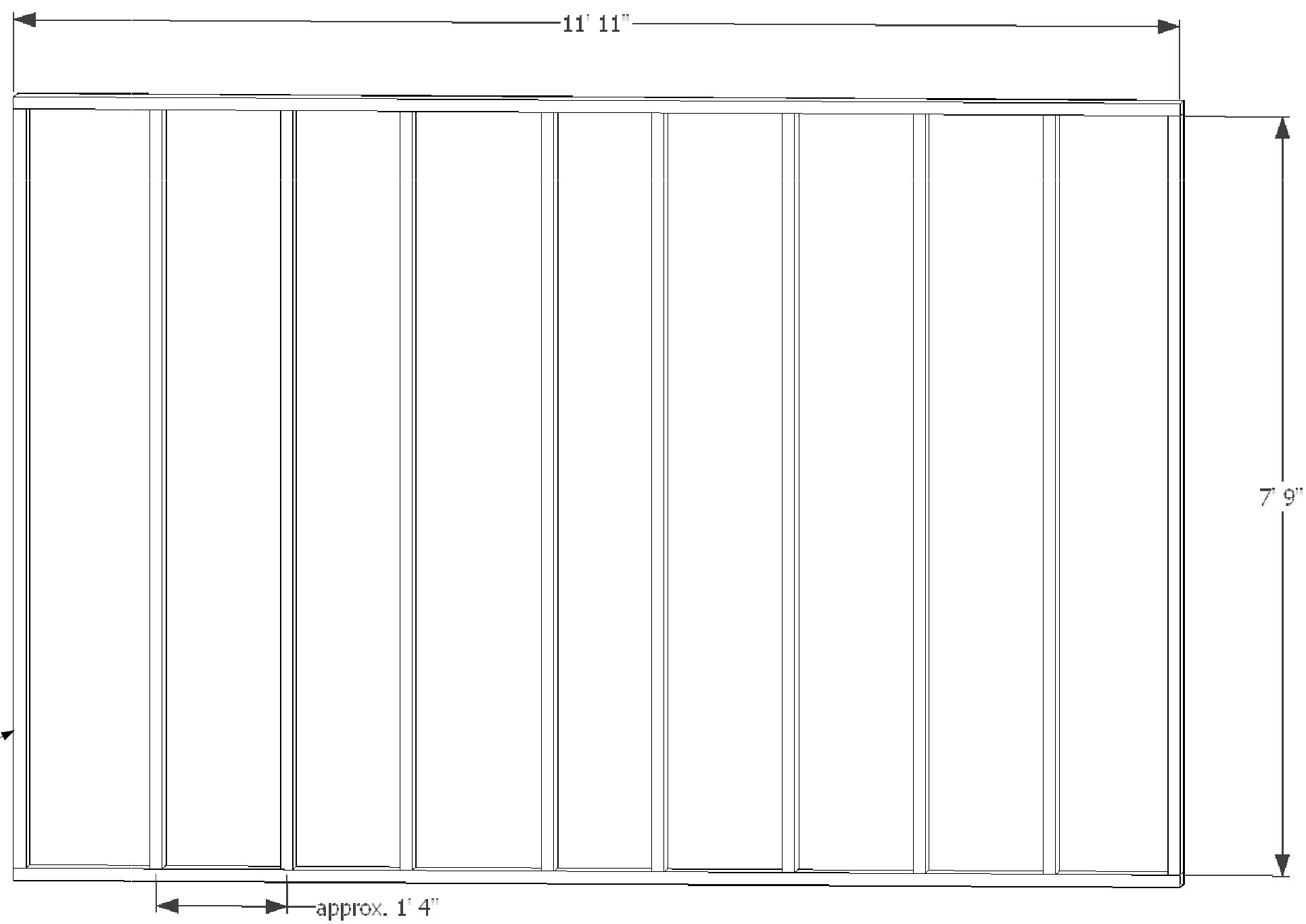

# FOOTLOOSE

Canterbury - Spring 2013

DIRECTOR: Tara Quellhorst

SCENIC DESIGNER: Richard Miller

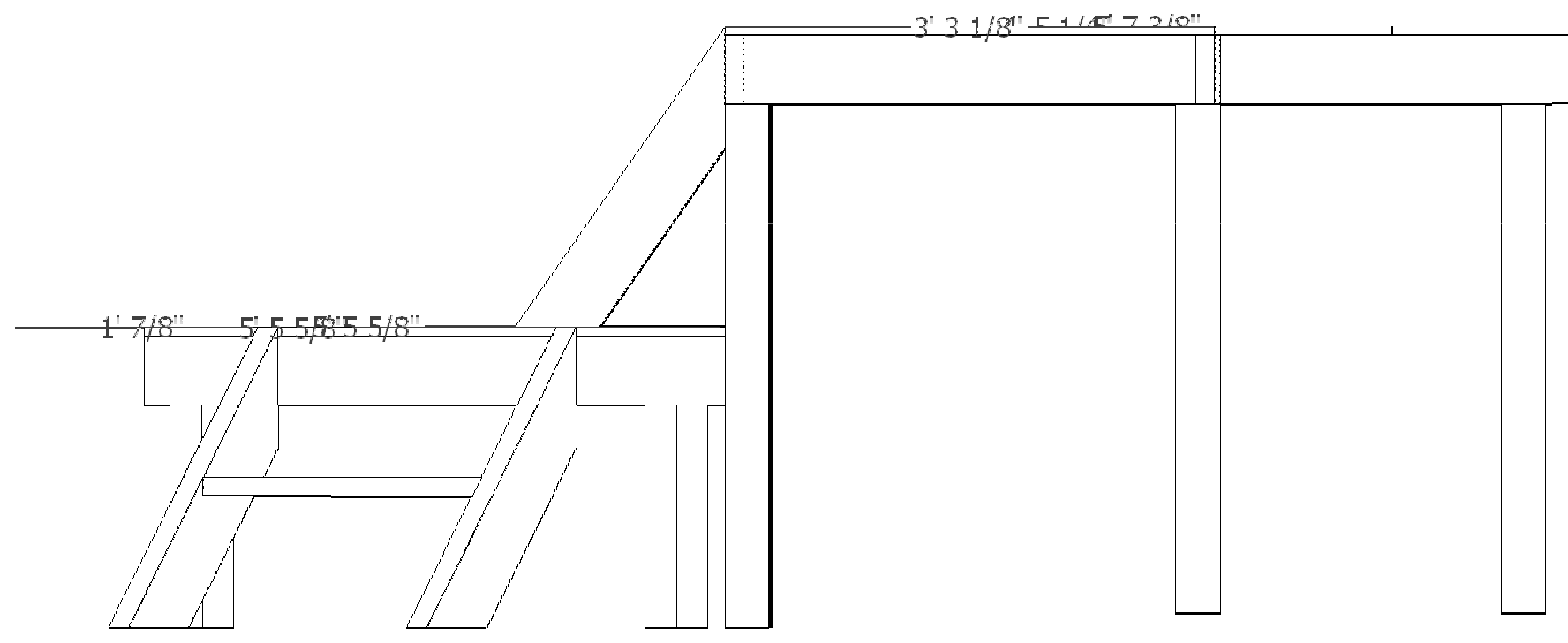
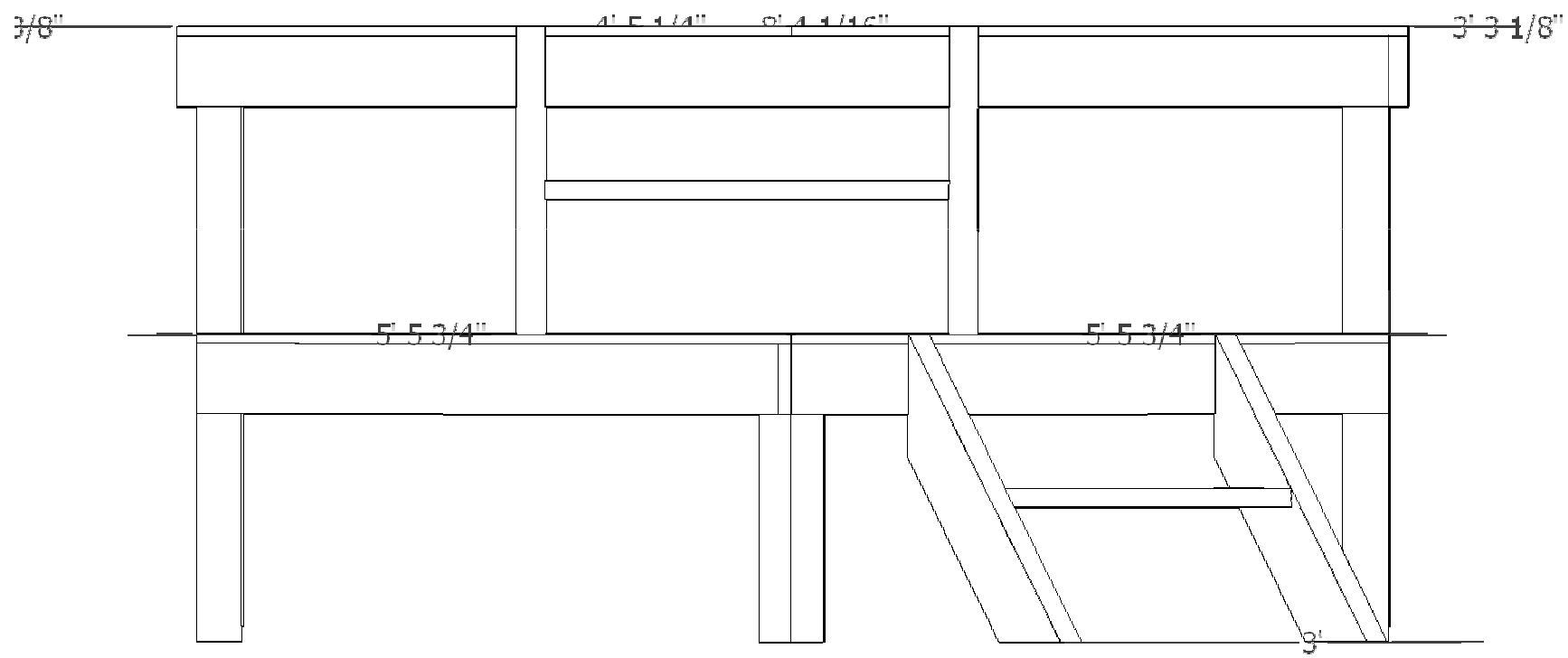

# FOOTLOOSE

Canterbury - Spring 2013

DIRECTOR: Tara Quellhorst

SCENIC DESIGNER: Richard Miller



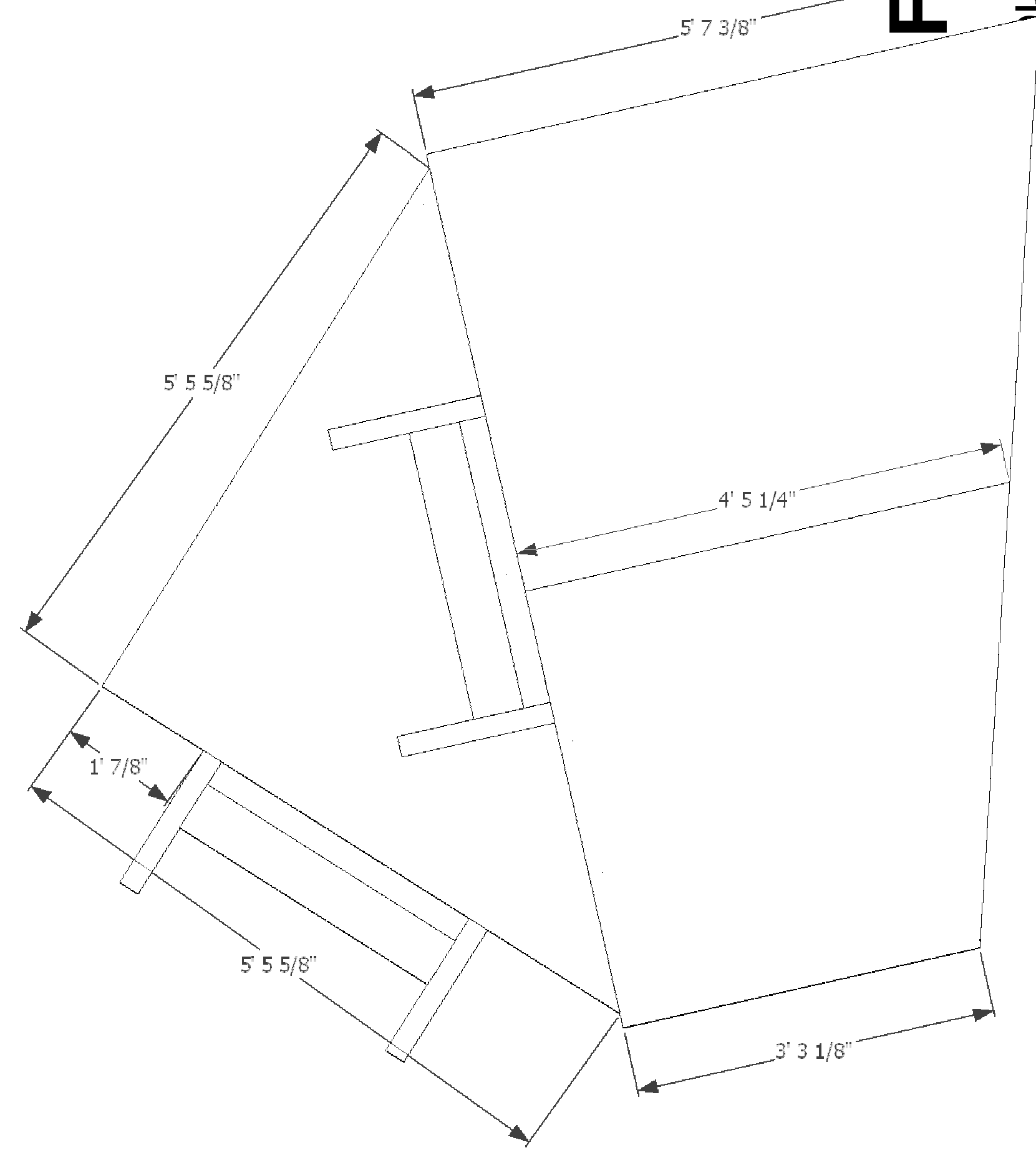
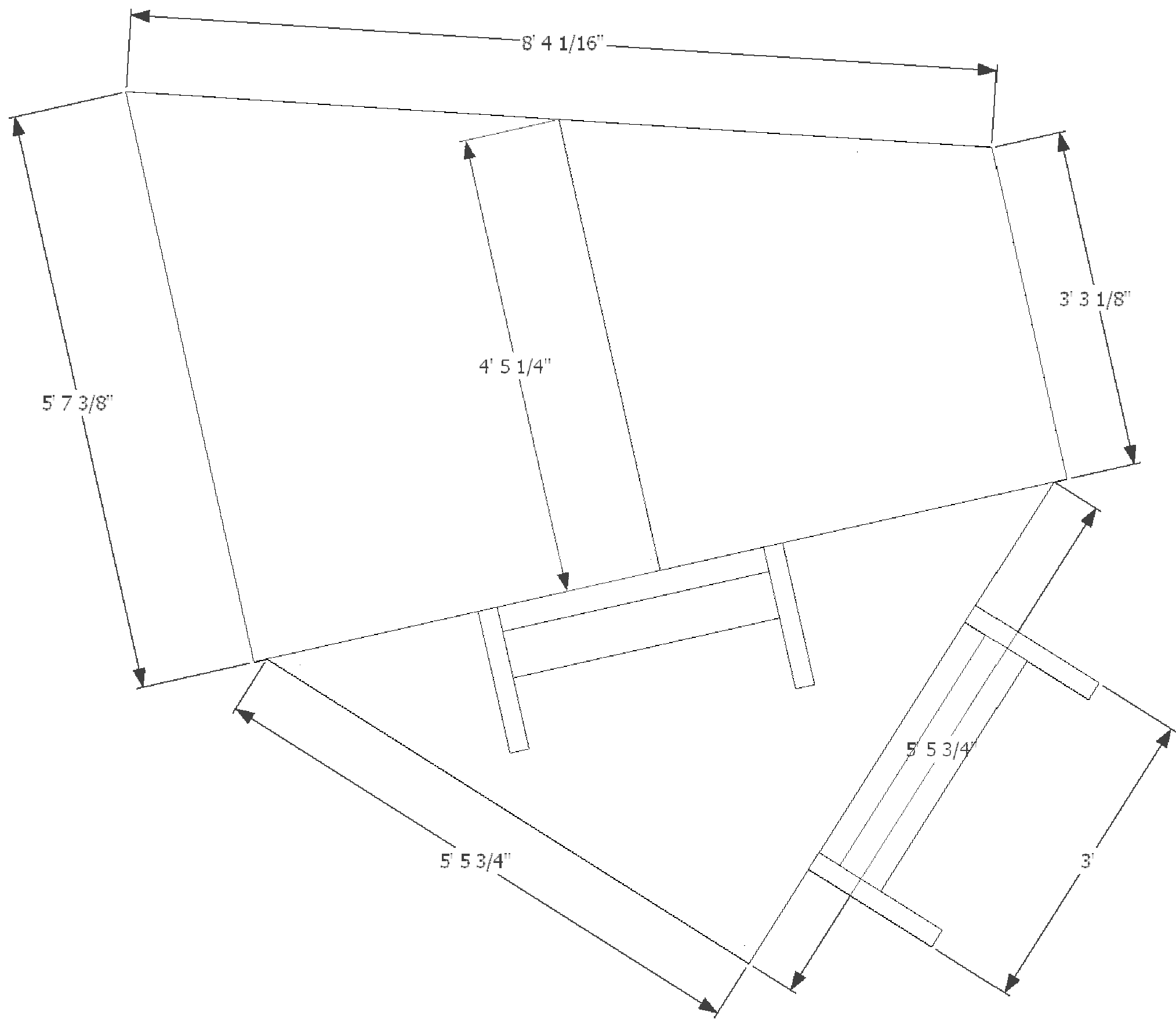

# FOOTLOOSE

Canterbury - Spring 2013  
 DIRECTOR: Tara Quellhorst  
 SCENIC DESIGNER: Richard Miller

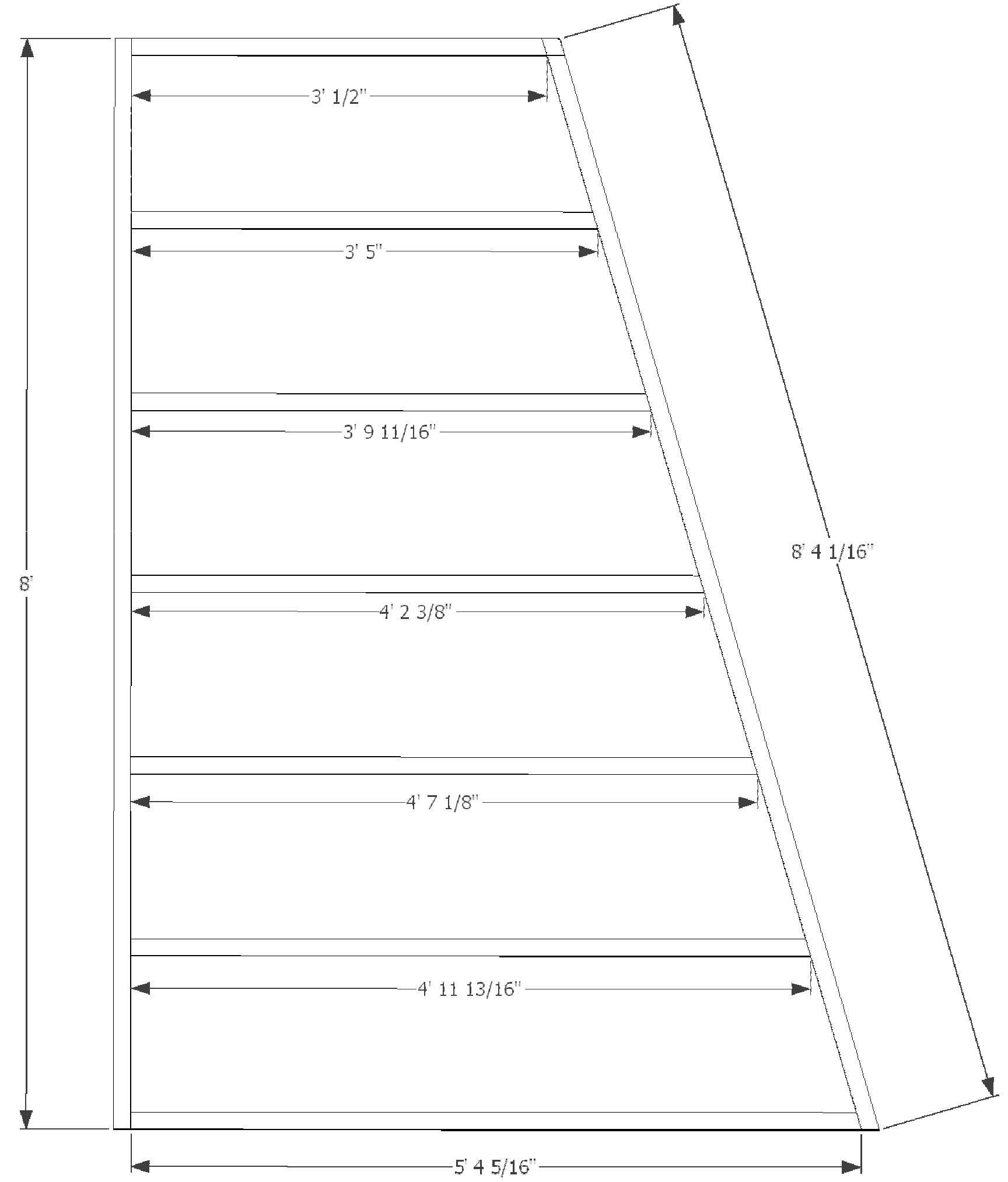
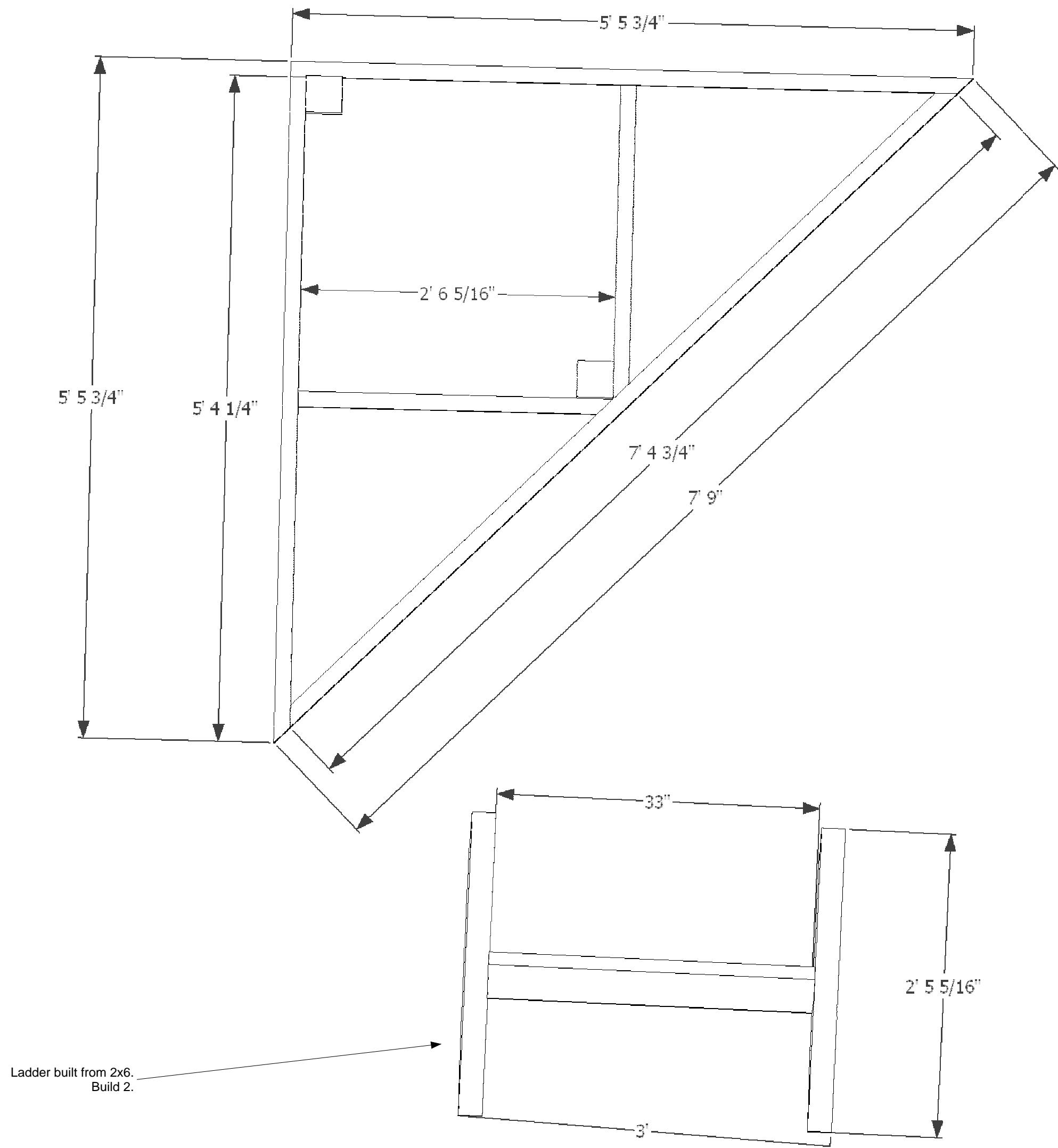

# FOOTLOOSE

Canterbury - Spring 2013  
 DIRECTOR: Tara Quellhorst  
 SCENIC DESIGNER: Richard Miller

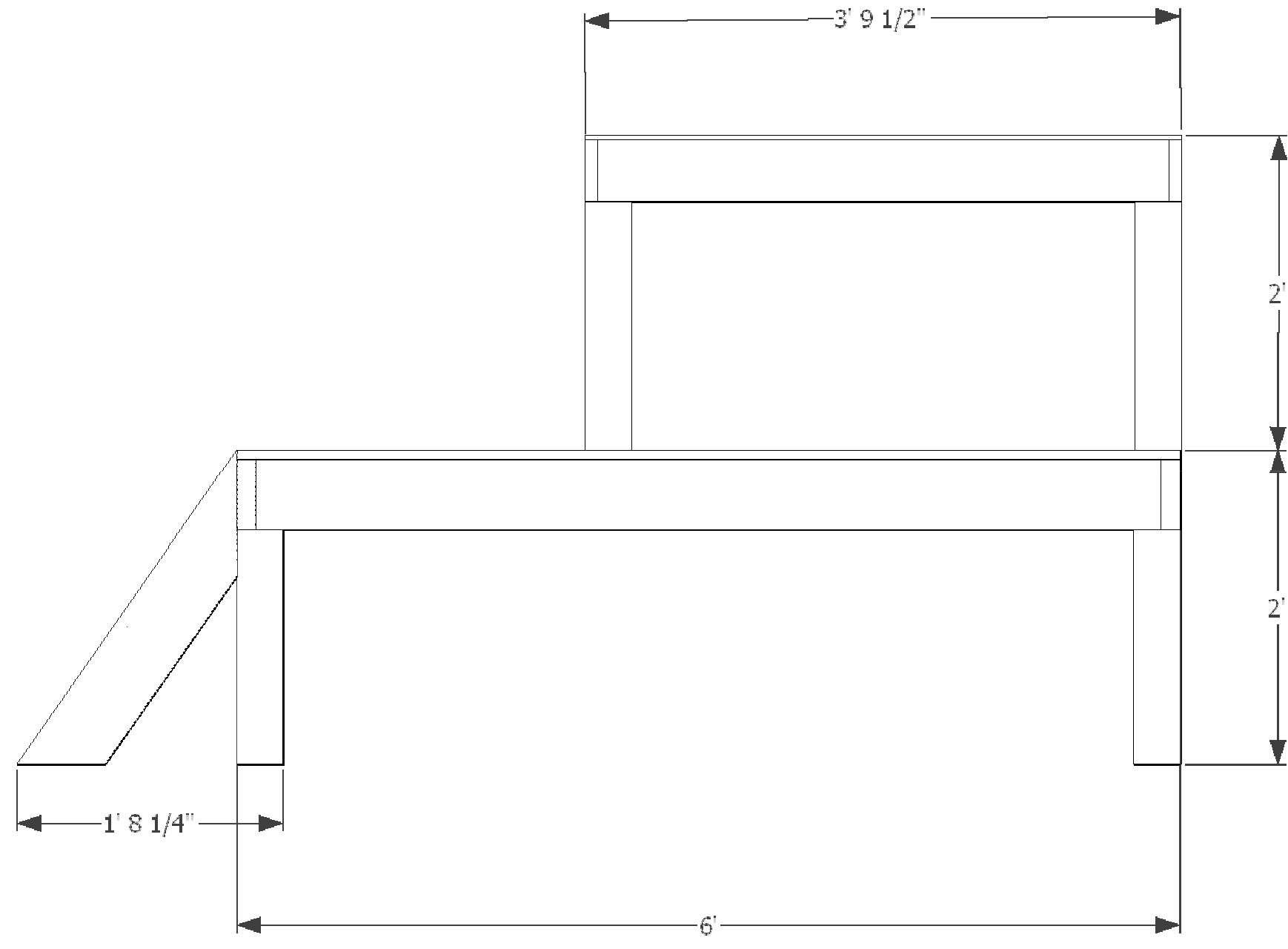
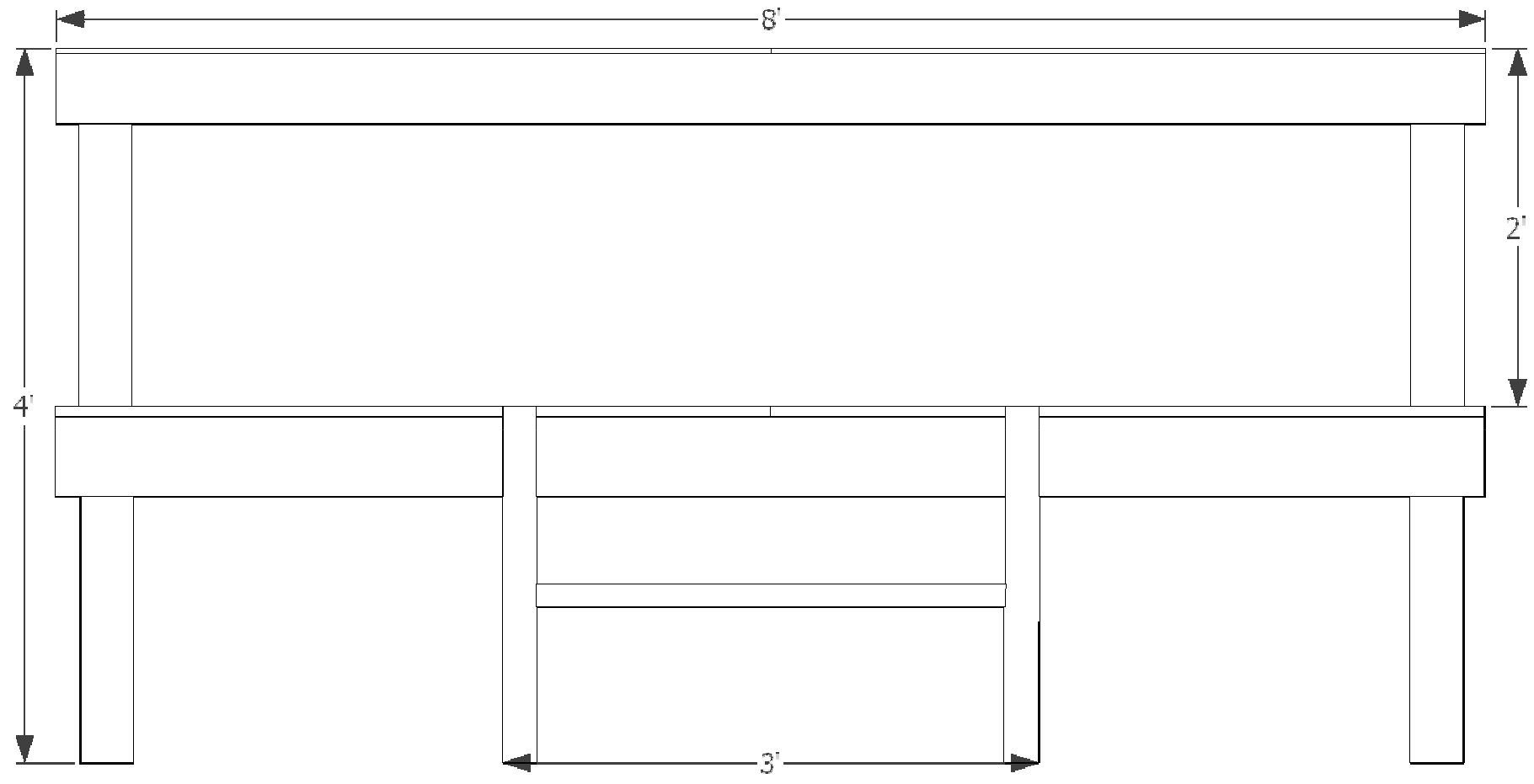

**FOOTLOOSE**  
 Canterbury - Spring 2013  
 DIRECTOR: Tara Quellhorst  
 SCENIC DESIGNER: Richard Miller

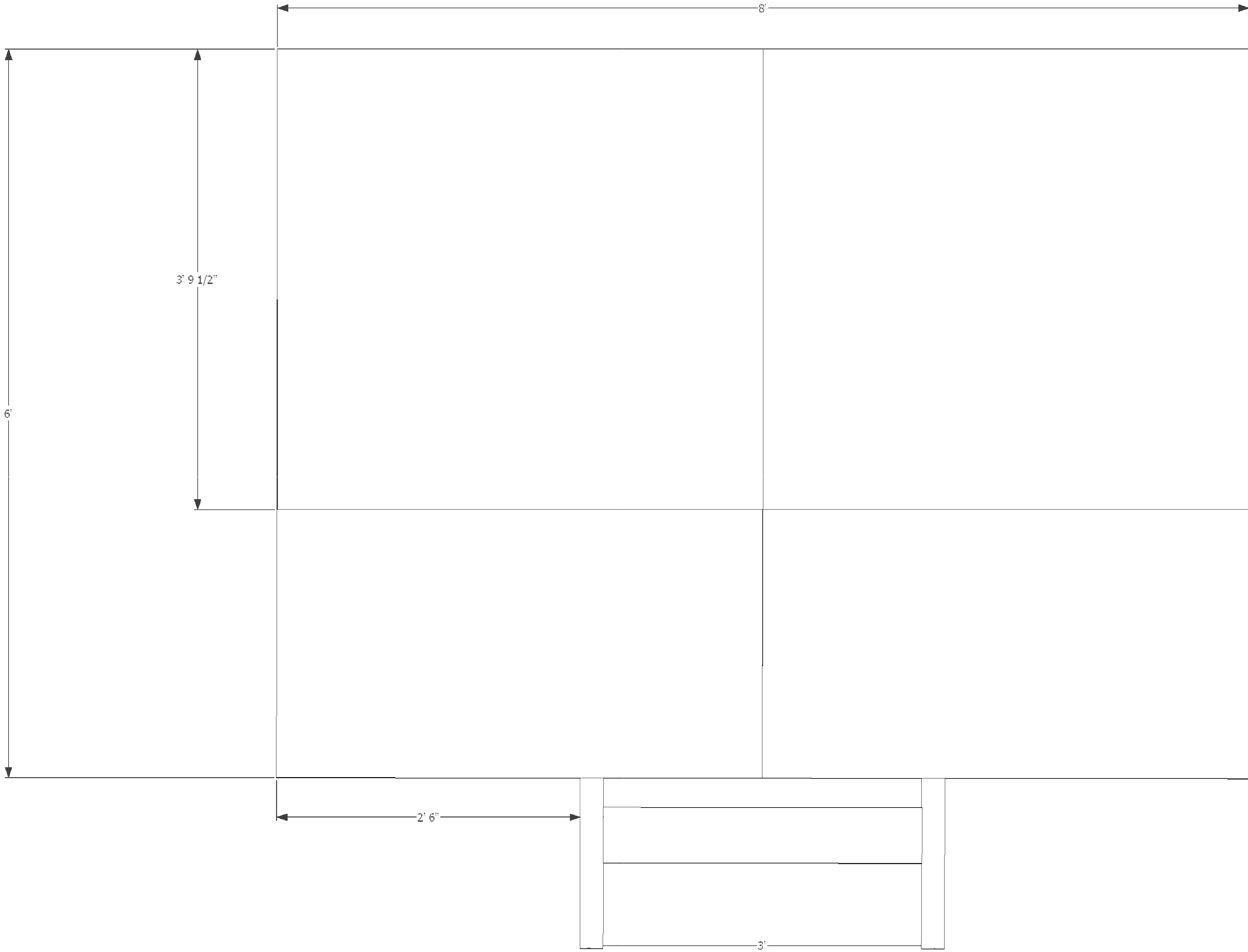

# FOOTLOOSE

Canterbury - Spring 2013

DIRECTOR: Tara Quellhorst

SCENIC DESIGNER: Richard Miller

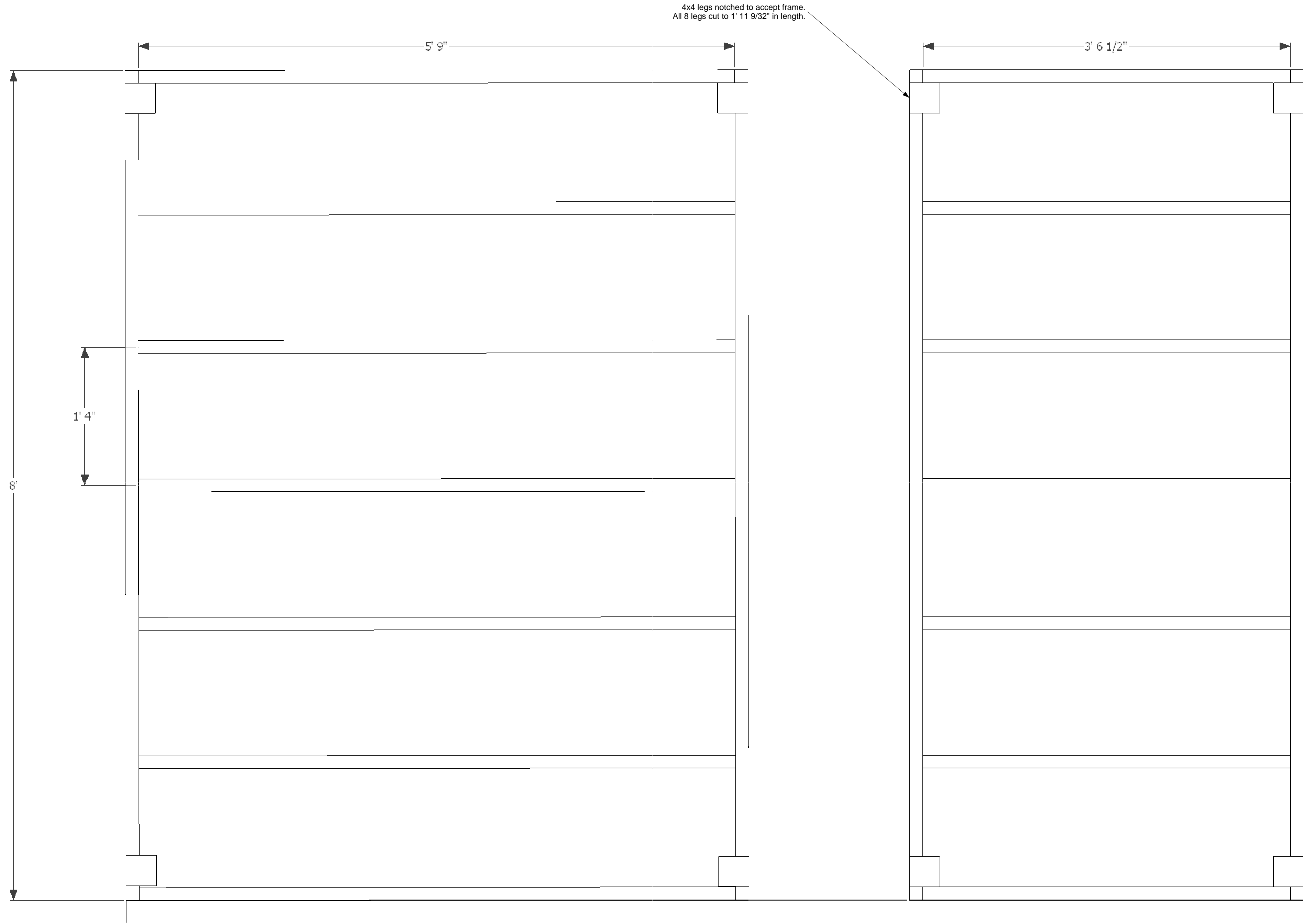

**FOOTLOOSE**  
Canterbury - Spring 2013  
DIRECTOR: Tara Quellhorst  
SCENIC DESIGNER: Richard Miller