

LONGITUDINAL SECTION

Original 1:100.

This section narrates the possible inhabitation of the catwalk as it unfolds through the entire complex.

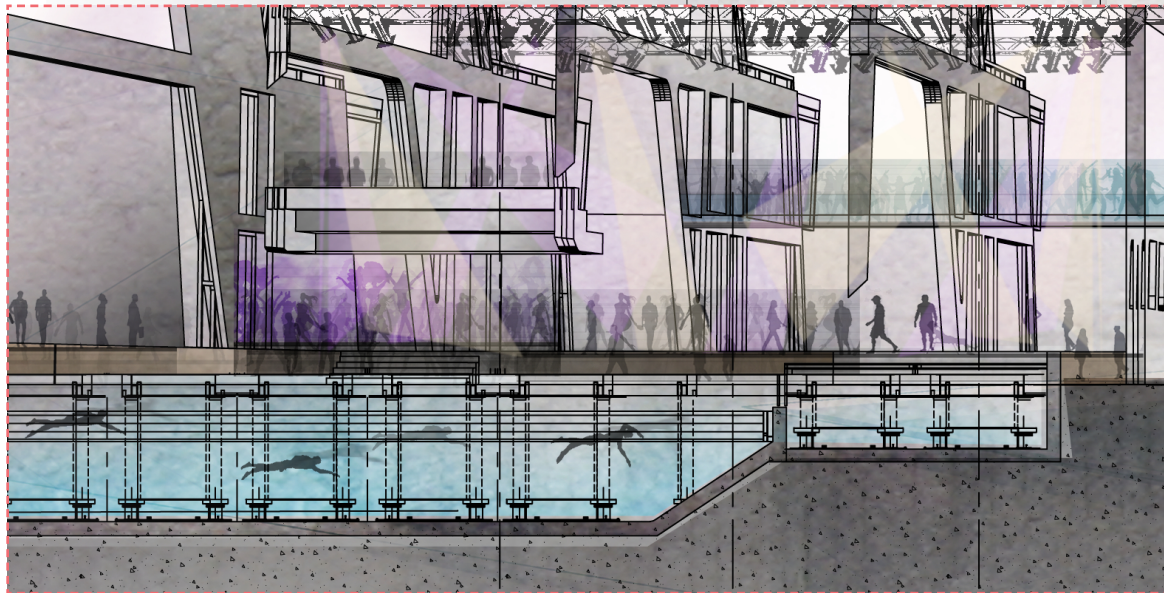
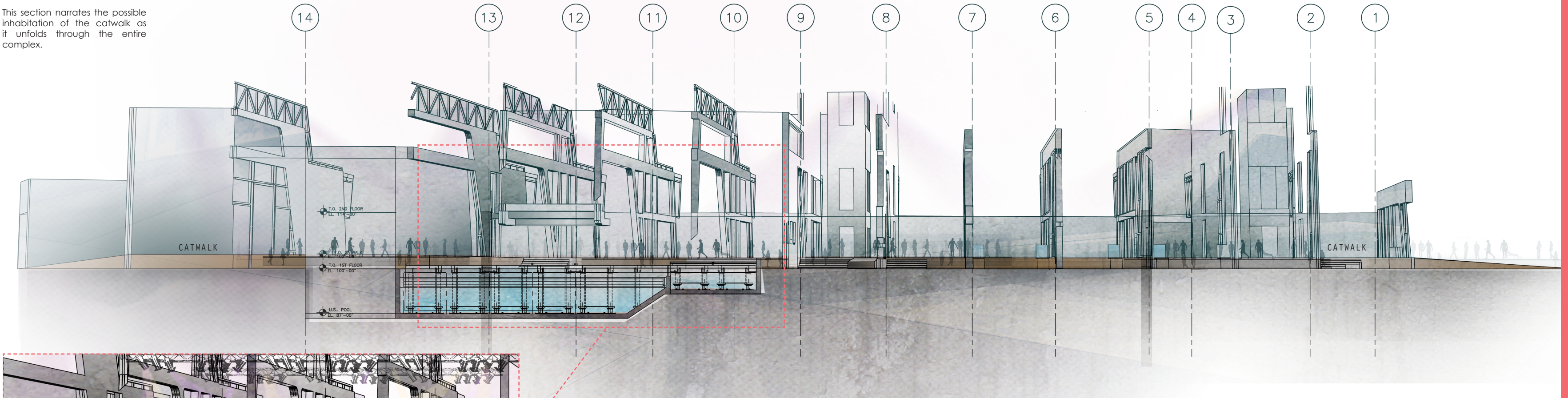

LONGITUDINAL SECTION  
Close up. Original 1:100.

*"The pedestrian in the city moves freely between these two realms, whether these spaces are public or semi public. The pedestrian understands their inherent difference as openness and enclosure. In memory and experience the two realms become entwined."<sup>9</sup>*

The constant back and forth between the two realms, as will be explored through the project, relates back to the concept of escapism in which one moves between the realms of cognitive reality and that of an escapist, alternate state.

<sup>9</sup> Bednar, Michael J., *Interior pedestrian places*. 1. publ. ed. New York, NY: Whitney Library of Design, 1989.

