



*A magnificent location for extraordinary events, Rosewood Mansion on Turtle Creek® brings history to life in the heart of Dallas. The residentially styled hotel is an exceptional destination for meetings and corporate events as well as a sought-after location for memorable social celebrations. Complemented by the Mansion's award-winning cuisine and impeccable service, the hotel's elegant function rooms and facilities include a ballroom, promenade, four private dining and meeting rooms, and an intimate wine cellar.*

143

ROOMS + SUITES

7

EVENT SPACES

2

RESTAURANTS + BARS

ROSEWOOD  
MANSION ON TURTLE CREEK®  
DALLAS

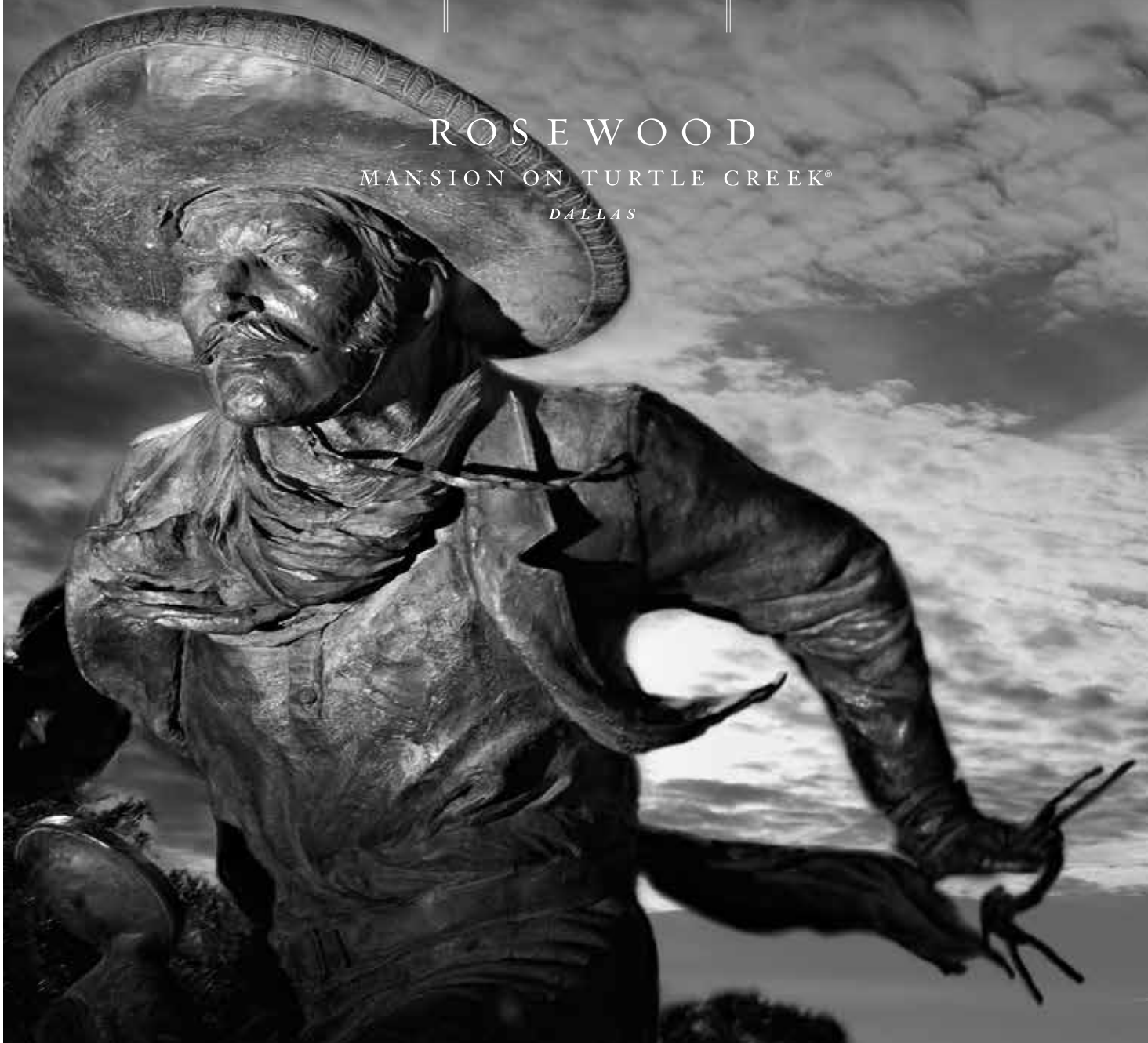



### Private Dining, Meeting & Banquet Facilities

- 9,288 square feet of indoor/outdoor meeting and event space across seven elegant venues including a ballroom, private dining rooms and a wine cellar
- Suitable for an array of occasions, the residentially styled rooms range from the intimate to the grand and accommodate up to 400 guests
- Wired and wireless high-speed Internet access and full audio/visual services

### Pavilion Ballroom

Decorated in a contemporary residential style, the Pavilion Ballroom offers 2,232 square feet of space and accommodates events for up to 300 people. Adjoining the sun-drenched Promenade reception foyer, the ballroom is divisible into three separate suites, each able to host up to 70 guests for smaller events.

### Promenade

The beautiful reception foyer of the Pavilion Ballroom features dazzling windows and elegant chandeliers. Awash in abundant natural light, the Promenade is reminiscent of a glamorous residential conservatory, providing a garden-like setting for lunches, dinners and receptions.

### Sheppard King Suite

Guests enjoy a breathtaking view of Turtle Creek from the spacious Sheppard King Suite. An ideal venue for elegant parties, receptions and meetings, the suite has the added appeal of an outdoor terrace. The suite comfortably seats 70 people for dining and can host up to 100 guests for a reception.

### FDR Suite

A welcoming venue offering 272 square feet of space, the intimate FDR Suite is designed for smaller parties and meetings. The room's French doors overlook the hotel's landscaped courtyard and provide access to a terrace that can be utilized for meeting breaks and cocktail receptions.

### Burford Suite

A specially designed boardroom for executive conferences, the Burford Suite is ideal for quiet, productive business gatherings.

### Hunt Suite

The 437-square-foot Hunt Suite, ideal for dining, receptions and meetings, is a residentially styled function space featuring a private entry foyer and faux fireplace.

### Wine Cellar

An intimate and elegant setting unequalled in Dallas, the Wine Cellar is a splendid venue for small gatherings of up to 14 guests. Originally built as a vault beneath the family home to store silver and other heirlooms, the wood-lined cellar now houses the hotel's enviable wine collection.

### Accommodation

The Mansion's guestrooms reflect the hotel's residential sensibilities and comfortably chic atmosphere. The 128 rooms offer modern interior styling, elegant furnishings and local artwork, while 15 sumptuous suites offer ample space for relaxing and entertaining. All accommodations feature thoughtful amenities such as a private balcony, 42" plasma TV, SoundBar with sound system, private bar and custom bath products by Natura Bissé.

### Dining

- **THE MANSION RESTAURANT:** Long-hailed as Dallas' best fine dining experience, this restaurant delights guests with refined contemporary American cuisine highlighted by French technique and regional ingredients and flavors. For alfresco dining, cocktails and lounging, the picturesque restaurant terrace presents a breezy, lantern-lit setting beneath a canopy of majestic oak trees.
- **THE MANSION BAR:** An icon of the Dallas scene, the bar offers the ambience of a stylish private club with a modern twist.

	Square feet	Size in feet	Ceiling	Reception	Dining	Theatre	Classroom	Conference
<b>First Floor</b>								
Pavilion Ballroom	2,232	62x36	10'	250	180	300	120	72
Pavilion I	828	23x36	10'	70	60	75	32	24
Pavilion II	684	19x36	10'	70	60	75	32	24
Pavilion III	720	20x36	10'	70	60	75	32	24
Pavilion & Promenade	3,704	62x59	10'	400	300	-	-	-
Promenade	1,472	62x23	10'	150	120	150	64	48
<b>Second Floor</b>								
Sheppard King Suite	1,060	53x20	9'2"	100	70	110	56	40
Sheppard King I	558	31x19	9'2"	50	30	50	26	18
Sheppard King II	483	23x21	9'2"	50	40	50	26	18
FDR Suite	272	16x17	9'2"	25	20	30	16	16
Burford Suite	228	12x19	9'2"	20	10	-	-	10
Hunt Suite	437	19x23	8'8"	40	40	42	24	22
<b>Lower Level</b>								
Wine Cellar	336	16x21	7'1"	30	14	-	-	14

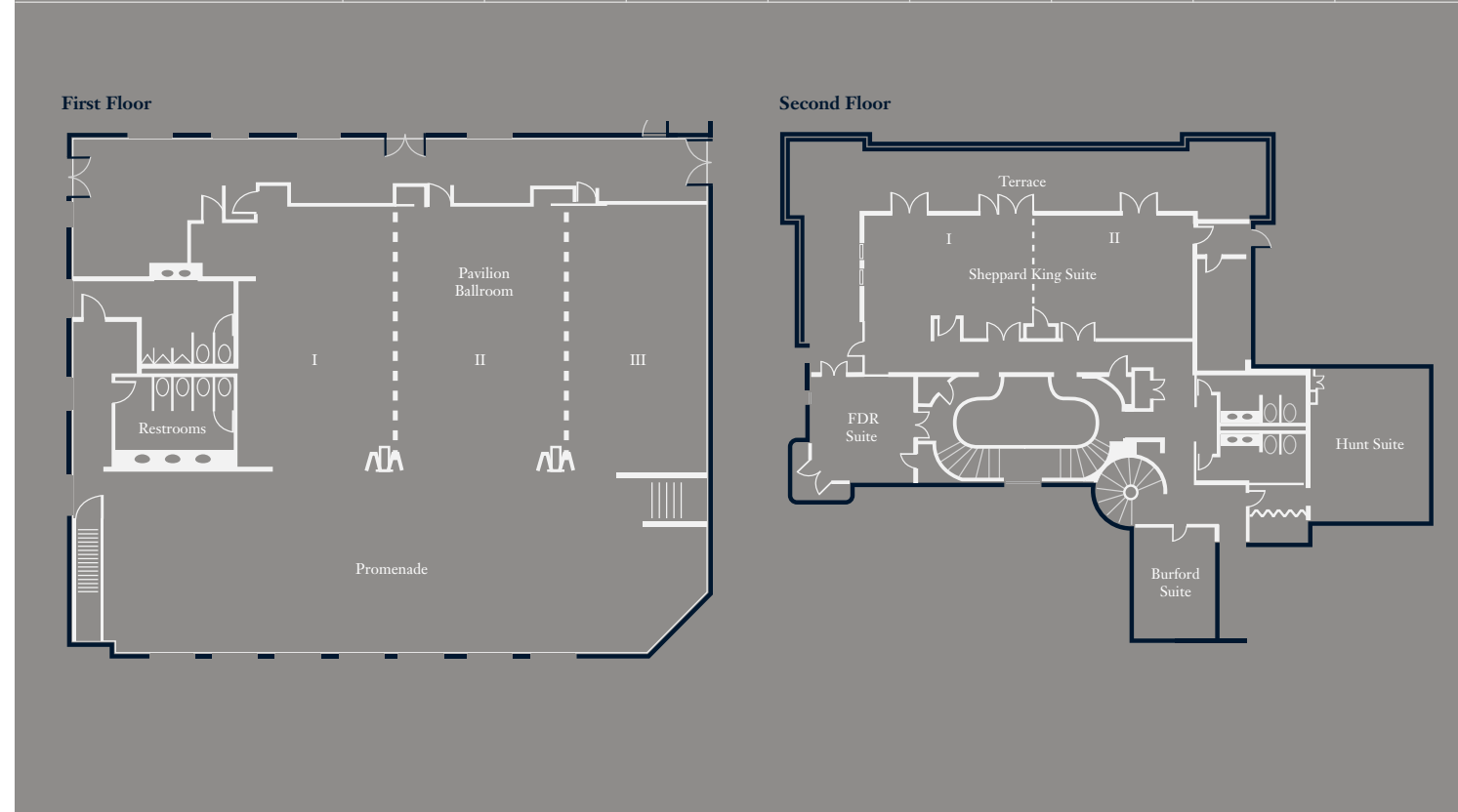



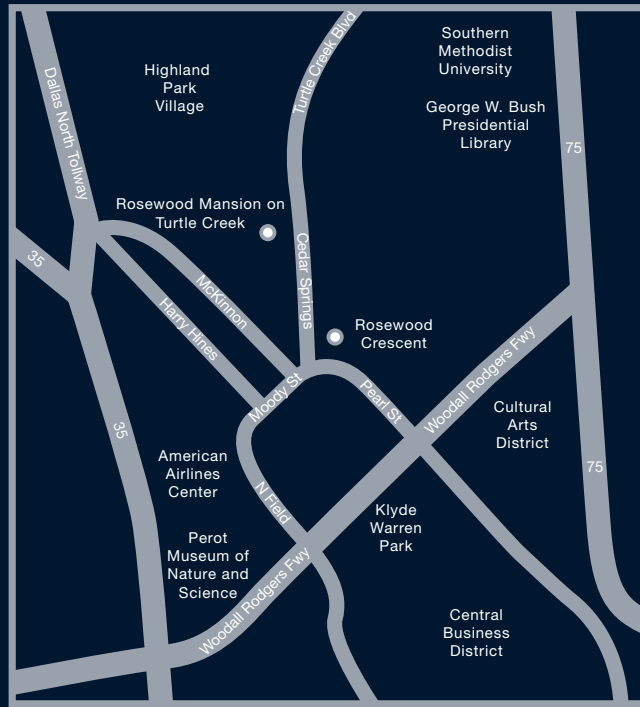

## ROSEWOOD MANSION ON TURTLE CREEK

TEL: +1 214 559 2100 | FAX: +1 214 528 4187

[ROSEWOODHOTELS.COM/MANSION](http://ROSEWOODHOTELS.COM/MANSION) | [THEMANSION@ROSEWOODHOTELS.COM](mailto:THEMANSION@ROSEWOODHOTELS.COM)

---

### ROSEWOOD SALES OFFICES

NEW YORK	+1 212 593 2252
LOS ANGELES	+1 310 843 9097
DALLAS	+1 214 880 4231
CHICAGO	+1 312 643 2203
MIAMI	+1 954 507 6188
LONDON	+44 203 189 2126
DUBAI	+971 4 380 6400
BEIJING	+86 10 6536 0187
SHANGHAI	+86 21 3133 5993

2821 TURTLE CREEK BLVD

DALLAS, TEXAS 75219

USA