

Handrail fixing in concrete tread 1:10

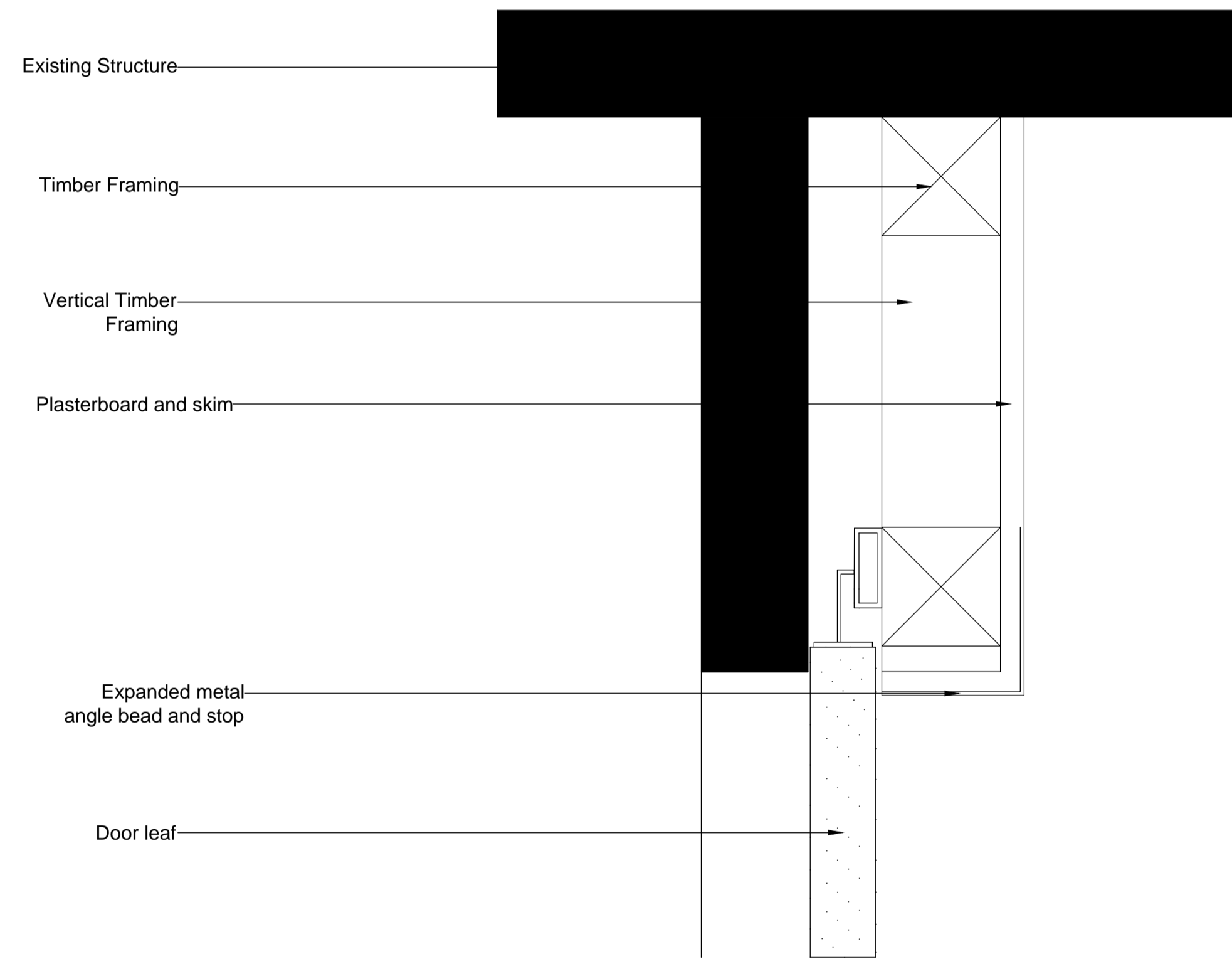

Head of sliding door - 1:10

GENERAL NOTES

(A)

# REVISION

| NUMBER | DATE | AMMENDMENT DESCRIPTION |
|--------|------|------------------------|
|        |      |                        |
|        |      |                        |
|        |      |                        |

|  |   |
|--|---|
| <b>MV</b>  |   |
| Mehak Verma Design<br>Jennens Court, 250 Jennens Road Birmingham, United Kingdom B5 5JR<br>Tel: 07446718844<br>Email: mehakverma@hotmail.com |   |
| CLIENT:  |   |
| PROJECT:   | The Heroes of The World<br>Museum of Good<br>Design Ethics                                |
| DRAWING:   | Section through handrail fixing in concrete tread<br>Section through head of sliding door |
| DATES:   | 12 May 2014<br>Revision notes as dated  |
| SCALE:   | As Indicated - @ A1<br>See appropriate drawn elements                                     |
| DRAWN BY:  | Mehak Verma   |
| PROJECT NO:  | 2014 / L5/3   |
| DRAWING:   | 2 of 2  |

This drawing is the property of BCU BIAD Design Consultants Limited. Copyright is reserved by them and the drawing is issued on the condition that it is not copied either wholly or in part without the written consent of BCU BIAD Design Consultants Limited. Do not scale from this drawing, use figured dimensions only. All dimensions to be checked on site before commencement of any work and or shop drawing. This is to be read in conjunction with all relevant design and construction drawings and specification of works.