

Contact us:
 tel: 416 535 5846
 fax: 416 535 1795
 email: info@cncutting.ca
 web: www.cncutting.ca

- Cabinet Mat. : **specify ...**
- Door Mat/Prof. : **specify ...**
- Edge Tape : **specify ...**
- Kick Type : **specify ...**
- Drawer Hdw. : **specify ...**
- Door Hdw. : **specify ...**
- Paint / Stain : **specify ...**
- Counter top : **specify ...**
- Assembled by : **specify ...**
- Installed by : **specify ...**
- Molding : **specify ...**
- Electrical : **specify ...**

Notes :

Cutting: Month

1	2	3	4	5	6	7
8	9	10	11	12	13	14
15	16	17	18	19	20	21
22	23	24	25	26	27	28
29	30	31				

Delivery: Month

1	2	3	4	5	6	7
8	9	10	11	12	13	14
15	16	17	18	19	20	21
22	23	24	25	26	27	28
29	30	31				

RAD002

Client : _____ Client / Company Name

Approved by: _____

Approved signature:

Detailed by : _____ Vukan Popovic

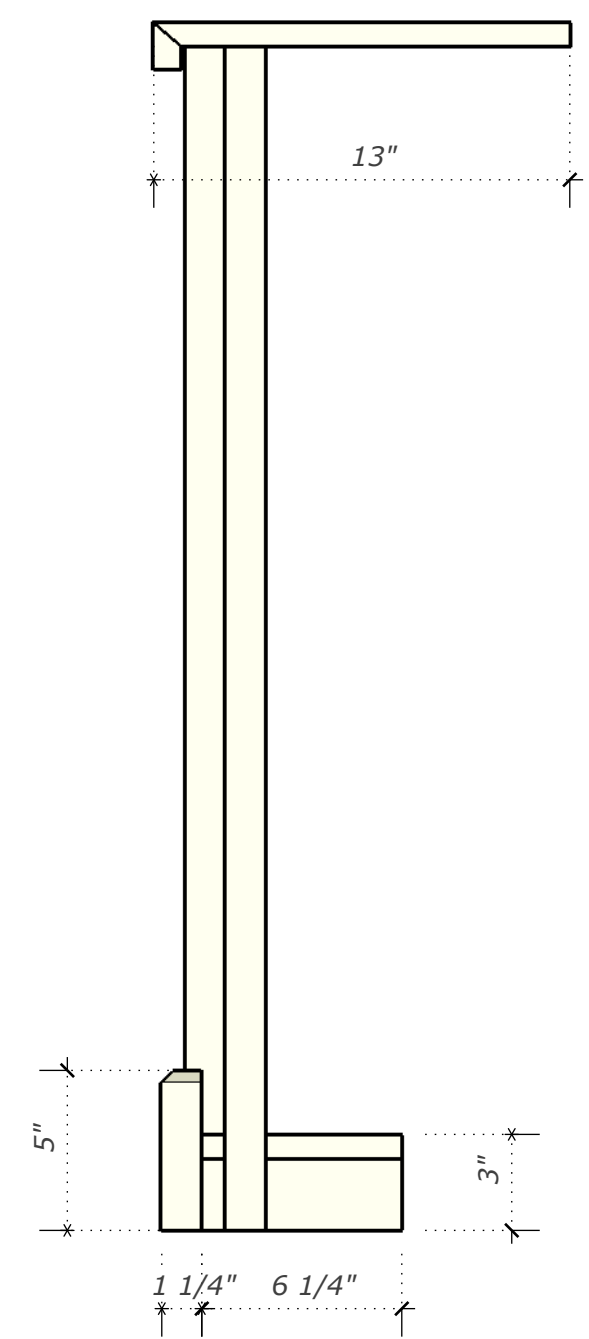
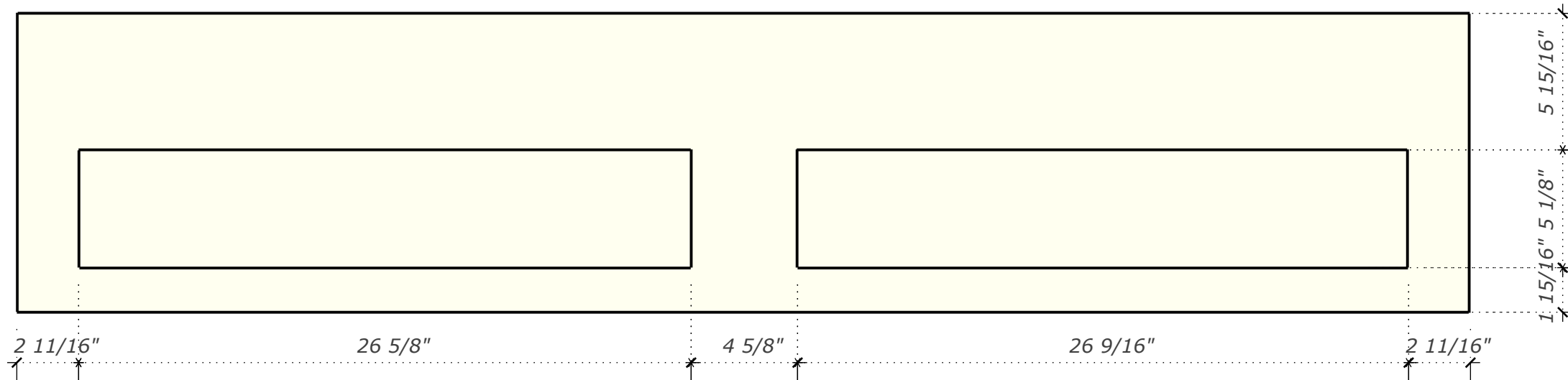
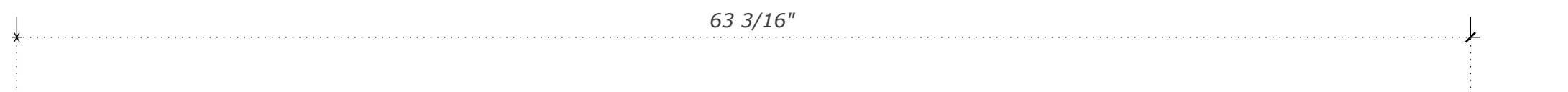
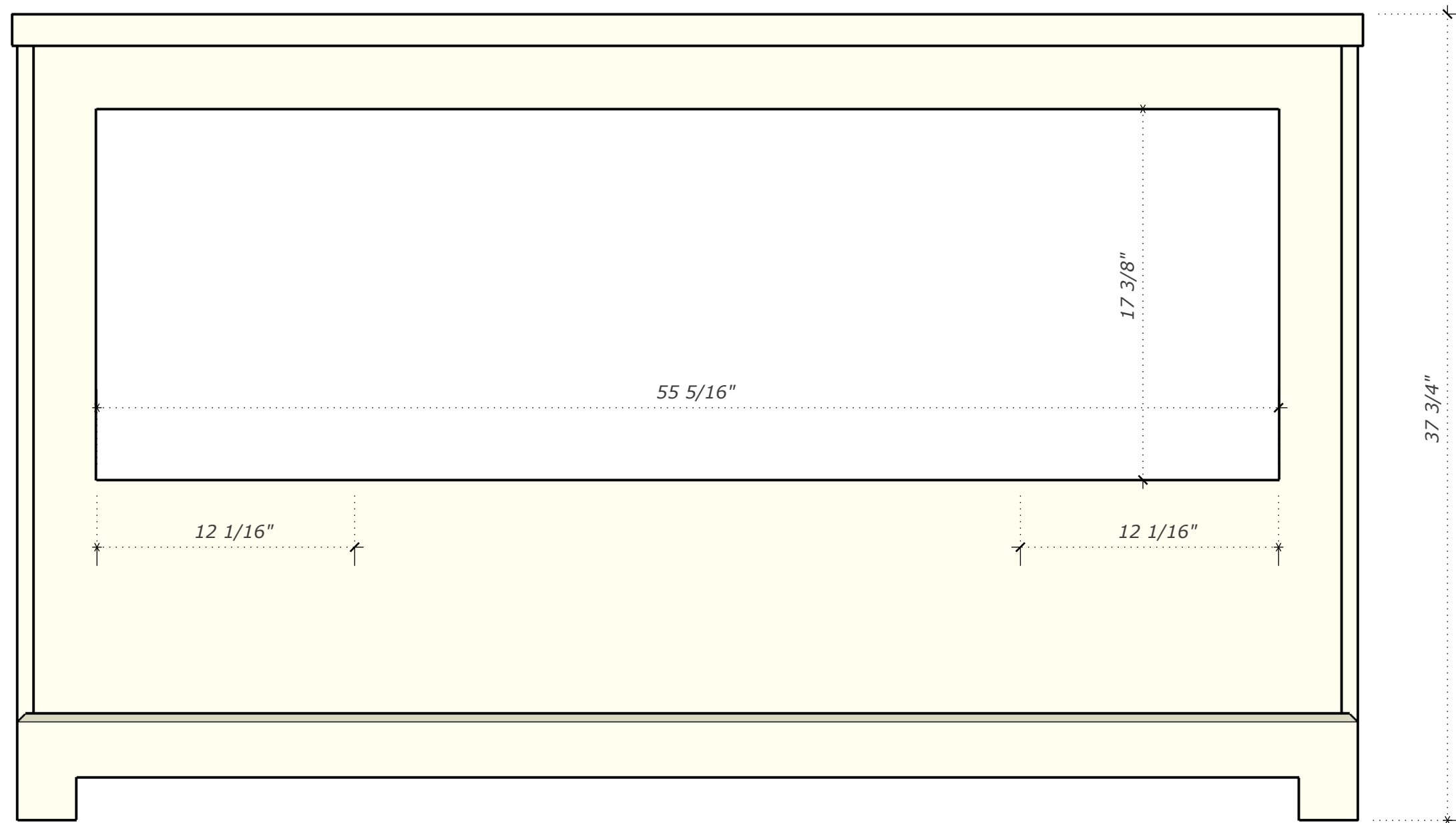

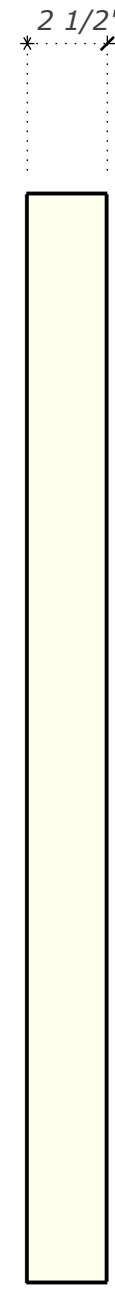
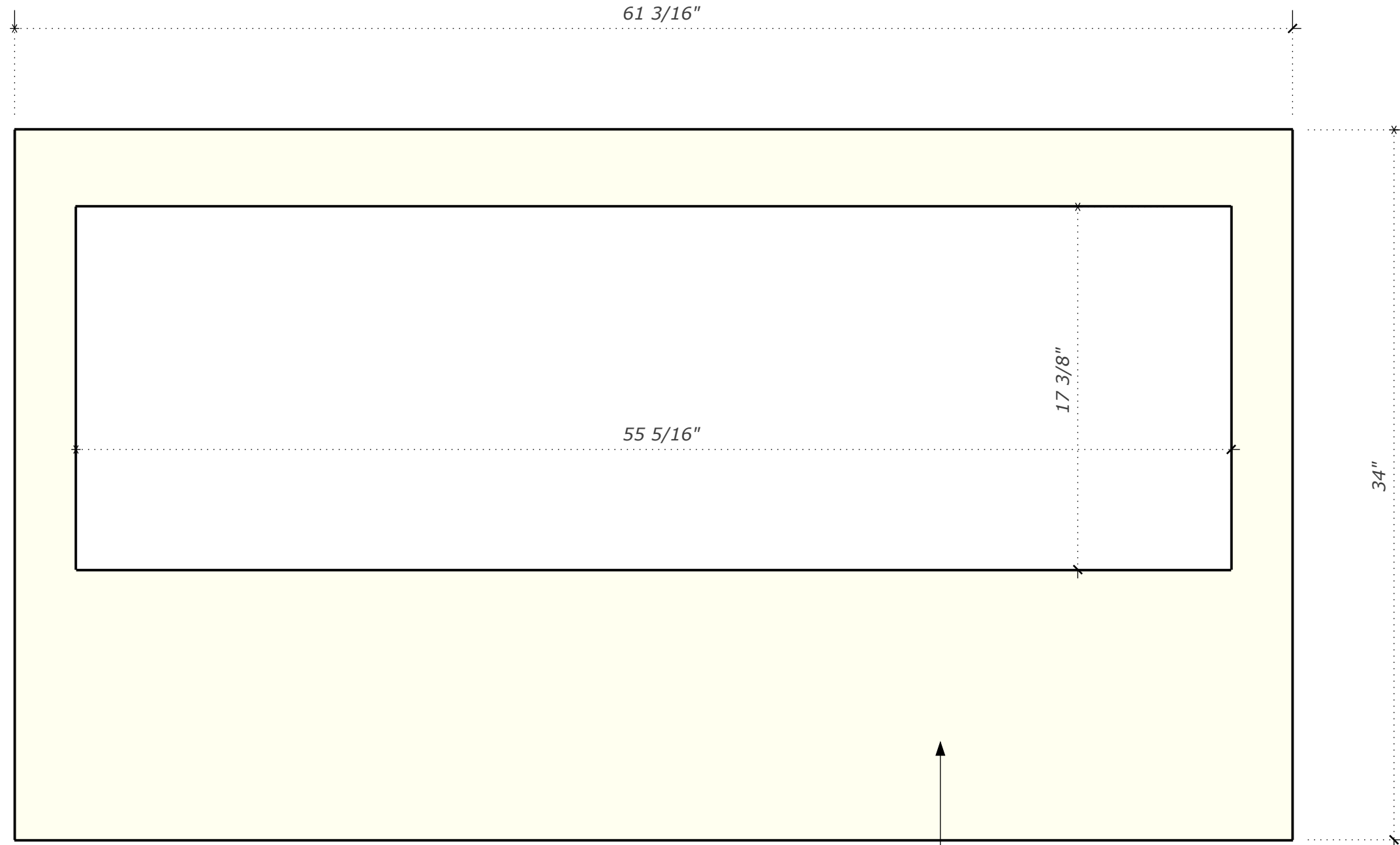
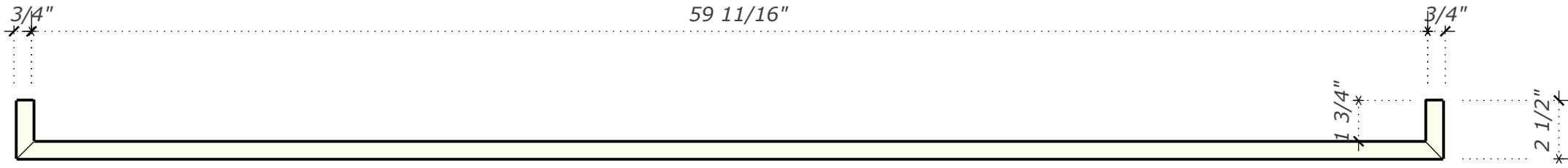

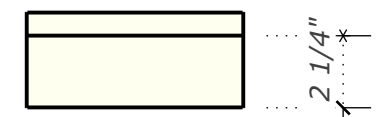
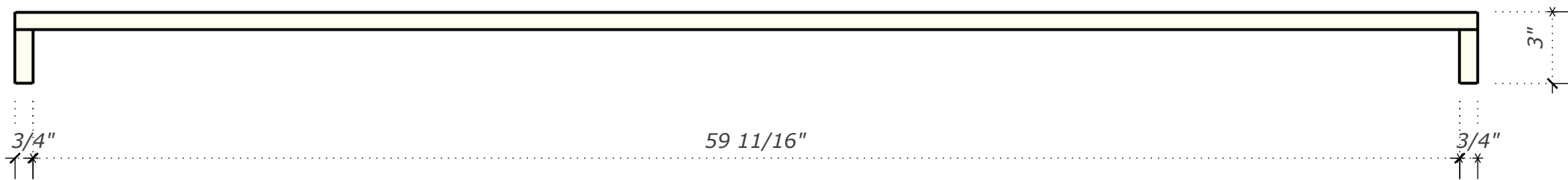
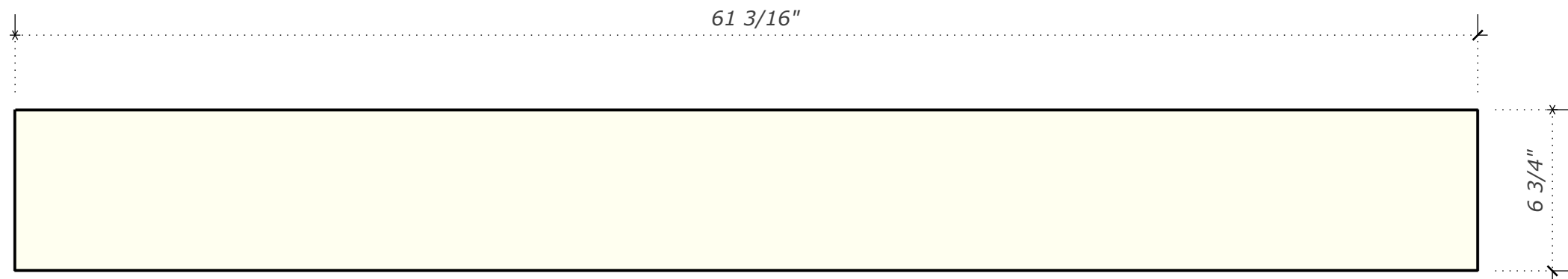
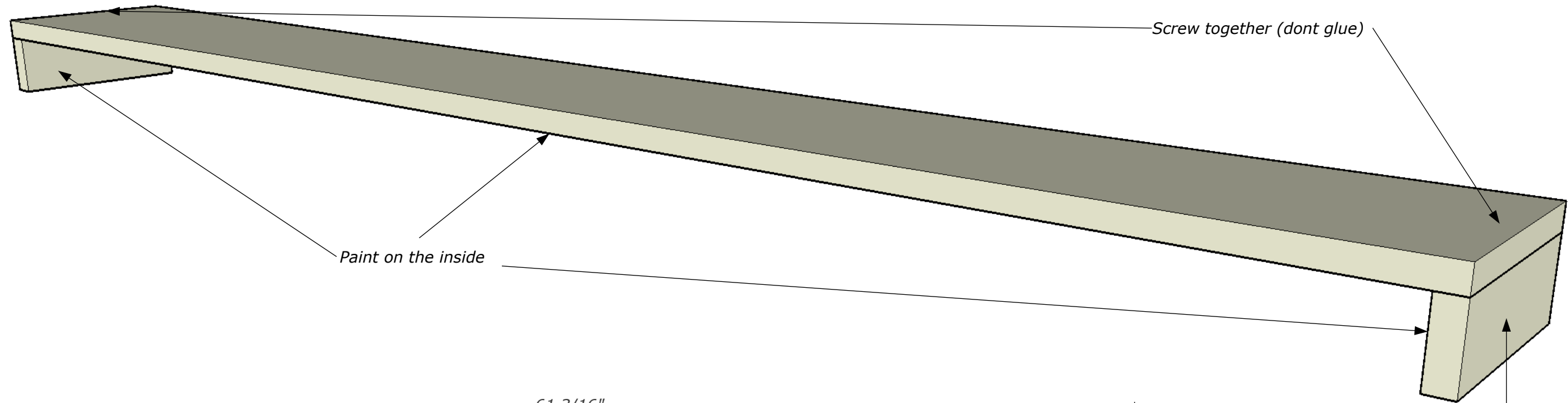

Whole piece made of MDF

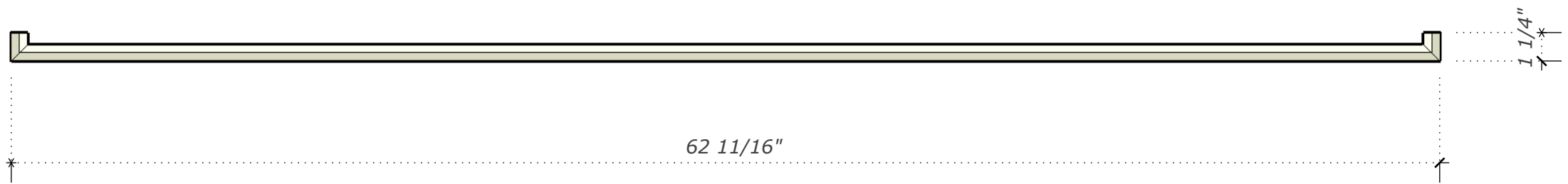
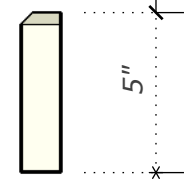
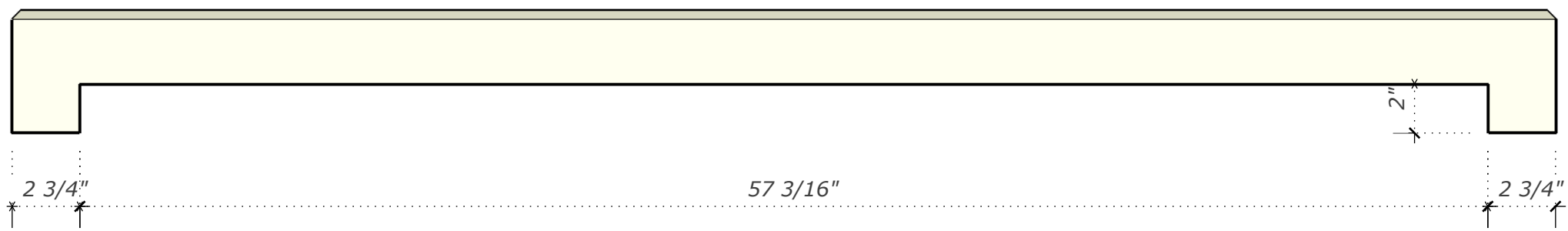
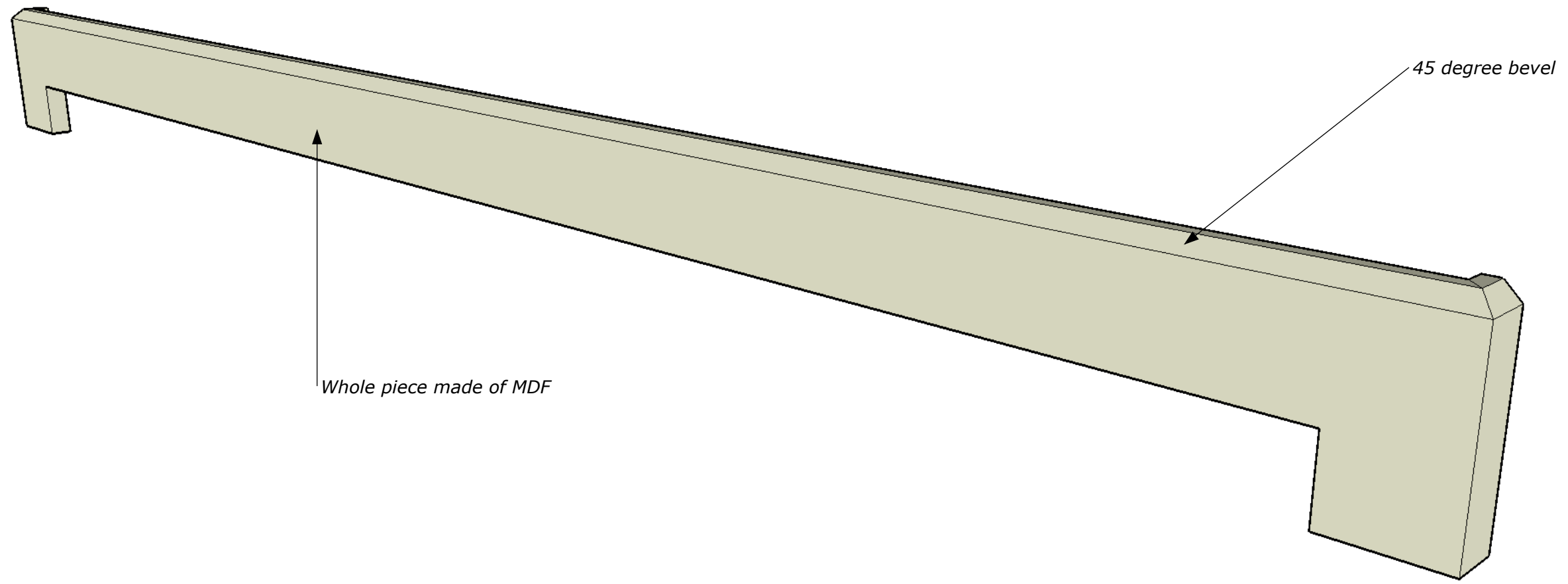

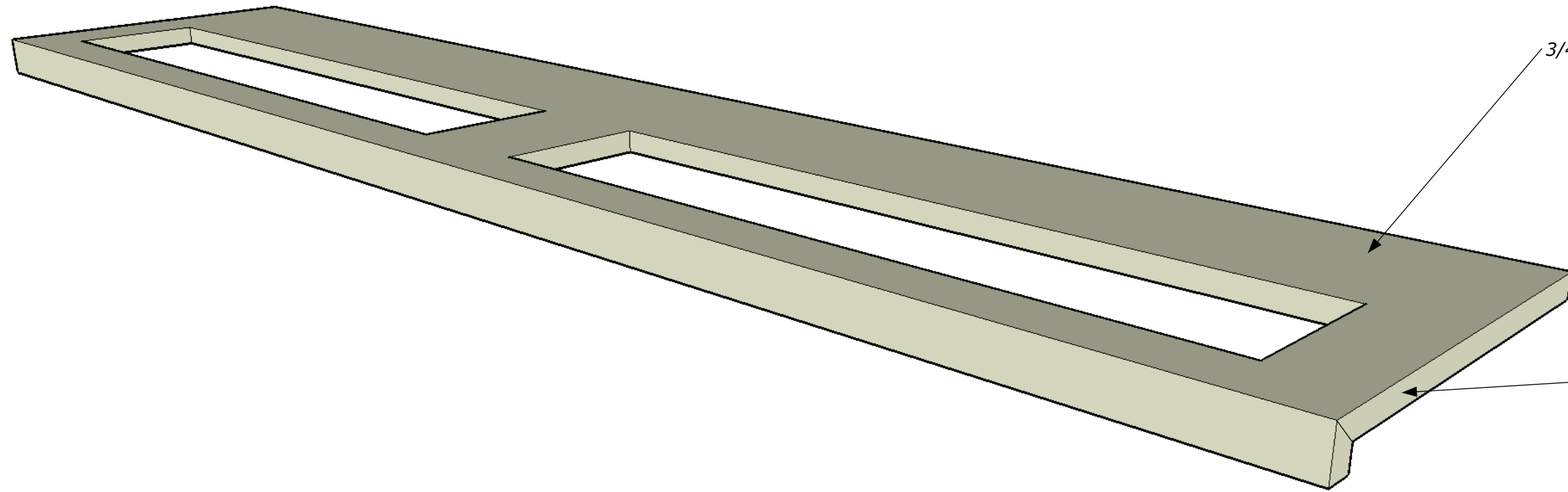

3/4" Maple veneer

Maple veneer edge

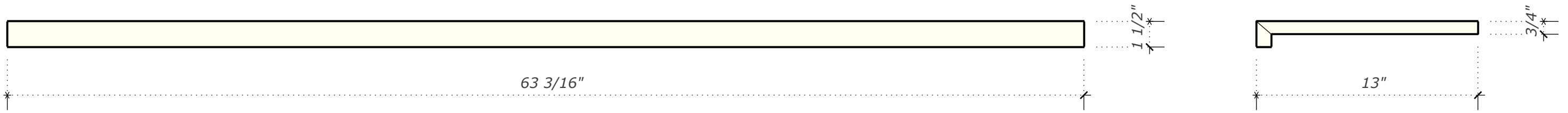

63 3/16"

1 1/2"

3/4"

13"

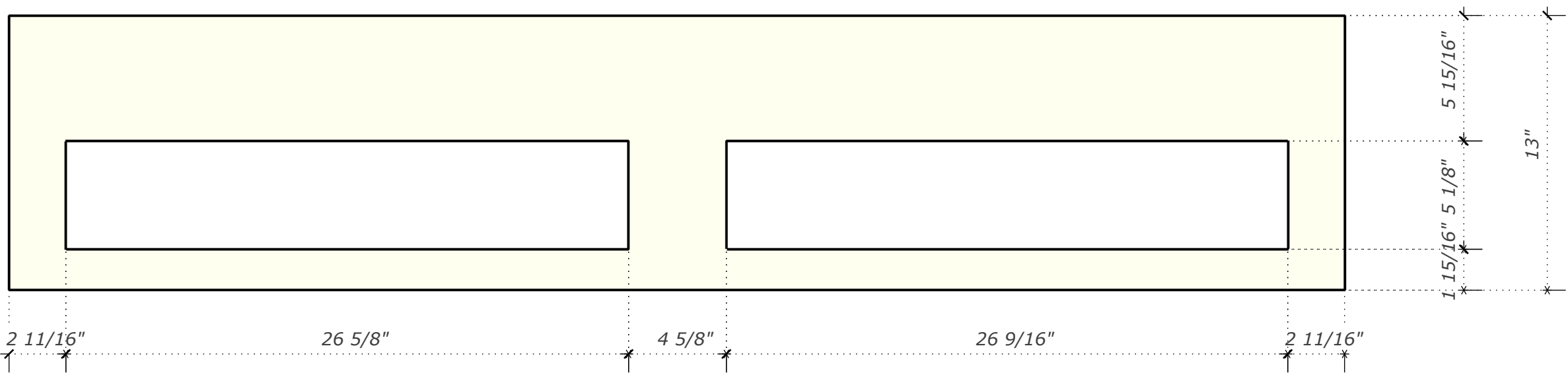

5 15/16"

13"

1 15/16" 5 1/8"

2 11/16"

26 5/8"

4 5/8"

26 9/16"

2 11/16"

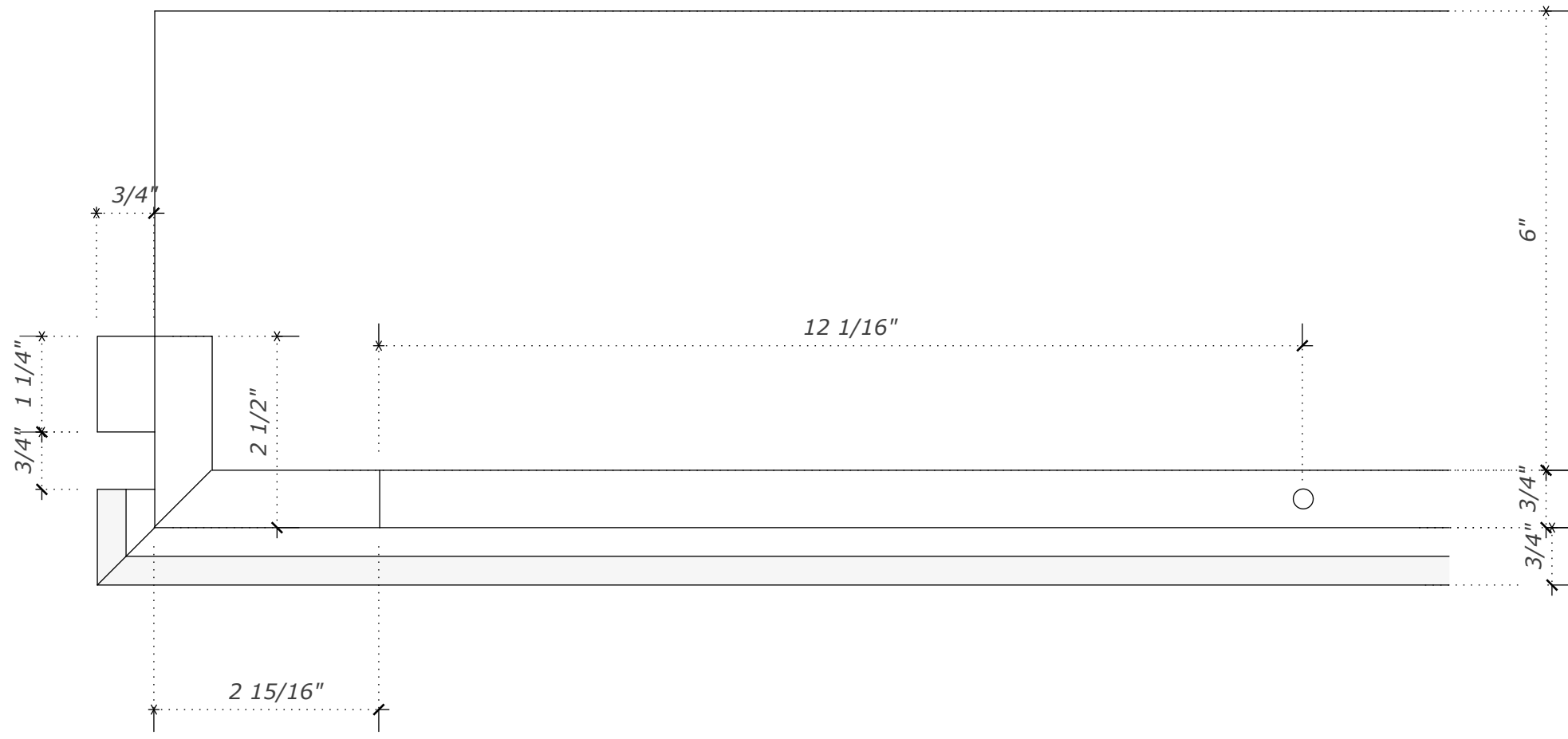

TOP Cross section

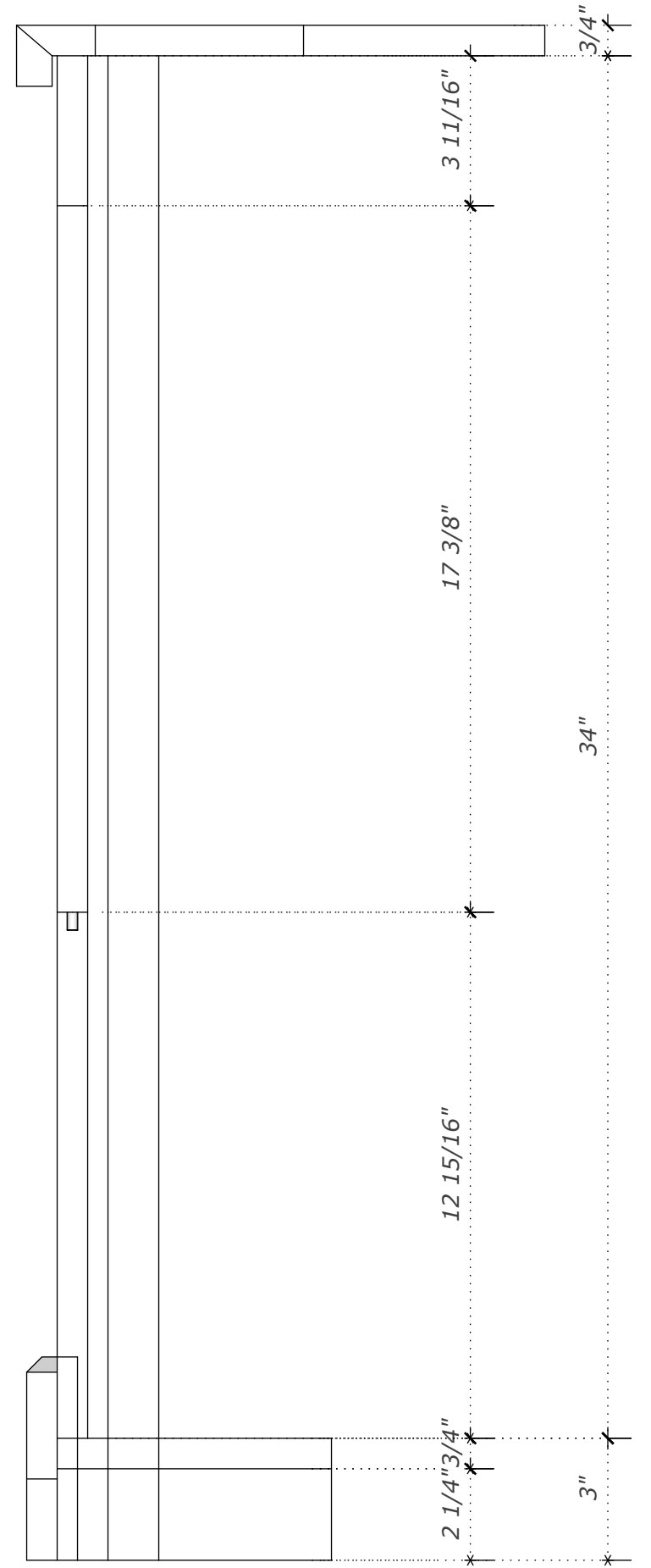

SIDE Cross section

