



**Metaroll**  
**Ready to Use**  
SERVICES



**BUILD FAST & ACCURATE**  
CUT & BEND SERVICES



**Metaroll**  
Leading Steel Manufacturers

[www.metarolls.com](http://www.metarolls.com)



**Metaroll**  
**Ready to Use**  
SERVICES



**METAROLL  
STIRRUPS**

**Safeguard  
your  
construction**



**Metaroll**  
Leading Steel Manufacturers

[www.metarolls.com](http://www.metarolls.com)



The safeguard for your construction

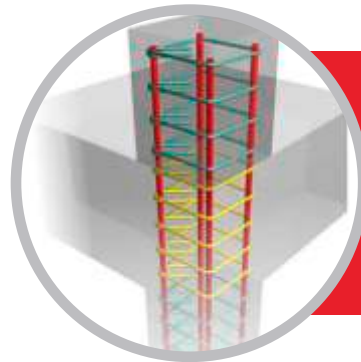
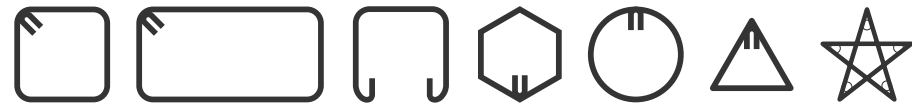

At Metaroll Ispat, we strongly desire to see Indians enjoy the same benefits that are available to citizens of the developed world. A reason why we have developed a highly advanced and globally trusted grade of steel to secure your most prized asset – your home.

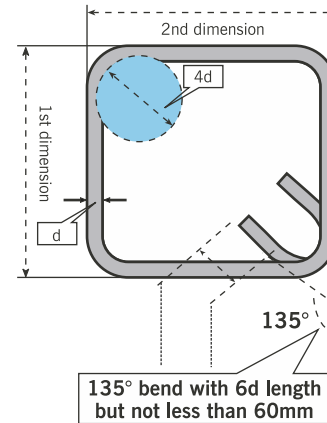

Metaroll Ispat presents the latest innovation in 6mm TMT rebars **STIRRUPS**. The most technologically advanced 6mm rebar stirrups of different size with designed anchor/bond length and designs like Square, Rectangular, Octagonal etc are used in columns and beams making. Rebar stirrups bind the vertical bars in position and in line and level in beams. They play a very vital role in confining the steel in their position during the time of pouring concrete and also does not allow the structure to rupture or develop diagonal cracks. Metaroll Ready-to-Use Stirrups is automated and is as per IS code.

**Ready-to-Use Stirrups sizes**

4 X 10"	7 X 4"	7 X 13"	9 X 12"
4 X 13"	7 X 7"	7 X 16"	9 X 15"
4 X 16"	7 X 9"	7 X 19"	9 X 18"
7 X 3"	7 X 10"	7 X 21"	9 X 21"

Stirrups rebar sizes: 6mm, 8mm, 10mm, 12mm



135° interlocking bends ensure stability under severe force experienced during earthquakes.

Zero wastage and faster construction speed.

Made from high-strength 6mm TMT rebar with automated machinery

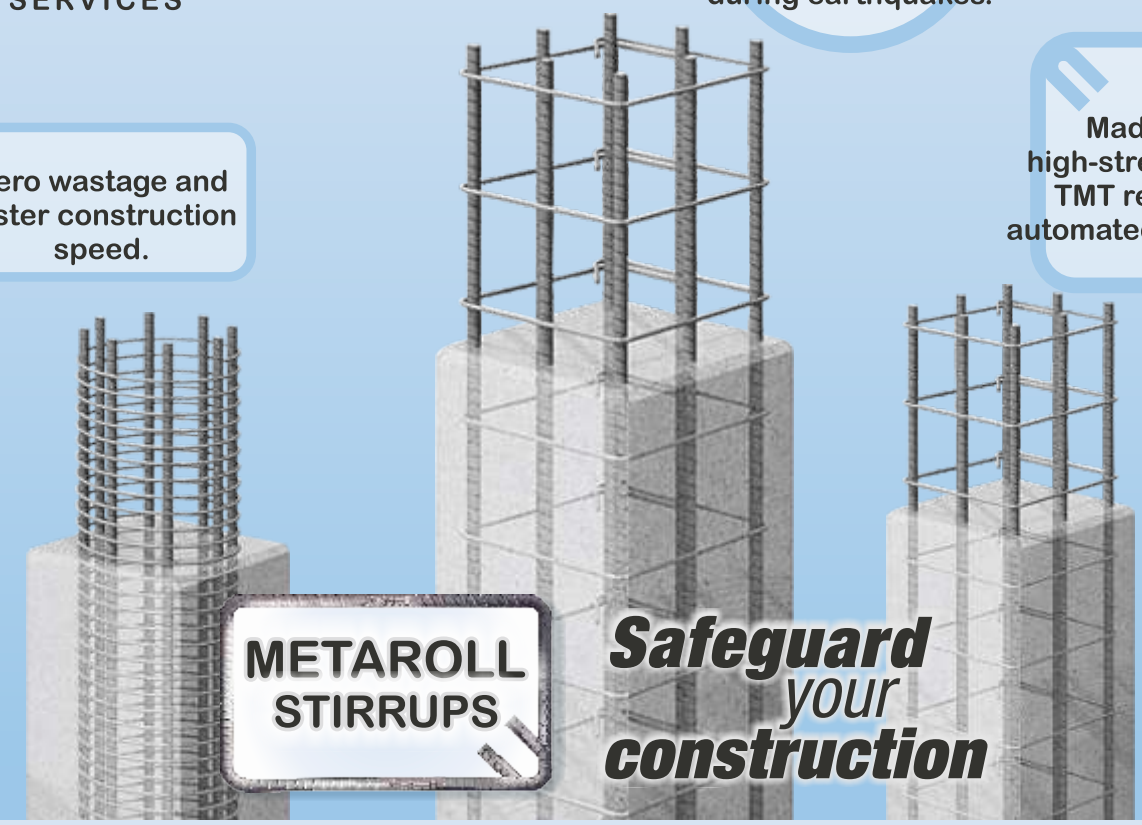

**Safeguard your construction**

Metaroll Stirrups Advantages

- 0% Wastage
- Saving of labour cost & time
- Lesser dependency on labour
- Minimum inventory & space
- Ready as per BBS
- 100% accuracy as per IS
- Less working capital
- On-time delivery

