

# THE SOMM.

HOTEL & SPA

WOODINVILLE, WASHINGTON



*9,045 Square Feet of Retail Space Available at  
Woodinville's newest Luxury Hotel, The Somm.*

# the place to *Stay & Play*

Welcome to The Somm. Hotel & Spa, a Marriott Autograph Collection, coming to Woodinville, Washington with retail space available FOR LEASE.

*Relax*

*Rejuvenate*

- 164 fully amenitized luxury hotel rooms
- 4,200 square-foot spa, a destination in itself
- 15,000 square-feet of event area for music performances, outdoor markets, and festivities of all kinds
- 3,000 square feet rooftop bar and outdoor plaza will provide incredible views of Mount Rainier and the stunning Chateau St. Michelle winery and hillside
- World Class facilities designed for 80+ destination weddings annually, average 350 - 400 guests per event



*Wine & Dine*



# the Opportunity

- 9,045 square feet of street level retail space available for lease, from 1,500 to 7,000 SF combined
- Direct connection to The Somm. Hotel lobby and event space
- Underground parking
- Seeking hair styling salons, nail spas, wine tasting rooms and retail users
- Delivery to tenants Q2 of 2025



9,045 SF of Retail Space

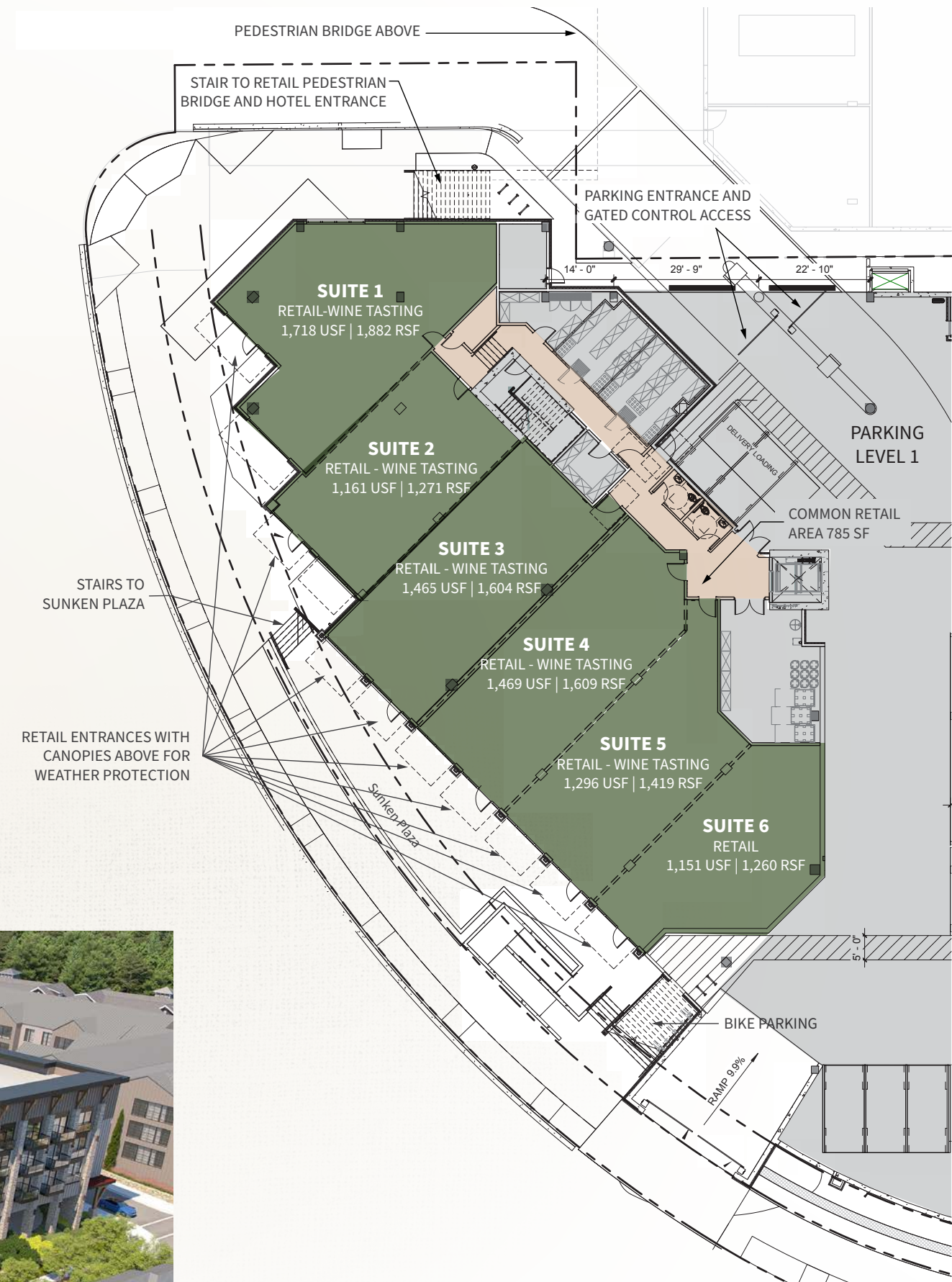

# the Location



The Somm. Hotel & Spa, a Marriott Autograph Collection will be the centerpiece of the 20+ acre Harvest- Woodinville development including:

- 200,000+ square feet of retail, restaurant and wine tasting room space
- 450+ residential units, including 250 luxury apartments, over 70 townhomes, and 130 condominium units
- 13,500 square feet co-working office space by Regus



## Demographics

	1 MILE	3 MILE	5 MILE
Residential Population (2021)	6,602	86,147	233,387
Residential Population (2026 Projected)	7,101	95,311	254,879
Daytime population (2021)	8,025	94,187	246,402
Average Household Income (2021)	\$160,495	\$154,900	\$162,195
Average Household Income (2026 Projected)	\$182,165	\$173,097	\$181,733

# the Area Amenities

## WINERY

- 1 Chateau St Michelle
- 2 Von's 1000 Spirits  
Cascade Cliffs Vineyard  
and Winery
- 3 Januik Novelty Hill
- 4 Hollywood Schoolhouse  
Maryhill Winery
- 5 DeLille Cellars & Lounge  
Sparkman Winery  
Mark Ryan Winery  
Long Shadows
- 6 Apple Farm Village

## RESTAURANT

- 7 The Hollywood Tavern
- 8 Barking Frog
- 9 The Herbfarm

## HOTEL/SPA

- 10 Willows Lodge

## RECREATION

- 11 Sammamish River Trail
- 12 Northshore Ballfields

## COFFEE

- 13 Grounds Coffee Co.

## DISTANCE (Miles)

City Hall	↖	2.5
Woodin Creek Park	↗	2.4
Target	↖	2.4
Molbak's	↗	2.2
Redmond	↘	4.5

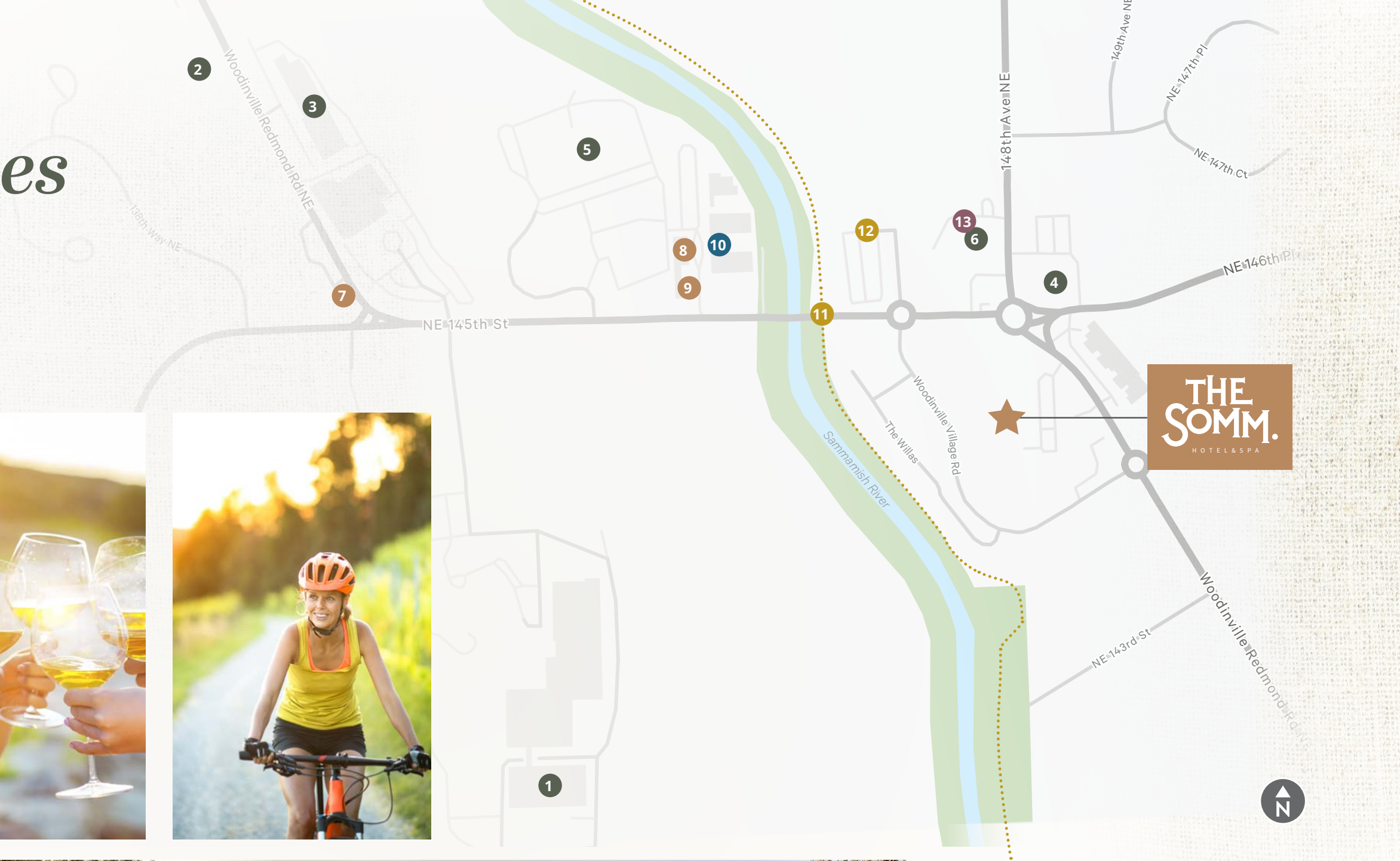

**THE SOMM.**  
HOTEL & SPA



# THE SOMM.

H O T E L & S P A

FIRST NAME LAST NAME

Vice President

T +1 206 390 1498

broker.lastname@gmail.com

---

© 2023 Dicatur, omnimolorem rerro vendae nes molecab is sedi ius, unt lam volor alit plique odia evercim et alictem volut as abo. Ipsum, cus nis mo mint ipsamus daecae nemo volene sunt quunt, venis voluptatae vitas et volorepel moluptatis accae ab iniате nonsequidis aut quae ium quo tem net molut quam ex es pratur aut reneserum fugitiorro derument. Aditincia sinctium lam, simpos et, simagnament ut es sed quatureperi vel et venis rerum hiciumquo berum, is suntiunt iur sitatecto estio tem ius aut pro doluptas deliquibus et eum se ratiasit opta voluptaesed et as et ommodit prae acerum quunto cum unt, sit omnisqui utecae parcipsam, optatem facesciaes resequati dolum duci re volesci liciendestis que num doluptaepe re num quo