

TYP AT THICKEST POINT  $\phi$  2.780  
2.750

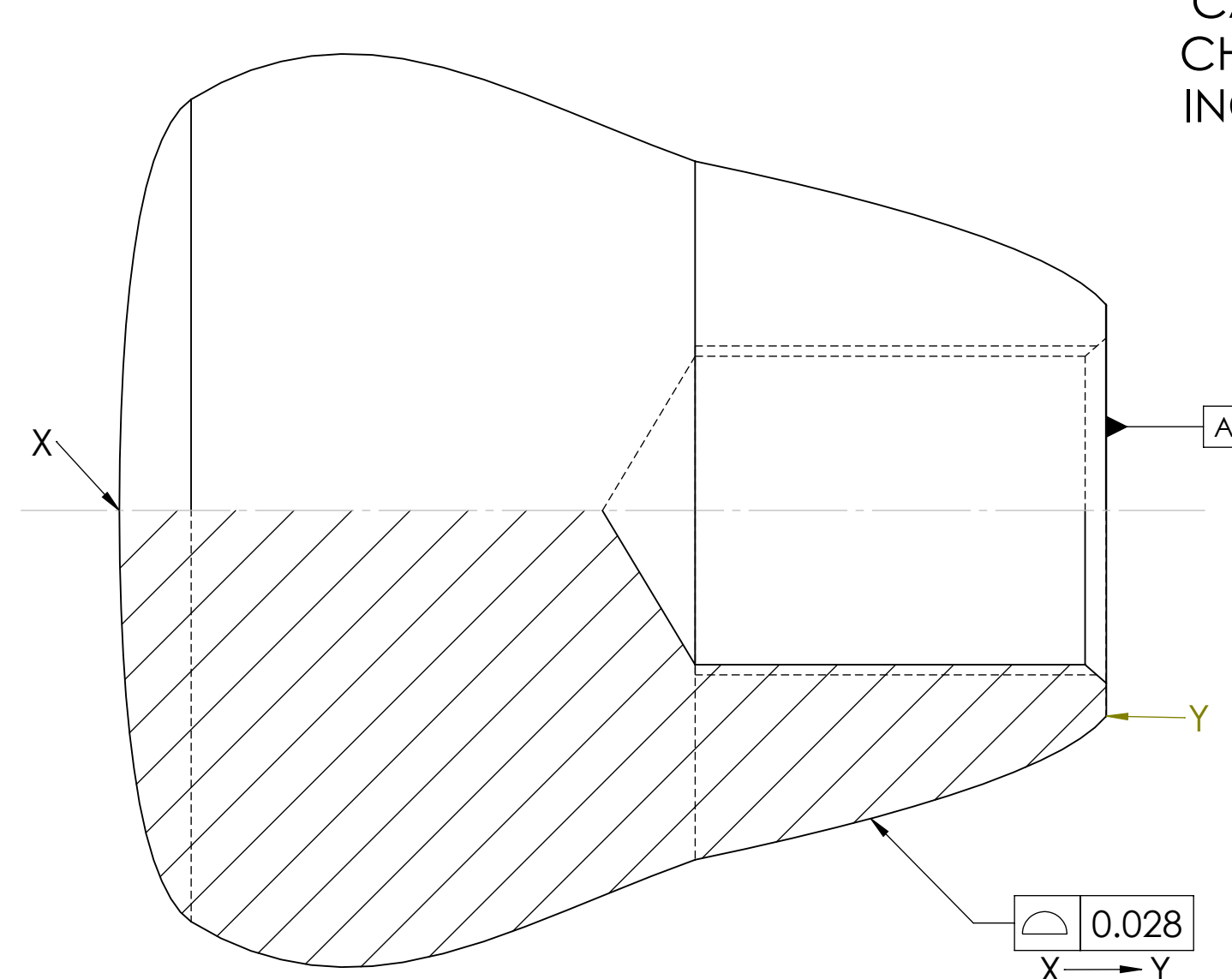
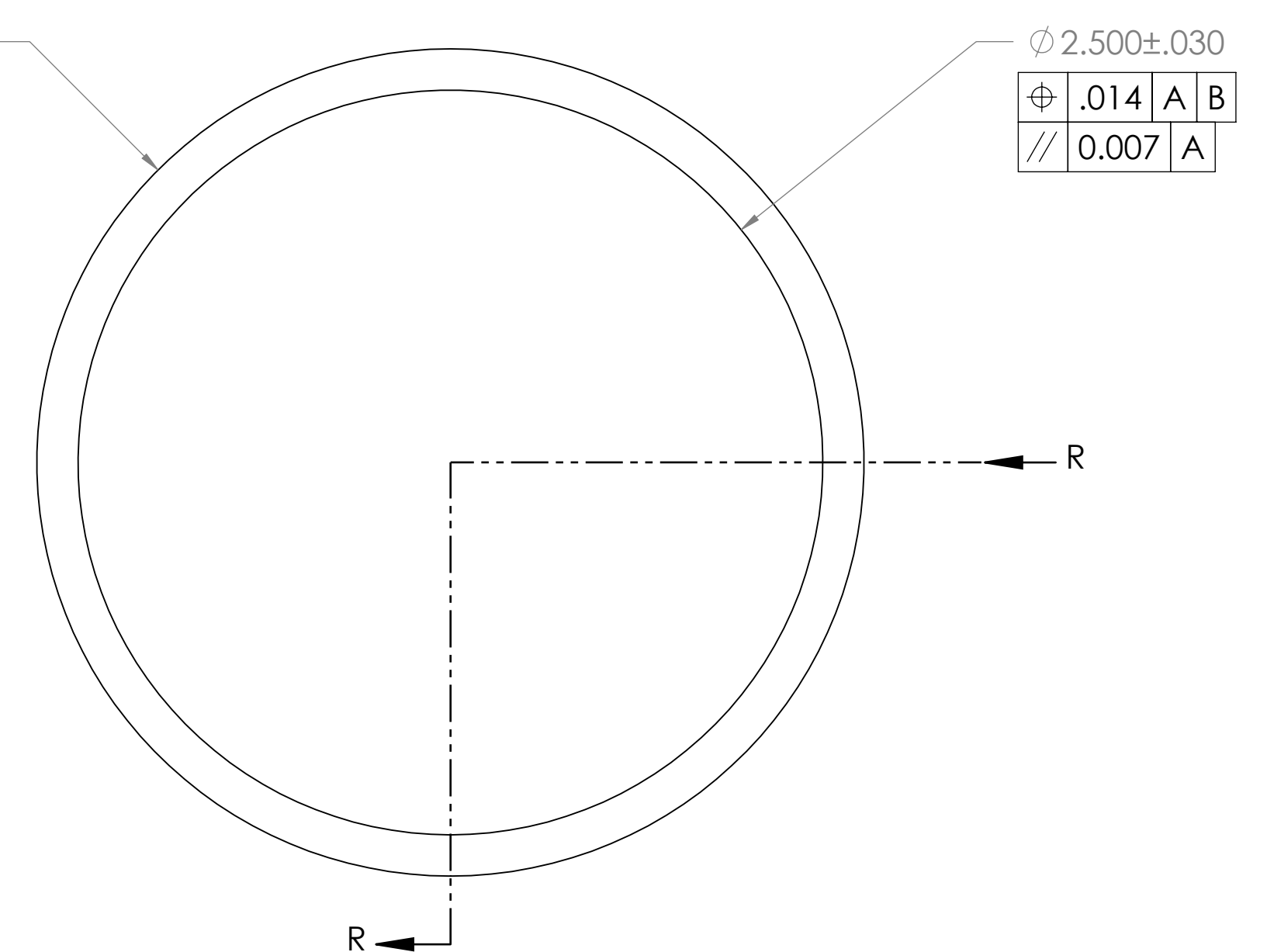

CAD MAINTAINED.  
CHANGES SHALL BE  
INCORPORATED BY  
THE DESIGN  
ACTIVITY.

REVISIONS				
ZONE	REV.	DESCRIPTION	DATE	APPROVED

- NOTES: UNLESS OTHERWISE SPECIFIED:
1. INTERPRET DRAWING IN ACCORDANCE WITH INDUSTRY STANDARDS PERSCRIBED BY ASME Y.14.5-2018 AND MILL-T-31000.
  2. MATERIAL: SAE 1060 ALLOY.
  3. ALL FILLETS AND ROUNDS R.100.
  4. REMOVE ALL BURRS AND SHARP EDGES.
  5. DO NOT SCALE DRAWING.

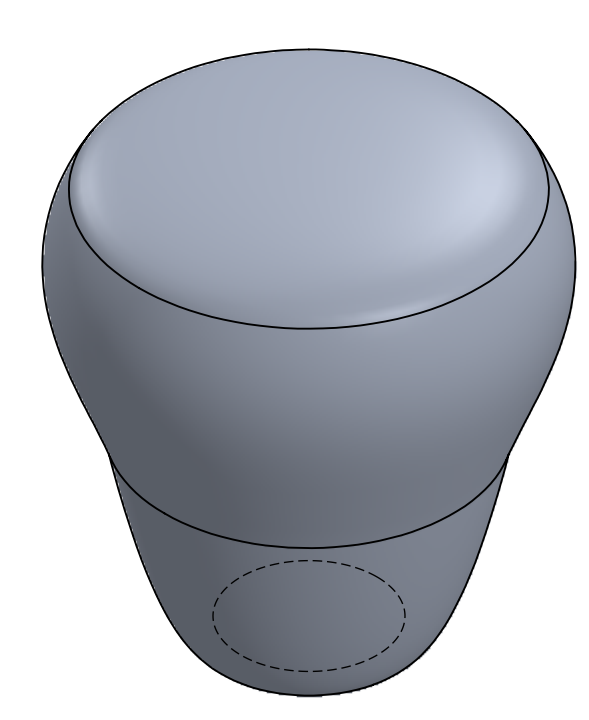
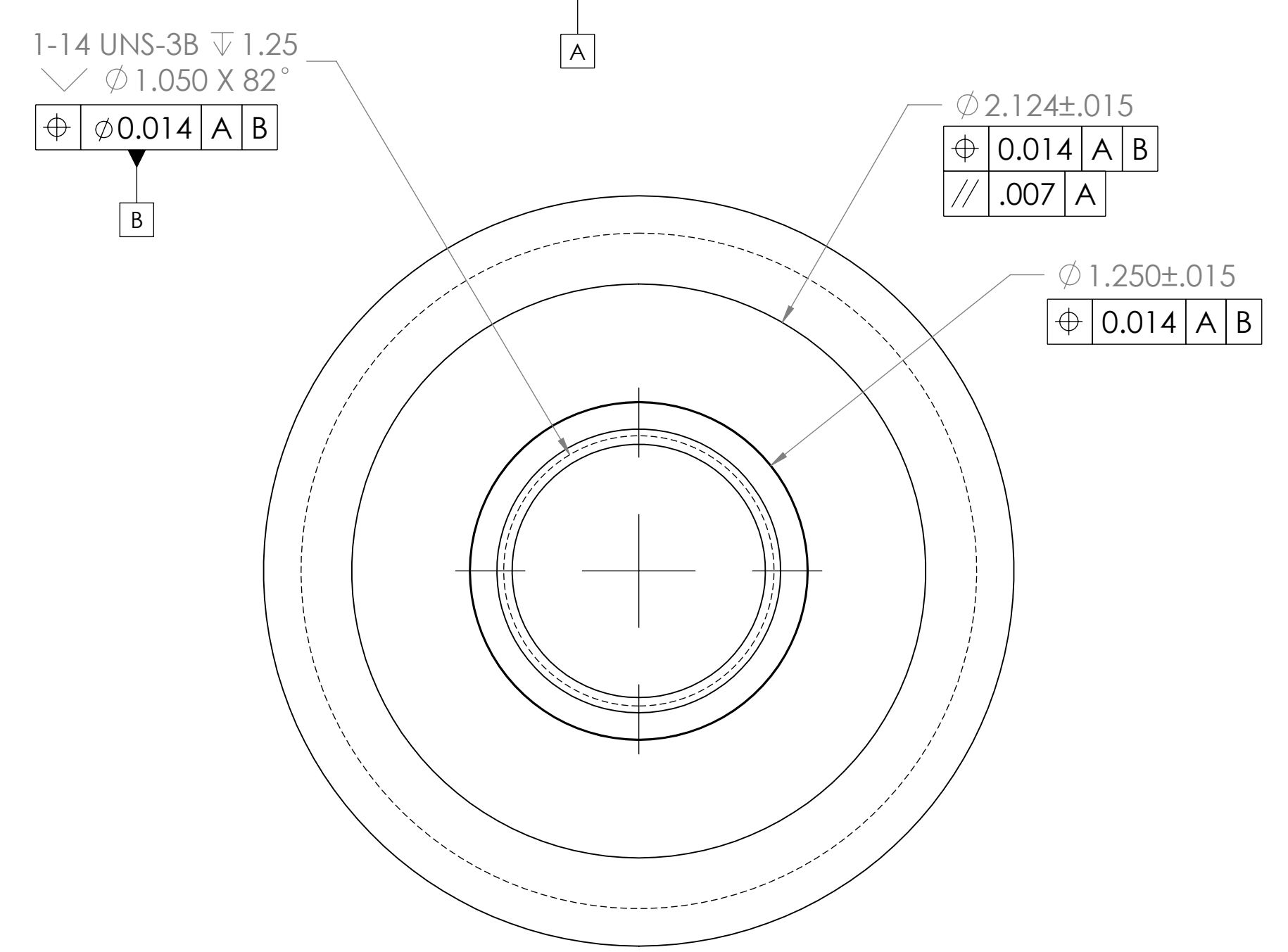
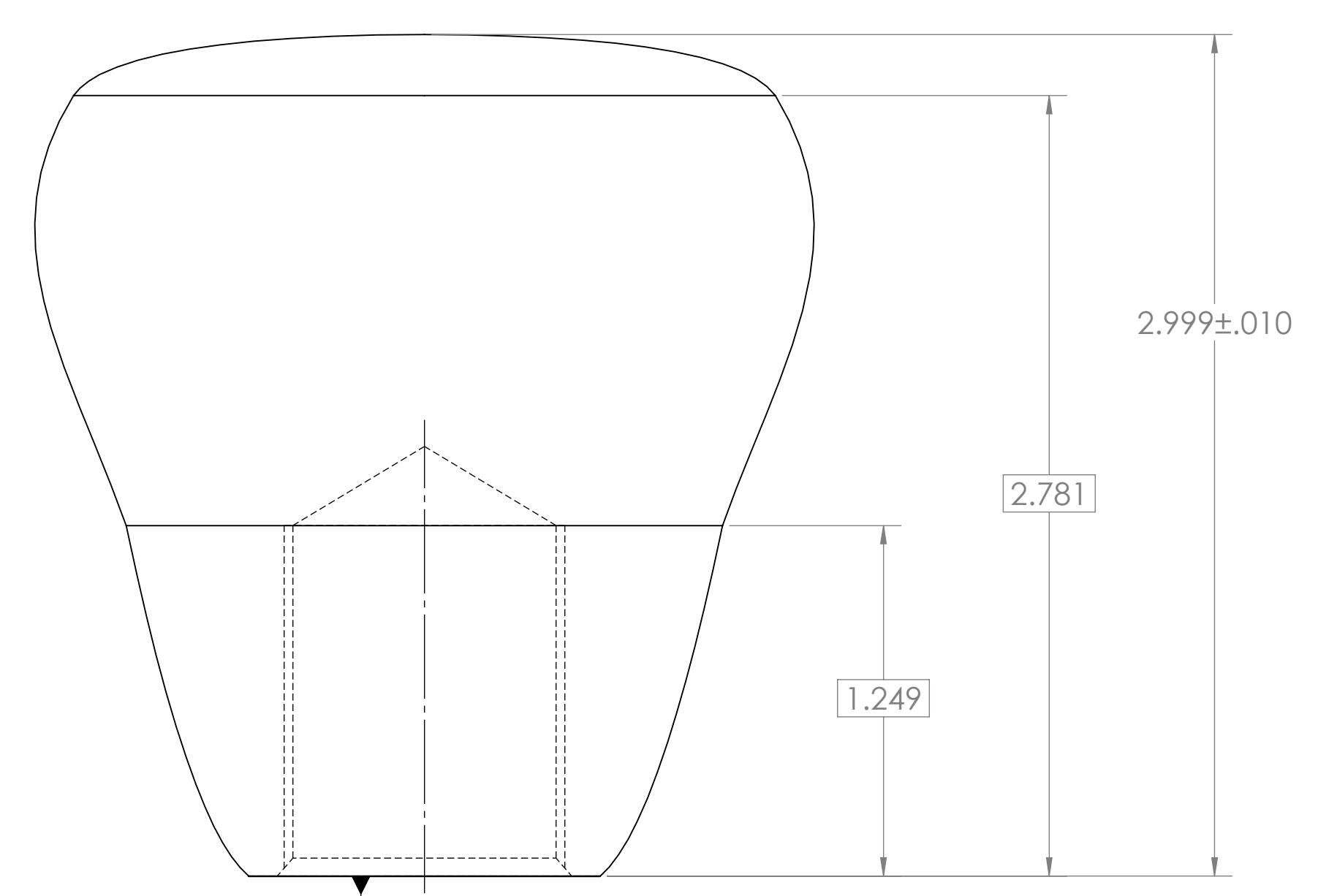

PROPRIETARY AND CONFIDENTIAL  
THE INFORMATION CONTAINED IN THIS  
DRAWING IS THE SOLE PROPERTY OF  
ANGEL A. VILLALBA S.A. ANY  
REPRODUCTION IN PART OR AS A WHOLE  
WITHOUT THE WRITTEN PERMISSION OF  
ANGEL A. VILLALBA S.A.  
IS PROHIBITED.

UNLESS OTHERWISE SPECIFIED:		NAME	DATE
DIMENSIONS ARE IN INCHES	DRAWN	MAVF	10/06/23
FRACTIONAL ±	CHECKED		
ANGULAR: MAJOR ± BEND ±	ENG APPR.		
TWO PLACE DECIMAL ±	MFG APPR.		
THREE PLACE DECIMAL ±	Q.A.		
INTERPRET GEOMETRIC TOLERANCING PER: ASME Y.14.5-2018	COMMENTS:		
MATERIAL: SAE 1060 ALLOY			
FINISH:			
APPLICATION	DO NOT SCALE DRAWING		

SIZE	DWG. NO.	REV
D	PART - 1	-

TITLE: ASSEMBLED PART 1  
DRAWING  
SCALE: 2:1 | WEIGHT: 1.07LBS | SHEET 1 OF 1